



Burnley Road, London, NW10  
£1,550 pcm

## Burnley Road, London, NW10

**\*\*Gas and water included\*\*** A furnished one-bedroom ground-floor apartment located on Burnley Road in the popular Dollis Hill area (NW10). The property features a generously sized open-plan reception area, a well-proportioned bedroom, and direct access to a private patio, providing useful outdoor space. Conveniently positioned on the ground floor, the apartment offers comfortable living in a well-connected residential location, close to local amenities and transport links.







# Burnley Road, NW10 1ED

Approx Gross Internal Area = 34.54 sq m / 372 sq ft

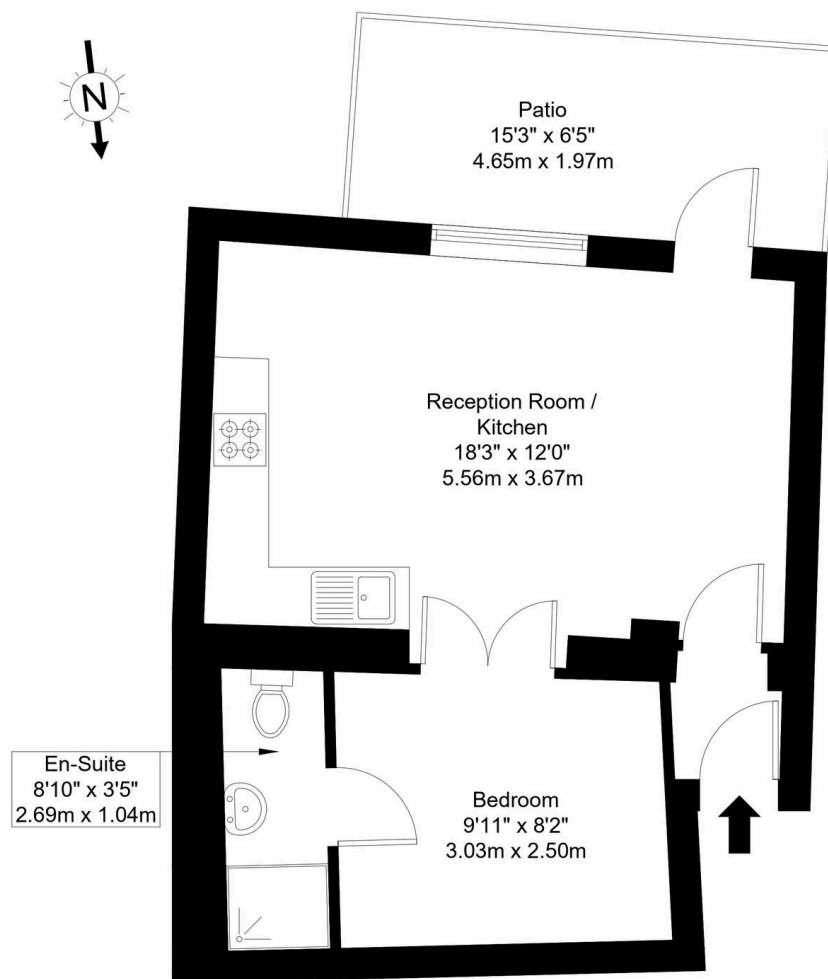

Ground Floor

Ref :

Copyright **BLEU PLAN**

The Floor plan is not to scale and measurements and areas shown are approximate and therefore should be used for illustrative purposes only. The plan has been prepared in accordance with the RICS code of Measuring Practice and whilst we have confidence in the information produced it must not be relied on. Maximum lengths and widths are represented on the floor plan. If there is any aspect of particular importance, you should carry out or commission your own inspection of the property.  
Copyright @ BleuPlan





## Black Katz

22 West Hampstead Mews, London - NW6 3BB

02073285000 • [Thomas@blackkatz.com](mailto:Thomas@blackkatz.com) • [blackkatz.com/](http://blackkatz.com/)