



2 Goldsborough Close, Eastleaze – SN5 7EP
West Swindon

Guide Price **£276,995**

mcfarlane
property.com

2 Goldsbrough Close

Eastleaze, Swindon

A delightful Three bedroom semi detached home in a sought after West Swindon setting. Situated in a smaller Cul-De-Sac in Eastleaze with ease of access to the West Swindon district centre + amenities plus an abundance of transport links.

This lovely home has been lovingly updated to create a bright and airy home. The accommodation presents well with a summary of accommodation comprising Entrance Hallway, Living Room, Fitted Kitchen Leading to Dining Area + Conservatory. The First Floor boasts Three Generous Bedrooms and a Family Bathroom.

Externally there is an Enclosed Rear Garden that has been landscaped to include a patio entertaining space, the rest is mostly laid to lawn with side pedestrian gated access.

There is also a generous Gravelled Driveway with off road parking for multiple cars. There is also a Single Garage set back and to the side.

There is uPVC Double Glazing and Gas Fired Heating Throughout.

NO ONWARD CHAIN + VIEWINGS BY APPOINTMENT ONLY

Sole Selling Agents



2 Goldsbrough Close

Eastleaze, Swindon

- Sought After Cul De Sac Position
- Updated Family Home
- Three Bedroom Semi Detached
- Driveway - Off Road Parking + SINGLE GARAGE
- Enclosed Rear Gardens
- Conservatory
- NO CHAIN

Council Tax band: C

Tenure: Freehold

EPC Energy Efficiency Rating: C

EPC Environmental Impact Rating: C



mcfarlane
property.com

Ground Floor

Approx. 53.6 sq. metres (577.2 sq. feet)

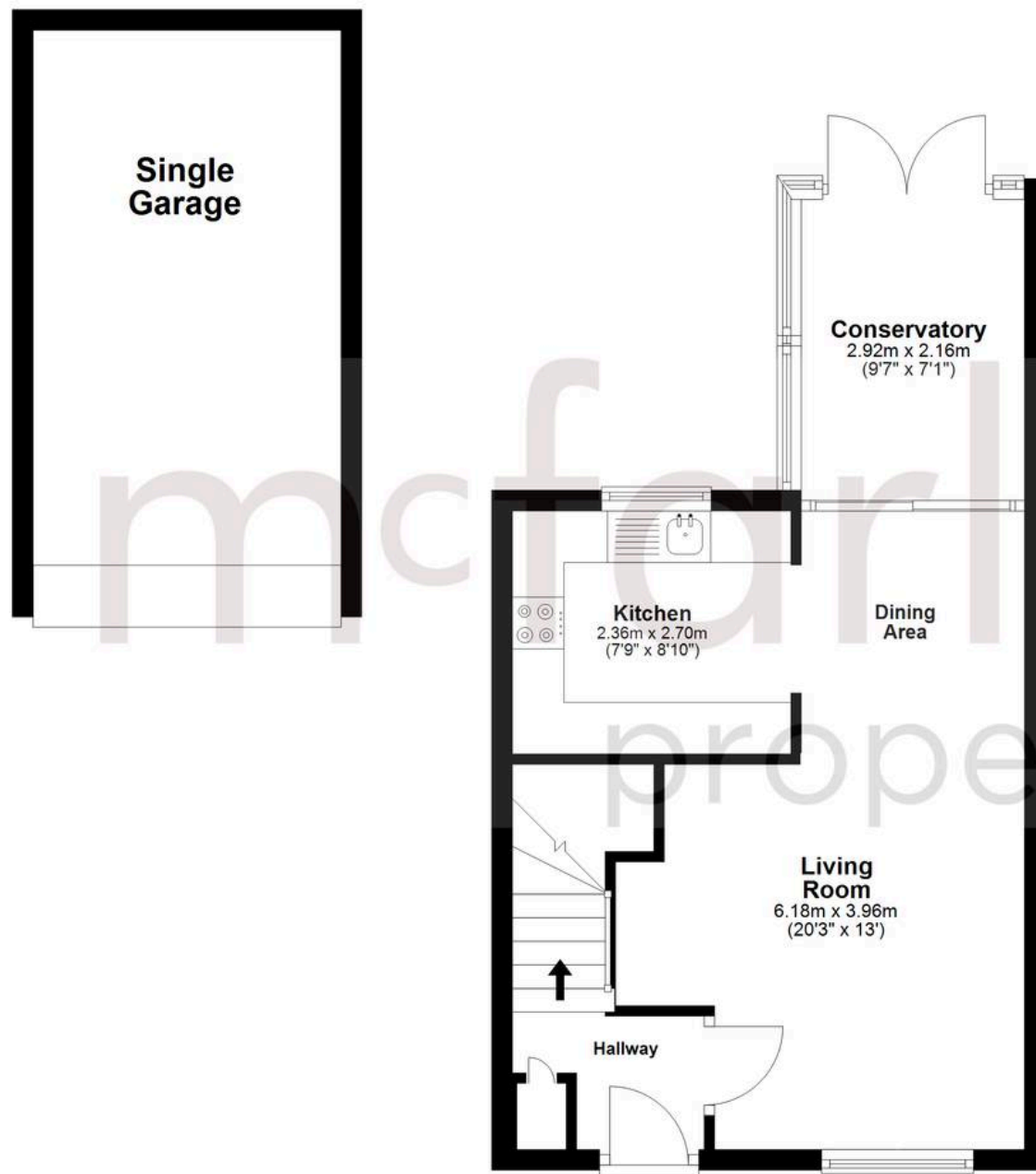

First Floor

Approx. 26.3 sq. metres (282.6 sq. feet)



Agents Note: Whilst every care has been taken to prepare these sales particulars, they are for guidance purposes only. All measurements are approximate are for general guidance purposes only and whilst every care has been taken to ensure their accuracy, they should not be relied upon and potential buyers are advised to recheck the measurements.

Total area: approx. 79.9 sq. metres (859.8 sq. feet)