



## 9 Carters Cottages, St Johns.

Redhill

Guide Price **£430,000**



Nestled in the heart of the highly sought-after St John's area, this enchanting two bedroom Georgian terraced cottage offers an exceptional blend of historic character and contemporary living. Dating back to 1815, the property forms part of the picturesque Carters Cottages (formerly known as Little London before being renamed St John's after the construction of the local church), making it a rare opportunity to own a piece of the area's rich heritage.

The cottage enjoys a prominent position within the conservation area, fronting onto the well-regarded St John's Primary School, and benefits from ample parking for residents and guests. Upon entering, you are greeted by a welcoming living space that effortlessly combines period details with modern touches, setting the tone for the rest of the home. The modern kitchen diner is thoughtfully designed, offering ample storage and worktop space, making it ideal for both every-day living and entertaining. A well-appointed ground floor bathroom adds to the convenience and functionality of the layout. Upstairs, two double bedrooms provide peaceful retreats, each featuring fitted wardrobes for plentiful storage.

The master bedroom enjoys scenic views of the front garden and the historic school, while the second bedroom overlooks the expansive rear garden, offering a tranquil outlook and a sense of privacy. The cottage is perfectly positioned for those seeking a quiet lifestyle, yet remains within easy reach of local amenities, reputable schools, and excellent transport links. Whether you are looking for a charming first home, a downsizing opportunity, or a characterful investment, this delightful property captures the essence of village living within a thriving community. The historic setting, coupled with the modern comforts and thoughtful layout, ensures this home stands out as a truly special offering in the St John's area. Early viewing is highly recommended to fully appreciate the unique charm, spacious interiors, and convenient location that this beautiful cottage provides.

Council Tax band: C

Tenure: Freehold

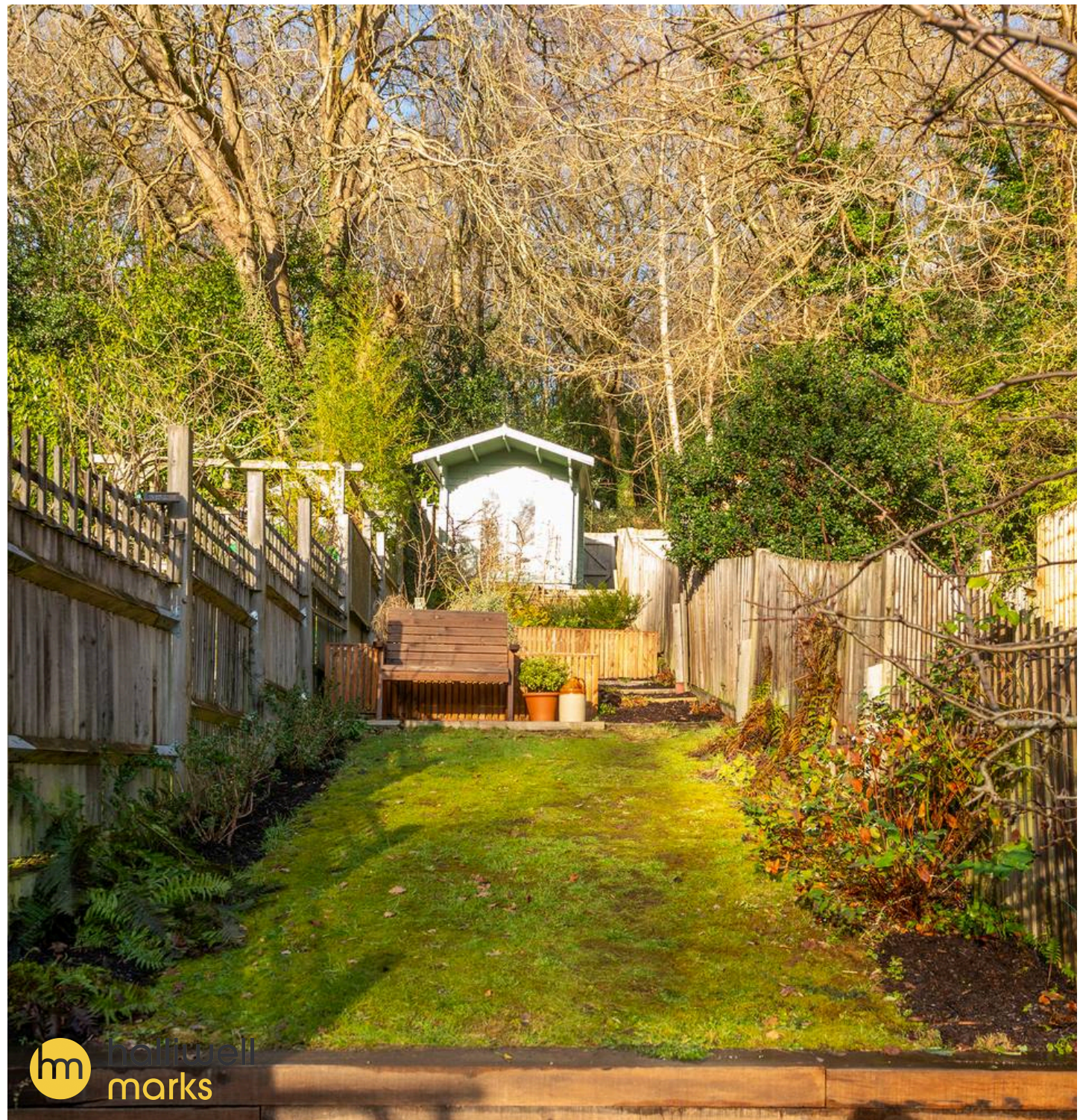



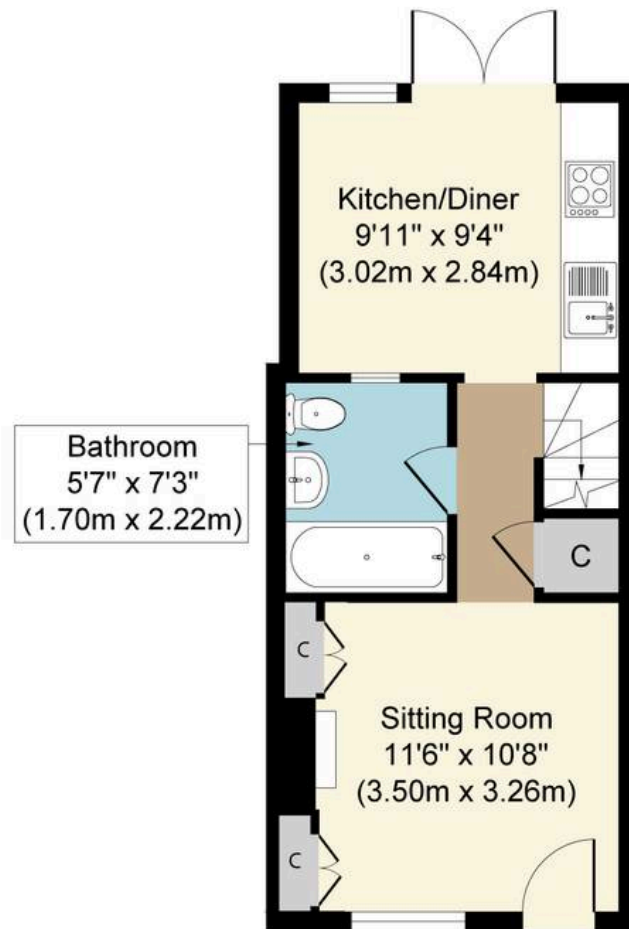

**Ground Floor**  
**Approximate Floor Area**  
**317 sq. ft**  
**(29.41 sq. m)**

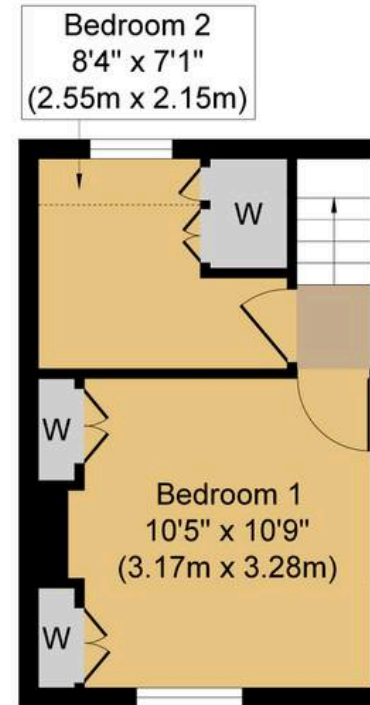

**First Floor**  
**Approximate Floor Area**  
**210 sq. ft**  
**(19.49 sq. m)**

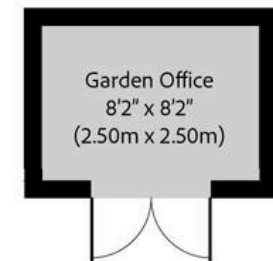

**Carters Cottages, RH1**  
**Approx. Gross Internal Floor Area 527 sq. ft / 48.90 sq. m**

Whilst every attempt has been made to ensure the accuracy of the floor plan contained here, measurements of doors, windows, rooms and any other items are approximate and no responsibility is taken for any error, omission, or mis-statement. The measurements should not be relied upon for valuation, transaction and/or funding purposes. This plan is for illustrative purposes only and should be used as such by any prospective purchaser or tenant. The services, systems and appliances shown have not been tested and no guarantee as to their operability or efficiency can be given.