

£1700.00

Per Calendar Month

CORBETT CHASE
GEDLING

- FOUR BEDROOMS
- DETACHED
- GOOD LOCATION
- DOWNSTAIRS WC
- TWO RECEPTION ROOMS
- EPC B



Good Size Modern Detached House in Gedling

THIS WELL-PRESENTED, MODERN DETACHED FAMILY HOME IS ARRANGED OVER TWO FLOORS AND OFFERS STYLISH, COMFORTABLE LIVING WITH CONTEMPORARY FIXTURES THROUGHOUT.

THE ACCOMMODATION BEGINS WITH A WELCOMING ENTRANCE HALLWAY FEATURING A DOWNSTAIRS WC. TO THE FRONT OF THE PROPERTY IS A VERSATILE RECEPTION ROOM, CURRENTLY USED AS A PLAYROOM, BENEFITING FROM USEFUL UNDER-STAIR STORAGE.

TO THE REAR, THE SPACIOUS LIVING ROOM ENJOYS FRENCH DOORS OPENING ONTO THE GARDEN, BESPOKE BUILT-IN CABINETRY AND A MODERN ELECTRIC FEATURE FIREPLACE. THE KITCHEN DINER IS FITTED WITH A RANGE UNITS AND INTEGRATED APPLIANCES INCLUDING A DISHWASHER, WASHING MACHINE, FRIDGE FREEZER, OVEN, INDUCTION HOB AND EXTRACTOR, WITH ADDITIONAL ACCESS VIA A SIDE DOOR.

UPSTAIRS, THERE ARE FOUR WELL-PROPORTIONED BEDROOMS, WITH THE PRINCIPAL BEDROOM BENEFITING FROM AN EN-SUITE SHOWER ROOM. THE FAMILY BATHROOM IS FITTED WITH A BATH AND MAINS-FED SHOWER OVER.

EXTERNALLY, THE REAR GARDEN IS ATTRACTIVELY LANDSCAPED WITH A LAWN AND PAVED PATIO AREA, IDEAL FOR OUTDOOR DINING. TO THE FRONT, THERE IS OFF-ROAD PARKING AND A GARAGE WITH POWER, LIGHTING AND AN UP-AND-OVER DOOR.

SITUATED IN THE POPULAR RESIDENTIAL AREA OF GEDLING, THE PROPERTY IS CONVENIENTLY LOCATED CLOSE TO SCHOOLS, SHOPS, TRANSPORT LINKS, AND THE COUNTRY PARK.

VIEWINGS ARE HIGHLY RECOMMENDED.

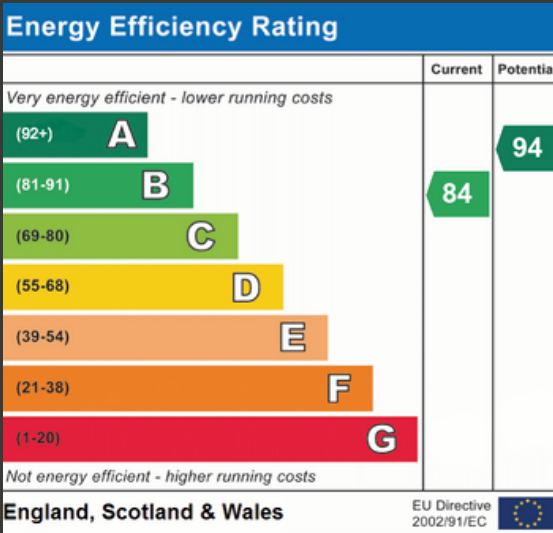

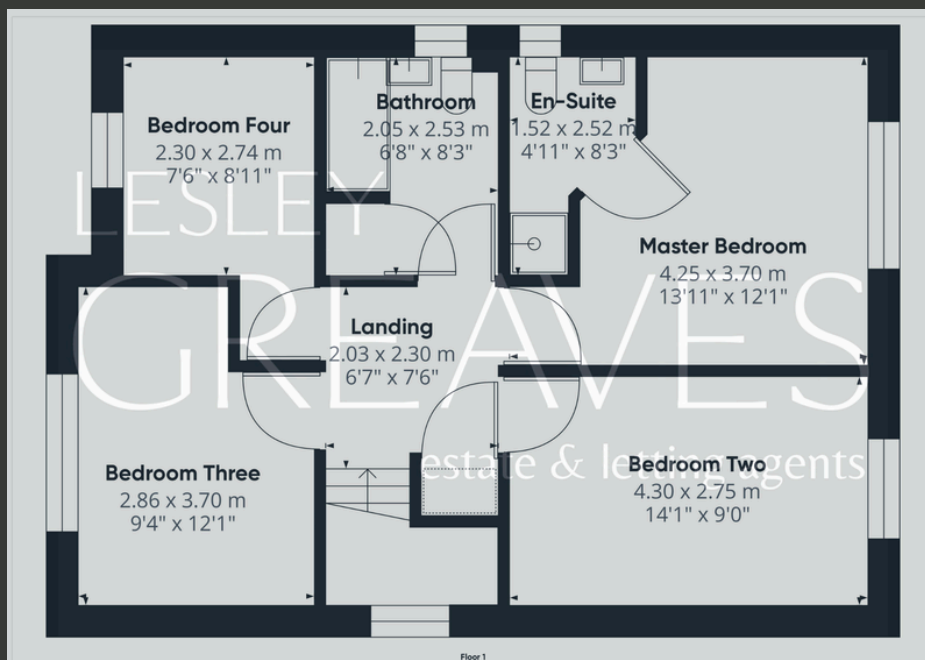
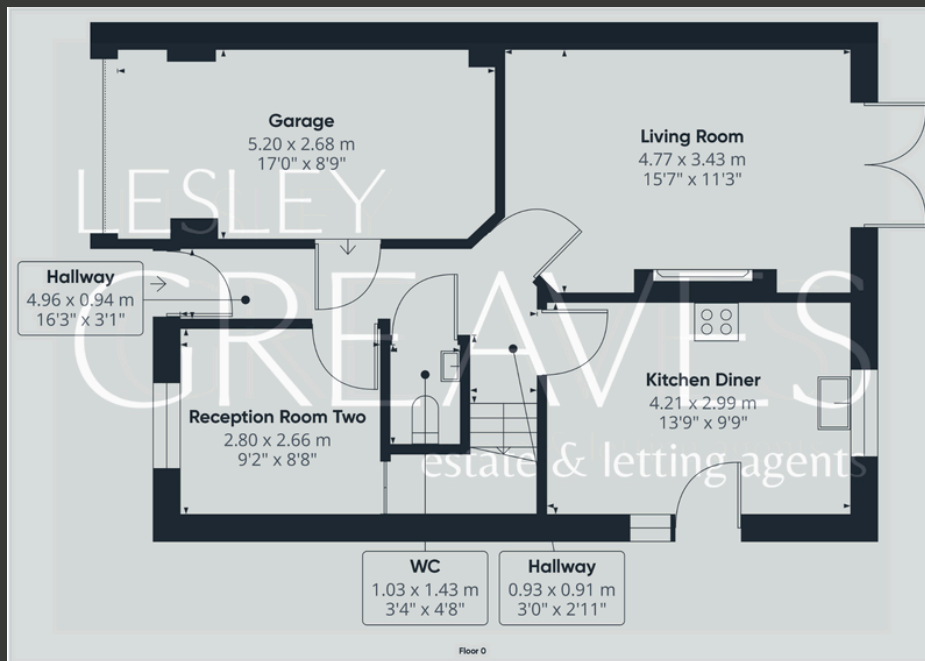

- FREEHOLD
- COUNCIL TAX; BAND E
- LOCAL AUTHORITY; GEDLING BOROUGH COUNCIL
- INITIAL 6 MONTHS FIXED TERM THEN A MONTHLY ROLLING CONTRACT
- SHORTHOLD TENANCY DEPOSIT £1961.53

SECURITY DEPOSIT SET AT A MAXIMUM OF FIVE WEEKS RENT, THIS COVERS DAMAGES OR DEFAULTS ON THE PART OF THE TENANT DURING THE TENANCY. AS AN AGENCY WE ARE NOT CHARGING TENANTS A HOLDING DEPOSIT.

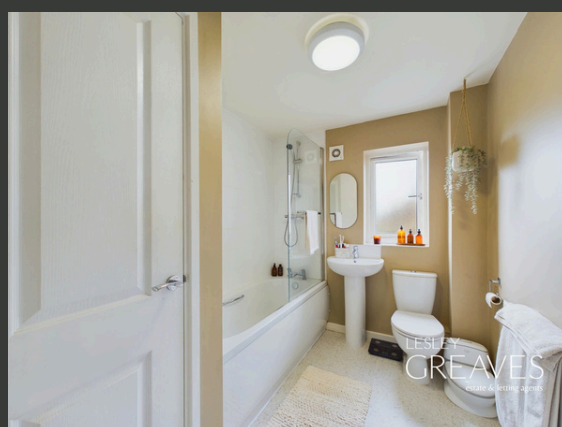

Lesley Greaves Estate & Lettings Agents

22 Main Road ,Gedling, Nottingham, NG4 3HP

0115 9877337 lettings@lesleygreaves.co.uk