



**5 Sunnydale, Bittaford,  
Ivybridge, PL21 0EE**

**Asking Price Of £169,950**



MILLINGTON TUNNICLIFF

# 5 Sunnydale, Bittaford, Ivybridge, PL21 0EE



2



1



2



A



EPC

C 70



689.8  
SQFT

## FLOORPLAN

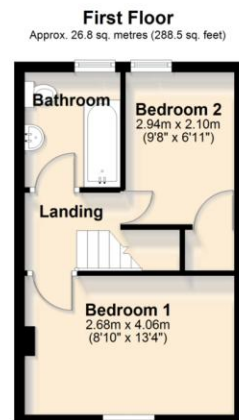
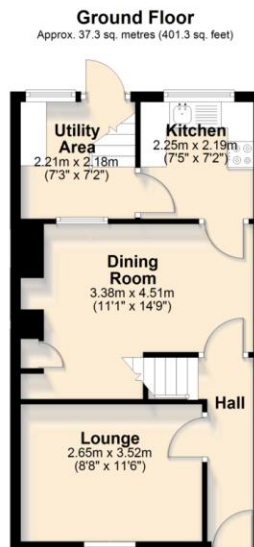

## Asking Price Of £169,950

### SUMMARY

A spacious two-bedroom character cottage enjoying elevated rear views and a generous garden. The property offers excellent potential and would benefit from internal modernisation, making it an ideal first home for buyers seeking a period property in a desirable village location. The accommodation comprises a lounge with feature fireplace, a separate dining room, a kitchen with adjoining utility room, two well-proportioned bedrooms, and a family bathroom. On-street parking is available to the front of the property, while to the rear is a terraced garden providing pleasant outdoor space. The property is offered with no onward chain. EPC C 70

### CONTACT

**19 Fore Street, Ivybridge,  
Devon, PL21 9AB**

### EMAIL

**[info@millingtontunnicliff.co.uk](mailto:info@millingtontunnicliff.co.uk)**

### TEL

**01752 896020**

**[www.millingtontunnicliff.co.uk](http://www.millingtontunnicliff.co.uk)**

Two Bedroom Cottage | Village Location | Lounge With  
Feature Fireplace | Separate Dining Room | Kitchen &  
Adjoining Utility Room | Terraced Rear Garden | Elevated  
Views To The Rear | Perfect First Time Buyer |  
Modernisation Required | On Road Parking