



12 Elmwood Park, Gerrards Cross

Guide Price £2,250,000

Ashington Page

A unique detached residence of approx 5,440 sq ft, including garage, outbuildings and an enclosed swimming pool complex. Located within a private development in Gerrards Cross. The property has a landscaped, set-back driveway and is fully modernised, extended, and remodelled to create a contemporary family home. Ideally positioned within school catchments and a 20–25 minute walk from Gerrards Cross station for access to London. Planning permission has been granted to demolish the existing garage and rebuild with an upper floor and footprint.

Council Tax Band: A
EPC Rating: B
Tenure: Freehold

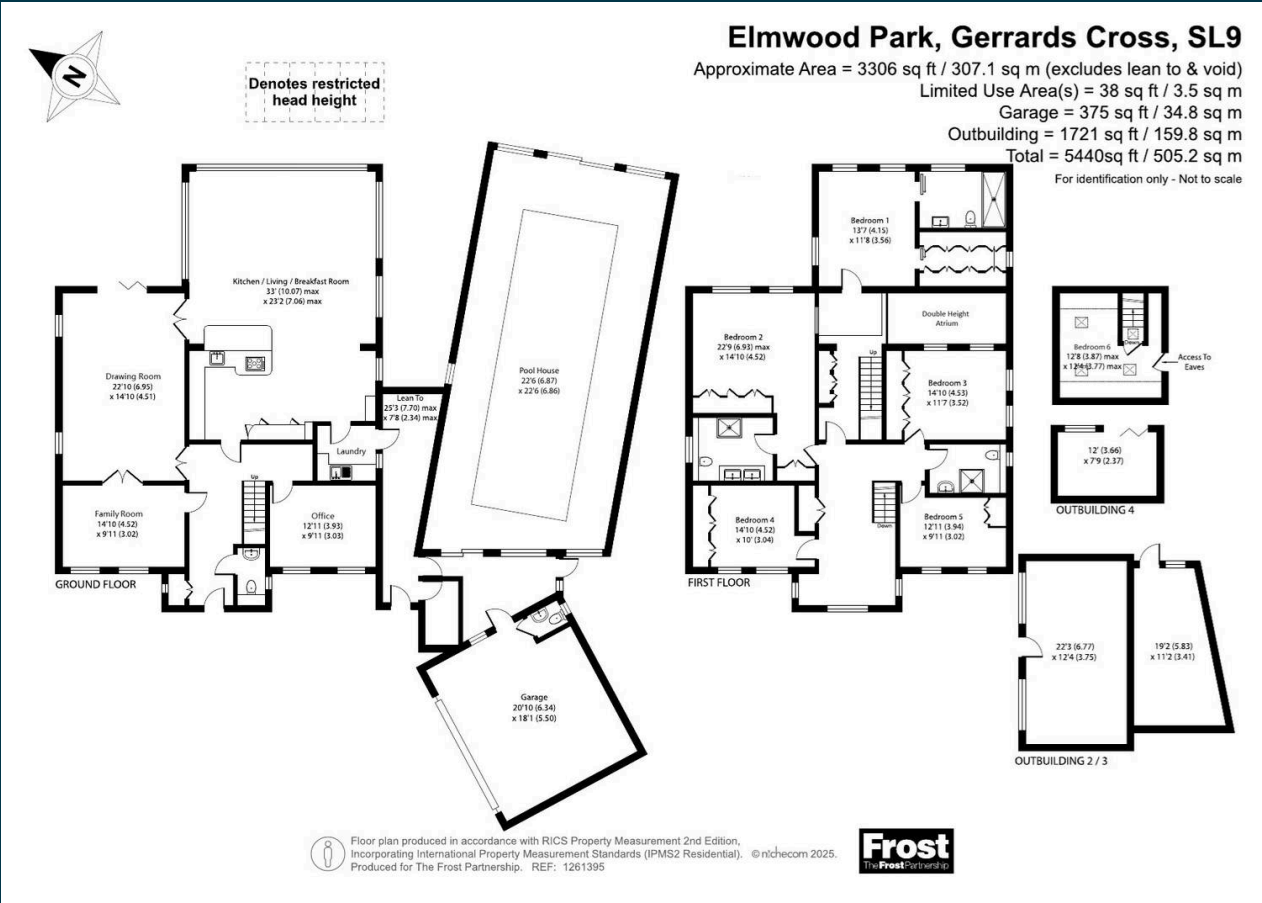

These particulars are for guidance only. They are prepared and issued in good faith and are intended to give a fair summary of the property. Any description should not be relied on as a statement or representation of fact or that the property, or its services, are in good condition. The photographs show only certain parts of the property at the time they were taken. Any areas, measurements or distance given are approximate only. Any reference to alterations to, or use of, any part of the property is not a statement that any necessary planning, building regulations or other consent has been obtained. These matters must be verified by an intending purchaser. All statements contained in these particulars in relation to the property are made without responsibility of Ashington Page or its clients. Neither Ashington Page (nor any joint agents) nor any of their employees has any authority to make or give any representation or warranty whatsoever in relation to the property



01494 680018
info@ashingtonpage.co.uk
www.AshingtonPage.co.uk

