

35 Crouch Street, Basildon – SS15 4BA

£210,000 Leasehold

Located within Noak Bridge village is this beautifully presented one-bedroom flat with open plan living, modern decor with contemporary fireplace and sleek kitchen incorporating integrated appliances. Spacious bedroom with built-in wardrobe storage and a contemporary bathroom.

Council Tax band: A ~ EPC Energy Efficiency Rating: C



tyler estates

01277 626181

www.tylerestates.co.uk



Lounge
11' 9" x 16' 7" (3.58m x 5.05m)

Kitchen

Bedroom
8' 6" x 12' 11" (2.60m x 3.94m)

Hallway

Store

Bathroom

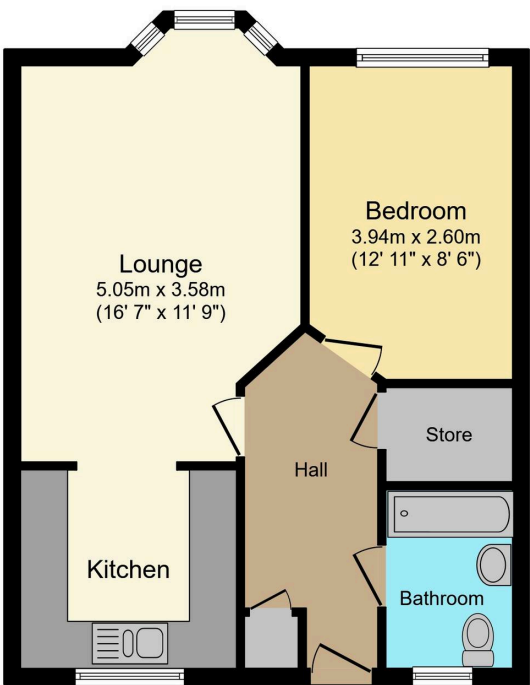

Floor Plan

This plan is for illustration purposes only and may not be representative of the property. Plan not to scale. Powered by audioagent.com