



Warwick Drive  
Atherstone  
£379,950

\*\*\* LARGE DETACHED FAMILY HOME - POPULAR DEVELOPMENT \*\*\*. We are delighted to bring to market this perfect family home located in Atherstone which briefly comprises: Lounge, dining room, family room, kitchen, utility room, four bedrooms, bathroom & ensuite, rear garden and off road parking. Viewing is essential.



Atherstone is a well-established market town offering an ideal setting for family life. The town benefits from a good range of well-regarded primary and secondary schools, along with parks, play areas and leisure facilities suitable for all ages.

Everyday amenities are easily accessible, including local shops, supermarkets and cafés, while excellent road and rail links provide convenient access to surrounding towns and cities. Combining community atmosphere, schooling options and strong transport connections, Atherstone is a popular choice for families looking to settle long-term.

### ENTRANCE HALL

Laminated wooden effect flooring, double panelled radiator, stairs leading off to the first floor landing and doors leading off to...

### GUEST WC 5' 4" x 2' 10" (1.63m x 0.86m)

Tiled floor & walls, low level WC and a wall mounted wash basin.

### LOUNGE 16' 2" x 10' 7" maximum (4.93m x 3.23m)

Double glazed window to front aspect, laminated wooden effect flooring, two single panelled radiators and double opening doors to...

### DINING ROOM 9' 9" x 8' 8" (2.97m x 2.64m)

Laminated wooden effect flooring, single panelled radiator, double glazed French doors giving access to the rear garden and a door to...

### KITCHEN 9' 4" x 10' 3" maximum (2.84m x 3.12m)

Double glazed window to rear aspect, tiled floor, double panelled radiator, a range of base and eye level kitchen units, square edge work surfaces, tiling to splash back areas, integrated low level single oven, gas hob with extractor over, integrated dishwasher, stainless steel sink, door to the family room and an opening to...

### UTILITY ROOM 5' 9" x 6' 3" (1.75m x 1.91m)

Door giving access to the rear garden, tiled floor, integrated fridge/freezer and space for a washing machine.

### FAMILY ROOM 15' 3" x 7' 9" (4.65m x 2.36m)

Double glazed window to front aspect, laminated wooden effect flooring and a double panelled radiator.

### FIRST FLOOR LANDING

Doors leading off to...

### BEDROOM ONE 11' 1" x 13' 9" plus hallway to ensuite (3.38m x 4.19m)

Double glazed window to front aspect, useful built in wardrobe, single panelled radiator and a door to...



### **ENSUITE 5' 1" x 8' 5" (1.55m x 2.57m)**

Opaque double glazed window to front aspect, tiled floor, tiling to splash back areas, useful vanity unit with wash basin, low level WC and a shower enclosure with mixer style shower over.

### **BEDROOM TWO 11' 9" x 10' 5" maximum (3.58m x 3.18m)**

Double glazed window to rear aspect and a single panelled radiator.

### **BEDROOM THREE 7' 5" x 8' 7" (2.26m x 2.62m)**

Double glazed window to rear aspect and a single panelled radiator.

### **BEDROOM FOUR 7' 5" x 8' 5" (2.26m x 2.57m)**

Double glazed window to rear aspect and a single panelled radiator.

### **BATHROOM 5' 6" x 8' 6" (1.68m x 2.59m)**

Opaque double glazed window to side aspect, tiled floor & walls, heated towel rail, pedestal wash basin, low level WC and a panelled bath.

### **TO THE EXTERIOR**

To the front of the property there is a full width block paved driveway providing ample off road parking. The enclosed rear garden has a good sized artificial lawn for low maintenance, space for a storage shed at the rear and a paved patio area.

**FIXTURES & FITTINGS:** Some items maybe available subject to separate negotiation.

**SERVICES:** We understand that all mains services are connected.

**TENURE:** We have been informed that the property is FREEHOLD, however we would advise any potential purchaser to verify this through their own Solicitor.

**COUNCIL TAX:** We understand this property has been placed in Council Tax Band D. (This information is provided from the Council Tax Valuation List Website).

**DISCLAIMER:** DETAILS HAVE NOT BEEN VERIFIED BY THE OWNERS OF THE PROPERTY AND THEREFORE MAY BE SUBJECT TO CHANGE AND ANY PROSPECTIVE PURCHASER SHOULD VERIFY THESE FACTS BEFORE PROCEEDING FURTHER. ANY IMAGES ARE FOR SOLELY FOR ILLUSTRATIVE PURPOSES.



131 Long Street  
Atherstone, Warwickshire  
CV9 1AD

www.markwebsterandco.co.uk  
01827 720 777

Mon – Fri: 9:00am – 5:30pm  
Sat: 9:00am – 4:00pm





GROUND FLOOR  
603 sq.ft. (56.1 sq.m.) approx.

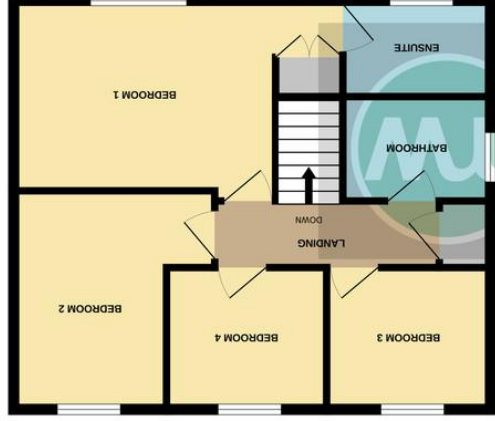

1ST FLOOR  
539 sq.ft. (50.1 sq.m.) approx.

Whilst every attempt has been made to ensure the accuracy of the floorplan contained here, measurements of doors, windows, rooms and any other items are approximate and no responsibility is taken for any error, omission or mis-statement. This plan is for illustrative purposes only and should be used as such by any prospective purchaser. The services, systems and appliances shown have not been tested and no guarantee as to their operability or efficiency can be given.  
Made with Mapbox ©2026

**COMPANY DISCLAIMER** – All fixtures, fittings, appliances and services have not been tested and therefore no guarantee can be given that they are in working order. While we endeavour to make our sales particulars reliable and accurate, measurements quoted are approximate and for guidance only. Photographs are for illustration only and may depict items not included in the sale of the property.

**Property Mis-description Act 1991** – The Agent has not tested any apparatus, equipment, fixtures or services and so does not verify they are in working order, fit for their purpose or within ownership of the sellers, therefore the buyer must assume the information given is incorrect. Neither has the Agent checked the legal status of the property or the validity of any guarantee. Buyers must assume the information is incorrect, until their own solicitors have verified it. The measurements supplied are for general guidance and as such must be considered incorrect. A buyer is advised to re-check the measurements themselves before committing themselves to any expense. Nothing concerning the type of construction of the condition of the structure is to be implied from the photograph of the property. The sales particulars may change in course of time, and any interested part is advised to make final inspection of the property prior to exchange of contracts.

**Misrepresentation Act 1937** – These details are prepared as a general guide only and should not be relied upon as a basis to enter into legal contract or to commit expenditure. An interested party should consult their own surveyor, solicitor or other professionals before committing themselves to any expenditure or other information from the Agent, then a request should be made upon any information from the Agent, then a request should be made and specific written confirmation provided. The agent will not be responsible for any verbal statement made by any member of staff, as only specific written confirmation should be relied on. The Agent will not be responsible for any loss other than when specific information has been requested.

