



59 Honeywood Drive, Nottingham – NG3 6ND

Guide Price **£190,000**

DavidJames
the estate agent



59 Honeywood Drive

Nottingham, Nottingham

Well-presented three-bed mid-townhouse offering stylish and practical living with spacious lounge, dining kitchen, low maintenance west-facing rear garden and a driveway with garage! Council Tax band: A

Tenure: Leasehold

EPC Energy Efficiency Rating: C

EPC Environmental Impact Rating:

- Well-presented mid-townhouse
- Ideal for a first-time buyer or growing family
- Situated close to local amenities and bus services
- Welcoming and thoughtfully styled lounge with useful cloakroom cupboard providing excellent storage
- Well-equipped fitted kitchen with shaker style units and traditional Belfast sink
- Three bedrooms (including bedroom two with fitted wardrobes)
- Bright and airy main bedroom featuring stylish half-wall panelling
- Modern fully tiled three-piece bathroom suite with electric shower over the bath
- West-facing low maintenance rear garden with a combination of decking and paving
- Driveway and garage providing convenient off-road parking







Floor 0 Building 1

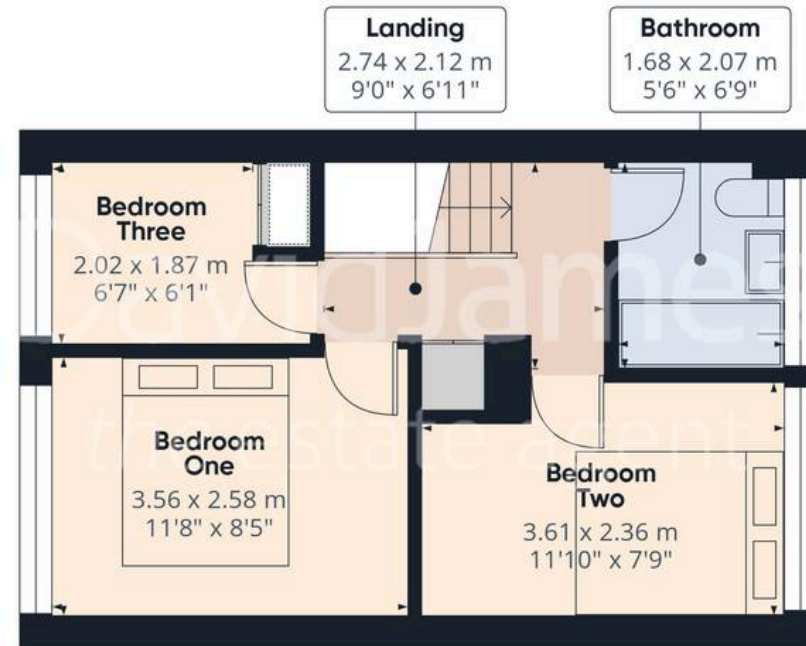

Floor 1 Building 1



Floor 0 Building 2



Approximate total area⁽¹⁾

61.9 m²

666 ft²

Reduced headroom

1.3 m²

14 ft²

(1) Excluding balconies and terraces

Reduced headroom

Below 1.5 m/5 ft

Calculations reference the RICS IPMS 3C standard. Measurements are approximate and not to scale. This floor plan is intended for illustration only.

GIRAFFE360



David James Estate Agents

376 Carlton Hill, Carlton - NG4 1JA

0115 987 8957 • carlton@david-james.com • www.david-james.com

These particulars are produced in good faith and are set out as a general guide only. Measurements are approximate and floor plans are for illustrative purposes only. Services have not been tested. We have established professional relationships with third-party suppliers for the provision of services to Clients, details of which can be found on the property listing page on our website.