



97 Chatsworth Road

Abbey Meads, Swindon

£260,000  
mcfarlane  
property.com





## 97 Chatsworth Road

Welcome to this 2-bedroom SEMI-DETACHED HOUSE nestled in a sought-after location! Boasting TWO DOUBLE BEDROOMS, this home offers comfort and space for a growing family or those seeking a spare room for guests or a home office. The CONSERVATORY is the perfect spot for relaxing or hosting gatherings, adding a lovely touch to the property. Situated on a CORNER PLOT, the house enjoys a unique aspect and allows for extra privacy.

With the convenience of 2 parking spaces on a private drive and one to the side of the property, you'll never have to worry about finding a space after a long day. The property is ideally located close to a range of AMENITIES and SCHOOLS, making it a great choice for families. Don't miss the chance to call this place home! Book a viewing today and imagine the possibilities this home has to offer.



- TWO DOUBLE BEDROOMS
- CONSERVATORY
- CORNER PLOT
- 2 PARKING SPACES ON PRIVATE DRIVEWAY AND ONE TO THE SIDE
- CLOSE TO AMENITIES AND SCHOOLS
- SEMI-DETACHED
- MAIN BATHROOM





### Ground Floor

Approx. 37.0 sq. metres (398.7 sq. feet)

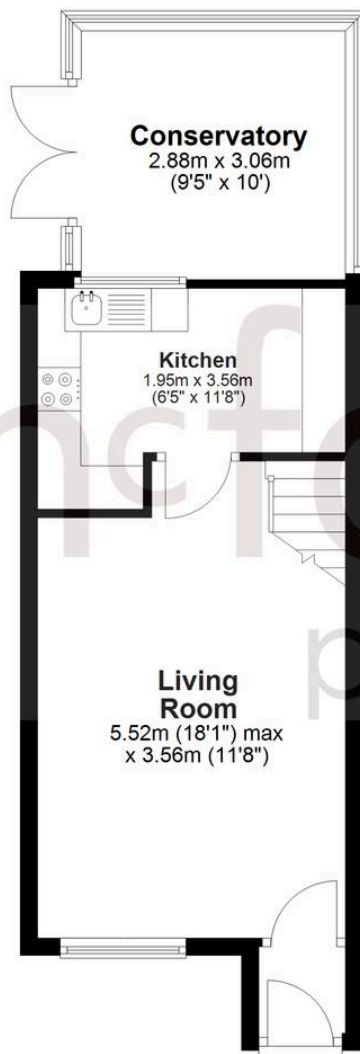

### First Floor

Approx. 26.8 sq. metres (288.1 sq. feet)

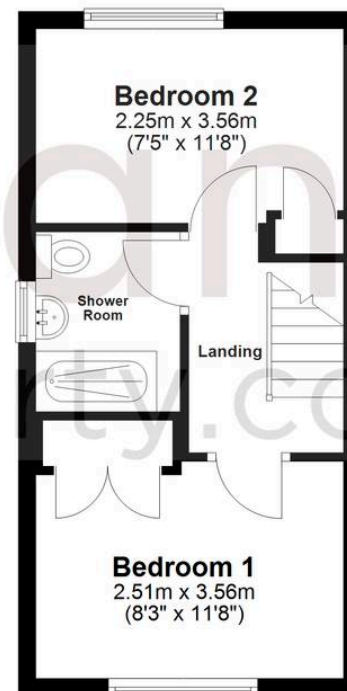

Total area: approx. 63.8 sq. metres (686.9 sq. feet)

## McFarlane Sales & Lettings

North Swindon, Redhouse Village Centre, Swindon – SN25 2FW

01793 296600 • [swindon@mcfarlaneproperty.com](mailto:swindon@mcfarlaneproperty.com) • [www.mcfarlaneproperty.com/](http://www.mcfarlaneproperty.com/)