



12 Sherwood Avenue, Radcliffe

Manchester

£279,950



# 12 Sherwood Avenue

Radcliffe, Manchester

Traditional 3-bed semi in Three Arrows with woodland views, decked garden area, open-plan lounge, modern bathroom, driveway, garage, no onward chain. Close to amenities and transport links.

Council Tax band: D

Tenure: Leasehold

EPC Energy Efficiency Rating: D

EPC Environmental Impact Rating:

- Traditional Semi Detached House with 3 Bedrooms
- Set in a Highly Desirable Three Arrows location with Starling Woods to the rear
- Decked rear garden with attractive woodland aspect
- Spacious paved driveway, detached garage
- Entrance hall, fitted kitchen, open plan lounge/dining room
- Modern Spacious white 4 piece family bathroom suite
- Close to local bus routes & access for Bury & Bolton town centres
- Offered with No Chain viewings are Highly Recommended

GROUND FLOOR



1ST FLOOR

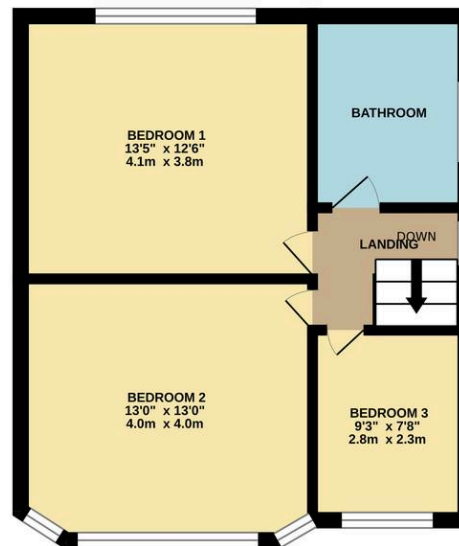

Whilst every attempt has been made to ensure the accuracy of the floorplan contained here, measurements of doors, windows, rooms and any other items are approximate and no responsibility is taken for any error, omission or mis-statement. This plan is for illustrative purposes only and should be used as such by any prospective purchaser. The services, systems and appliances shown have not been tested and no guarantee as to their operability or efficiency can be given.  
Made with Metropix ©2024





