



15 Church Walk Pound Lane, Elham - CT4 6UA

Guide Price **£139,000**

Approximate Gross Internal Area = 47 sq m / 506 sq ft

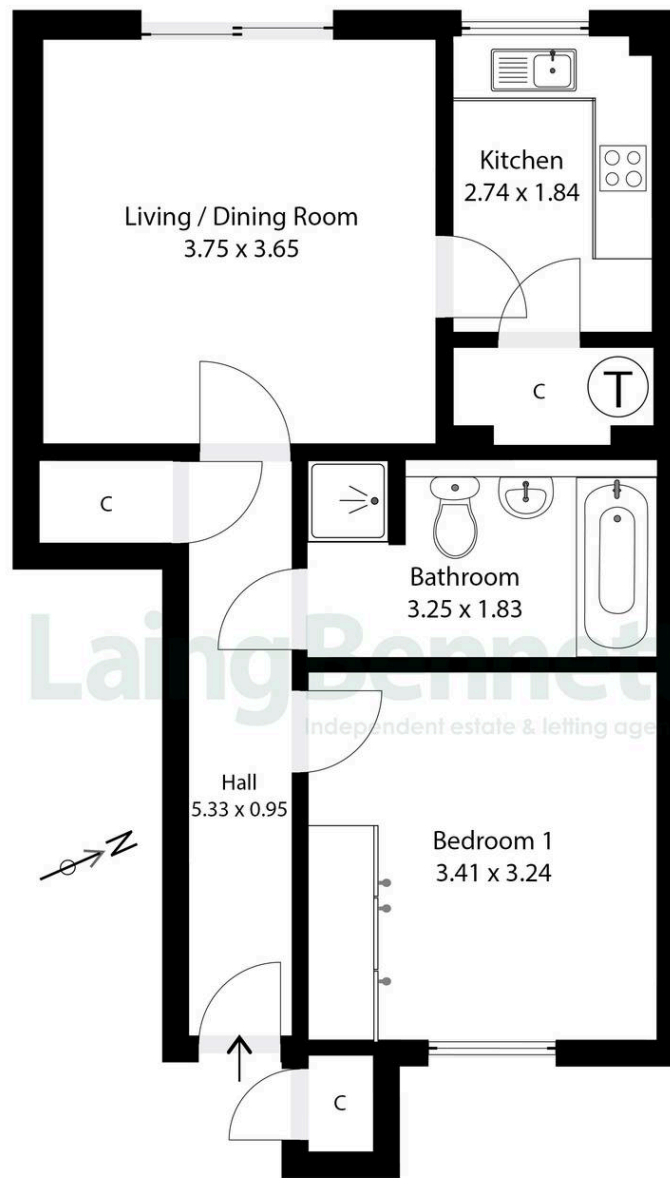

Illustration for Identification purposes only. Measurements are approximate. Dimensions given are between the widest points.

Not to scale. Outbuildings are not shown in actual location.

© Unauthorised reproduction prohibited - chriskemps@hotmail.com



15 Church Walk Pound Lane

Elham, Canterbury

A beautifully ground floor self retirement apartment situated in the heart of the village of Elham, which is close to amenities and benefits from a thriving community. Accommodation Comprises: Porch, hallway, living/dining room with patio doors, kitchen, bedroom with fitted wardrobe and bath/shower room/WC. There is a parking area for the residents and delightful communal gardens.

Council Tax band: B

Tenure: Leasehold

EPC Energy Efficiency Rating: C

EPC Environmental Impact Rating:





Laing Bennett

Laing Bennett Ltd, The Estate Office, 8 Station Road – CT18 8HP

01303 863393

info@laingbennett.co.uk

www.laingbennett.co.uk/

DISCLAIMER – These details are for guidance only and do not form part of an offer or contract. Measurements are approximate. Laing Bennett Ltd and the Vendor/Landlord accept no liability. Services and appliances are untested. Applicants must make their own checks. Items shown may not be included. No staff have authority to give warranties.