



**The Rowan , Restrop Road, Purton**  
Swindon

**£690,000**





## The Rowan, Restrop Road

Purton, Swindon

**\*\*DETACHED NEW HOME\*** with immaculate attention to detail awaits its new owners! This stunning **\*\*FOUR BEDROOM\*\*** property is **MOVE CHAIN FREE WITH PART EXCHANGE**. Boasting a wealth of space, the ground floor features a generous **KITCHEN / DINING ROOM**, a **SEPARATE SITTING ROOM**, a versatile **STUDY / FAMILY ROOM**, a convenient **UTILITY**, and a **WC**. Upstairs, you will find **FOUR BEDROOMS**, with **TWO EN-SUITES** and a **FAMILY BATHROOM**, ensuring utmost convenience and luxury. Completing this home is a **SINGLE GARAGE** and **\*\*2 PARKING SPACES\*\***, making this property as practical as it is beautiful.

Step outside into the charming garden space, perfect for entertaining or simply enjoying the sunshine! The landscaped rear garden offers a tranquil oasis, ideal for relaxing after a long day. Whether you're hosting a summer barbeque or watching the little ones play, this outside space provides the perfect backdrop for every occasion. Don't miss this opportunity to make this impeccable property your forever home!

Tenure: Freehold - Service Charge : N/A - Council Tax : TBC - Management Fee : £404.82 p/a



### Entrance Hall

### Sitting Room

19' 2" x 11' 0" (5.85m x 3.36m)

### Kitchen / Dining Room

17' 3" x 14' 4" (5.26m x 4.37m)

### Study / family Room

12' 8" x 9' 9" (3.85m x 2.97m)

### Utility

### WC

### Landing

### Bedroom 1

17' 5" x 14' 4" (5.31m x 4.37m)

### En-Suite

### Bedroom 2

14' 6" x 9' 8" (4.41m x 2.95m)

### En-suite

### Bedroom 3

8' 2" x 13' 5" (2.49m x 4.08m)

### Bedroom 4

8' 1" x 11' 1" (2.47m x 3.39m)

### Bathroom





**Ground Floor**

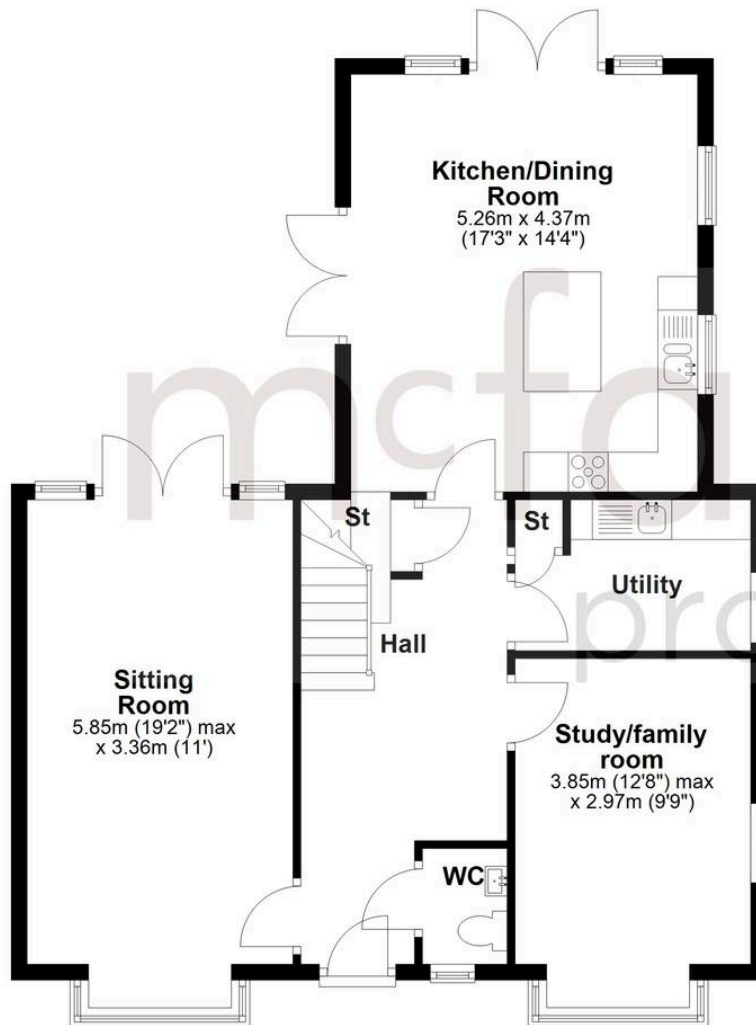

**First Floor**

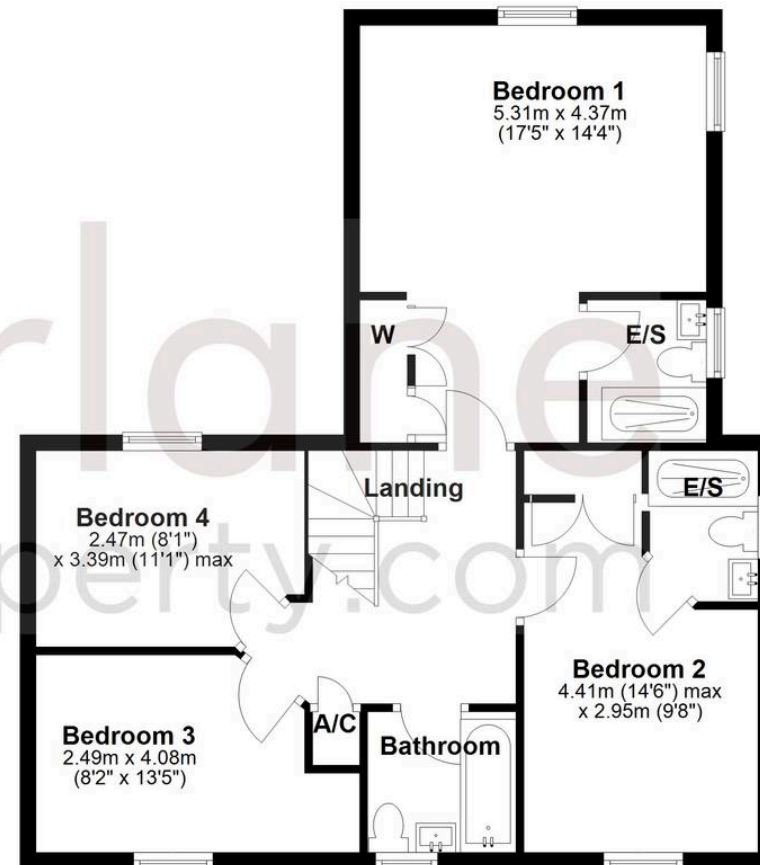

## McFarlane Sales & Lettings

North Swindon, Redhouse Village Centre, Swindon - SN25 2FW

01793 296600 • [swindon@mcfarlaneproperty.com](mailto:swindon@mcfarlaneproperty.com) • [www.mcfarlaneproperty.com/](http://www.mcfarlaneproperty.com/)