



Bermondsey Square, SE1

£2,150,000















# Bermondsey Square

London, London

A beautifully presented Grade II listed Georgian house dating from the late 18th century, with extensively renovated interior on 4 floors quietly located in the corner of this historic square.

Council Tax band: F

Tenure: Freehold

EPC Energy Efficiency Rating: D

EPC Environmental Impact Rating: E

- Grade II Listed Georgian townhouse
- Believed to date from the late 18th Century
- Beautifully refurbished interior
- Numerous period features
- Private walled south facing garden
- Generous interior on four floors
- Comprehensively fitted and fully equipped kitchen
- Quietly located in the corner of this Historic square





# Bermondsey Square, London, SE1

Approximate Area = 1782 sq ft / 160.5 sq m

For identification only - Not to scale



FIRST FLOOR

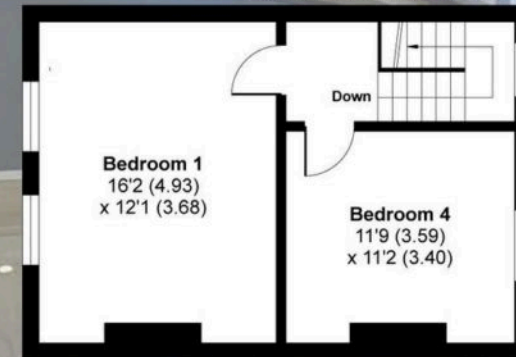

SECOND FLOOR



GROUND FLOOR

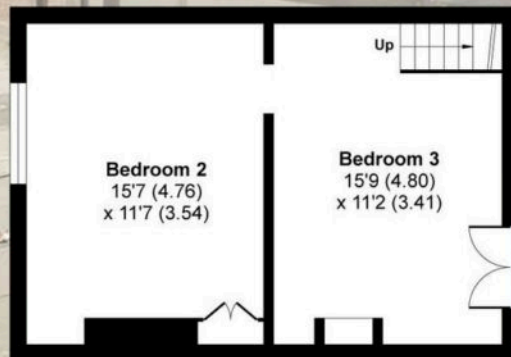

LOWER GROUND FLOOR



Floor plan produced in accordance with RICS Property Measurement 2nd Edition, Incorporating International Property Measurement Standards (IPMS2 Residential). © n'che.com 2025. Produced for Daniel Cobb. REF: 1321770





## Daniel Cobb

Daniel Cobb Estate Agents, 82-84 Bermondsey Street – SE1 3UD

020 7357 0026 • [londonbridge@danielcobb.co.uk](mailto:londonbridge@danielcobb.co.uk) • [www.danielcobb.co.uk/](http://www.danielcobb.co.uk/)