



Flat 3, Hughenden Manor Woodend Road, Torquay – TQ1 2  
£85,000







## Flat 3

Hughenden Manor Woodend Road,  
Torquay

Ground-floor one-bedroom apartment in a Victorian conversion, moments from Wellswood Village and within easy reach of the harbour and coastline. 999-year lease, share of freehold and an allocated parking space, with further potential to enhance.

Council Tax band: B

Tenure: Share of Freehold

EPC Energy Efficiency Rating: D

EPC Environmental Impact Rating: D

- Ground-floor apartment within an attractive Victorian converted building.
- Quiet cul-de-sac position at the end of Woodend Road.
- A short stroll to Wellswood Village shops, cafés and restaurants.
- Walkable access to Torquay Harbour and the seafront lifestyle.
- Large double bedroom with tall windows.
- Separate lounge and separate modern kitchen.
- Reception hallway with handy built-in storage.
- Separate WC plus separate bathroom suite with shower over.
- Long original 999-year lease with share of the freehold.
- Allocated parking space





## Flat 3

Hughenden Manor Woodend Road, Torquay

Woodend Road sits in a highly convenient spot just off Wellswood, placing village shops, cafés and day-to-day amenities within easy reach on foot. The seafront lifestyle is a big draw here: Torquay Harbour is walkable, and you've got excellent access to coastal favourites including Babbacombe and Anstey's Cove, plus open green space at Meadfoot. Local bus routes connect into Torquay town centre and surrounding areas, with Torquay Station providing rail links and the A380 giving straightforward road access towards Newton Abbot, Exeter, the M5 and beyond.

### Absolute Sales & Lettings

Absolute Sales & Lettings Ltd, 13 Ilsham Road - TQ1 2JG

01803 214214

[torquay@movewithabsolute.co.uk](mailto:torquay@movewithabsolute.co.uk)

[movewithabsolute.co.uk/](http://movewithabsolute.co.uk/)



## Ground Floor

Approx. 40.0 sq. metres (430.2 sq. feet)

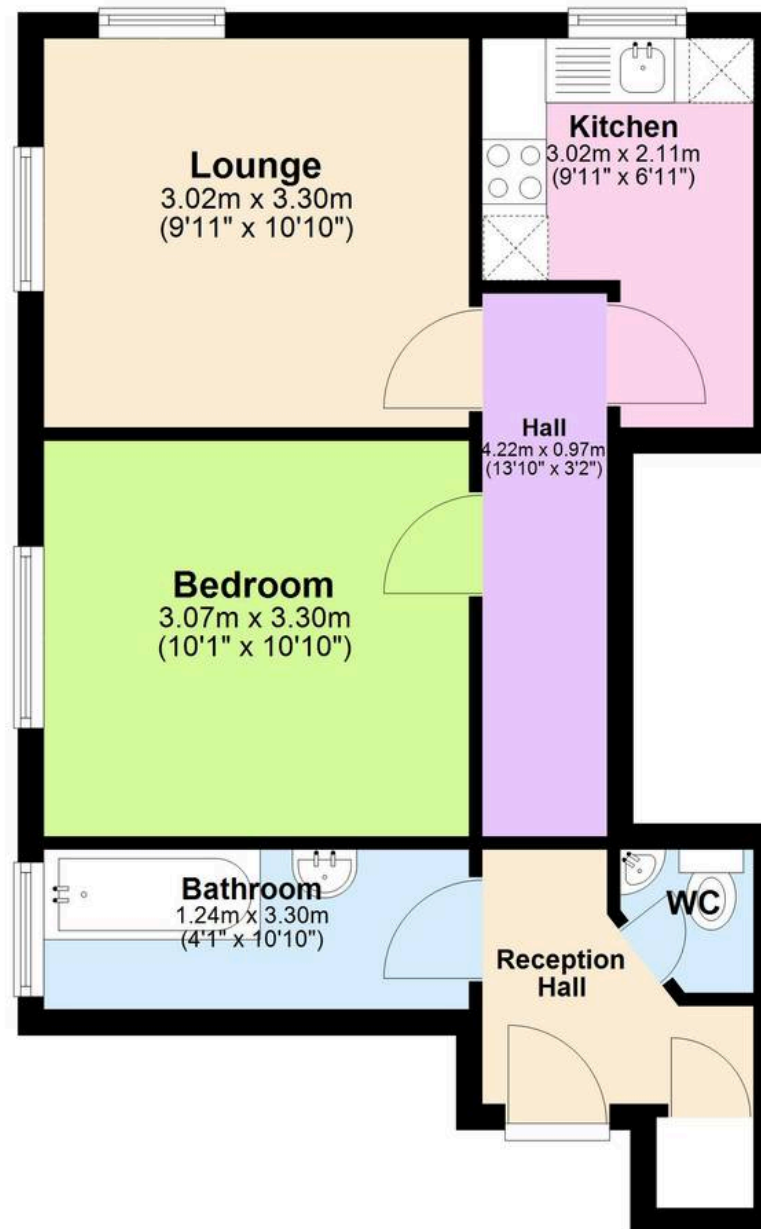

Total area: approx. 40.0 sq. metres (430.2 sq. feet)

