



See More Online

MIR: Material Info

The Material Information Affecting this Property

Tuesday 10th February 2026



CHURCH CLOSE, ABINGTON, CAMBRIDGE, CB21

Cooke Curtis & Co

40 High Street Trumpington Cambridge CB2 9LS

01223 508 050

jessica@cookecurtis.co.uk

www.cookecurtis.co.uk



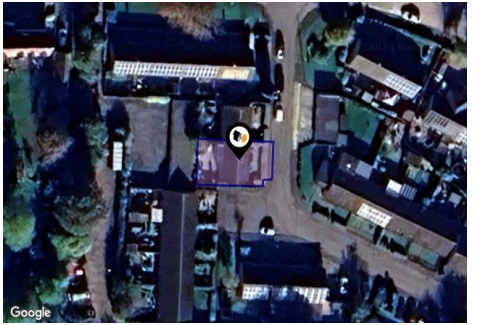
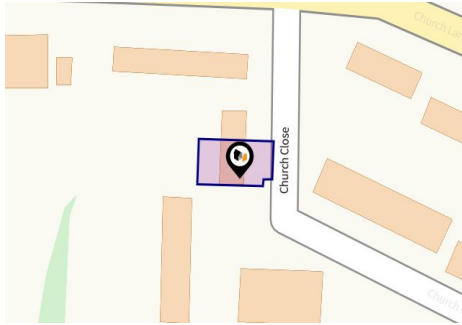















Property

Type:	Semi-Detached	Tenure:	Freehold
Bedrooms:	3		
Floor Area:	624 ft ² / 58 m ²		
Plot Area:	0.05 acres		
Council Tax :	Band C		
Annual Estimate:	£2,146		
Title Number:	CB137044		

Local Area

Local Authority:	Cambridgeshire	Estimated Broadband Speeds (Standard - Superfast - Ultrafast)		
Conservation Area:	No			
Flood Risk:				
• Rivers & Seas	Very low	8 mb/s	80 mb/s	1000 mb/s
• Surface Water	Very low			
Mobile Coverage: (based on calls indoors)		Satellite/Fibre TV Availability:		
				
				
				



CHURCH CLOSE, ABINGTON, CAMBRIDGE, CB21

Approximate Gross Internal Area 632 sq ft - 59 sq m

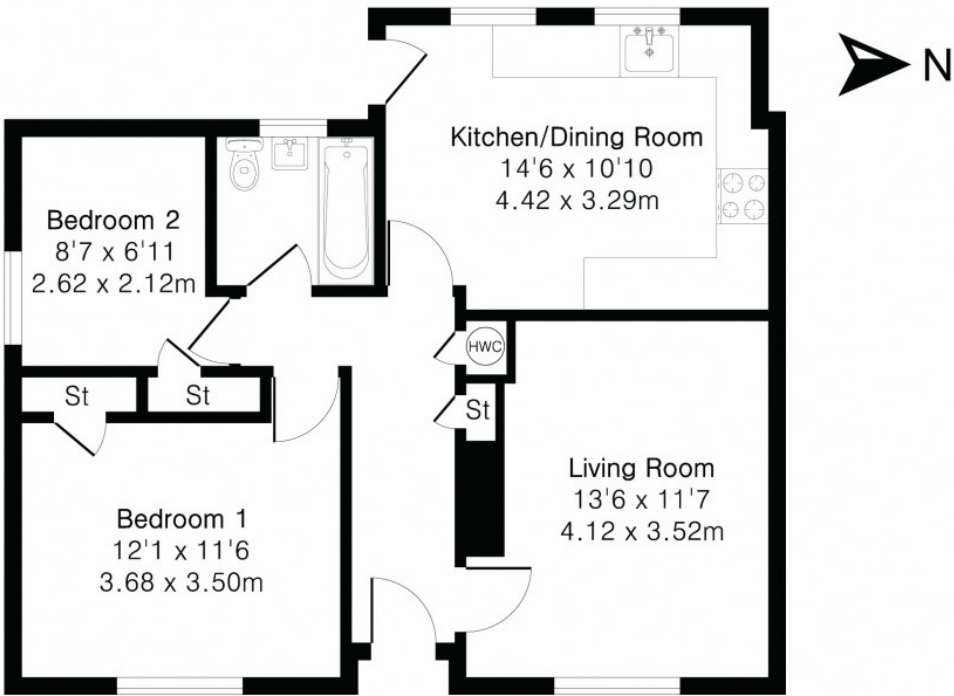

Ground Floor

Floor plan produced in accordance with RICS Property Measurement 2nd Edition. Although Pink Plan Ltd ensures the highest level of accuracy, measurements of doors, windows and rooms are approximate and no responsibility is taken for error, omission or misstatement. These plans are for representation purposes only and no guarantee is given on the total square footage of the property within this plan. The figure icon is for initial guidance only and should not be relied on as a basis of valuation.

COOKE CURTIS & CO

CHURCH CLOSE, ABINGTON, CAMBRIDGE, CB21

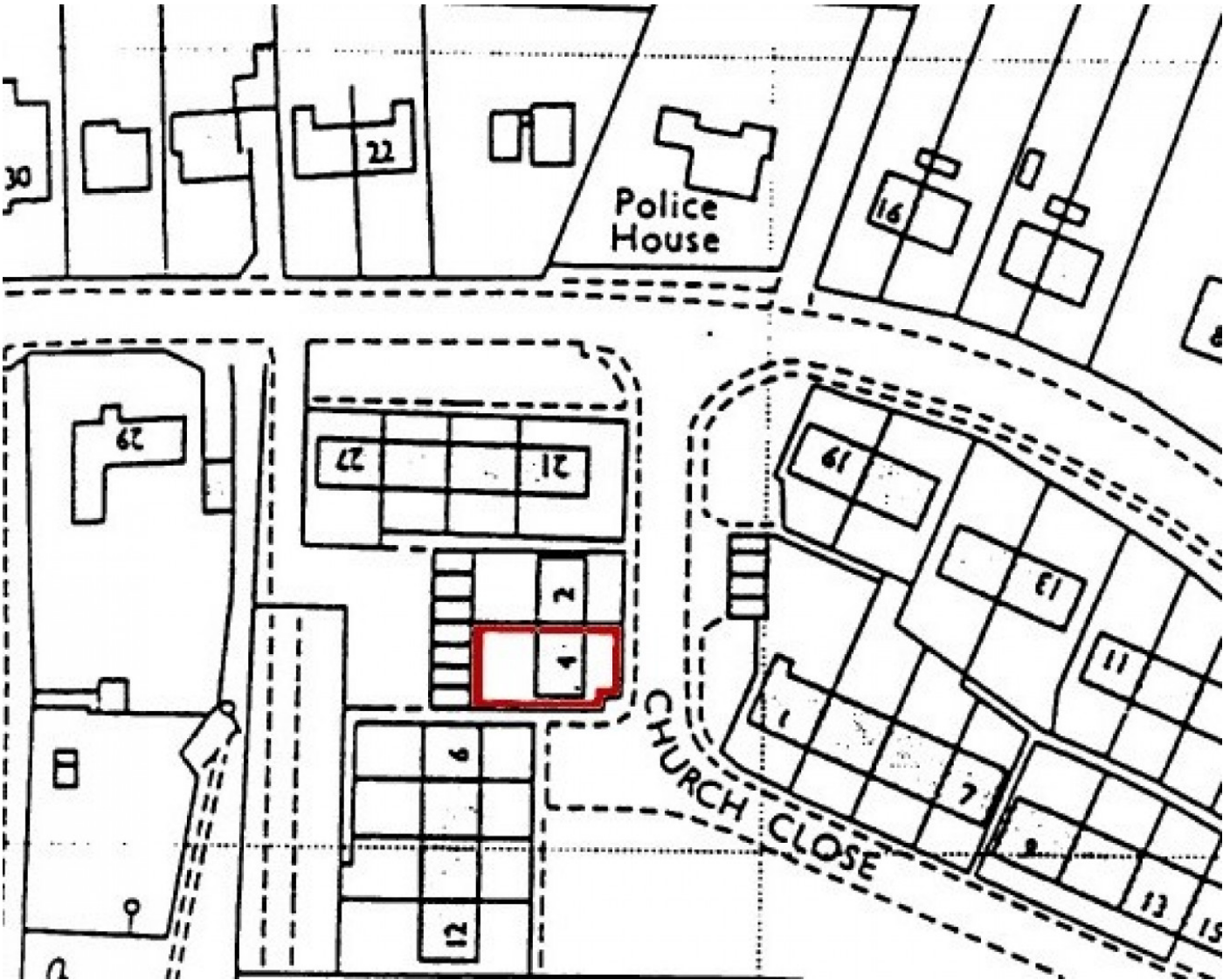

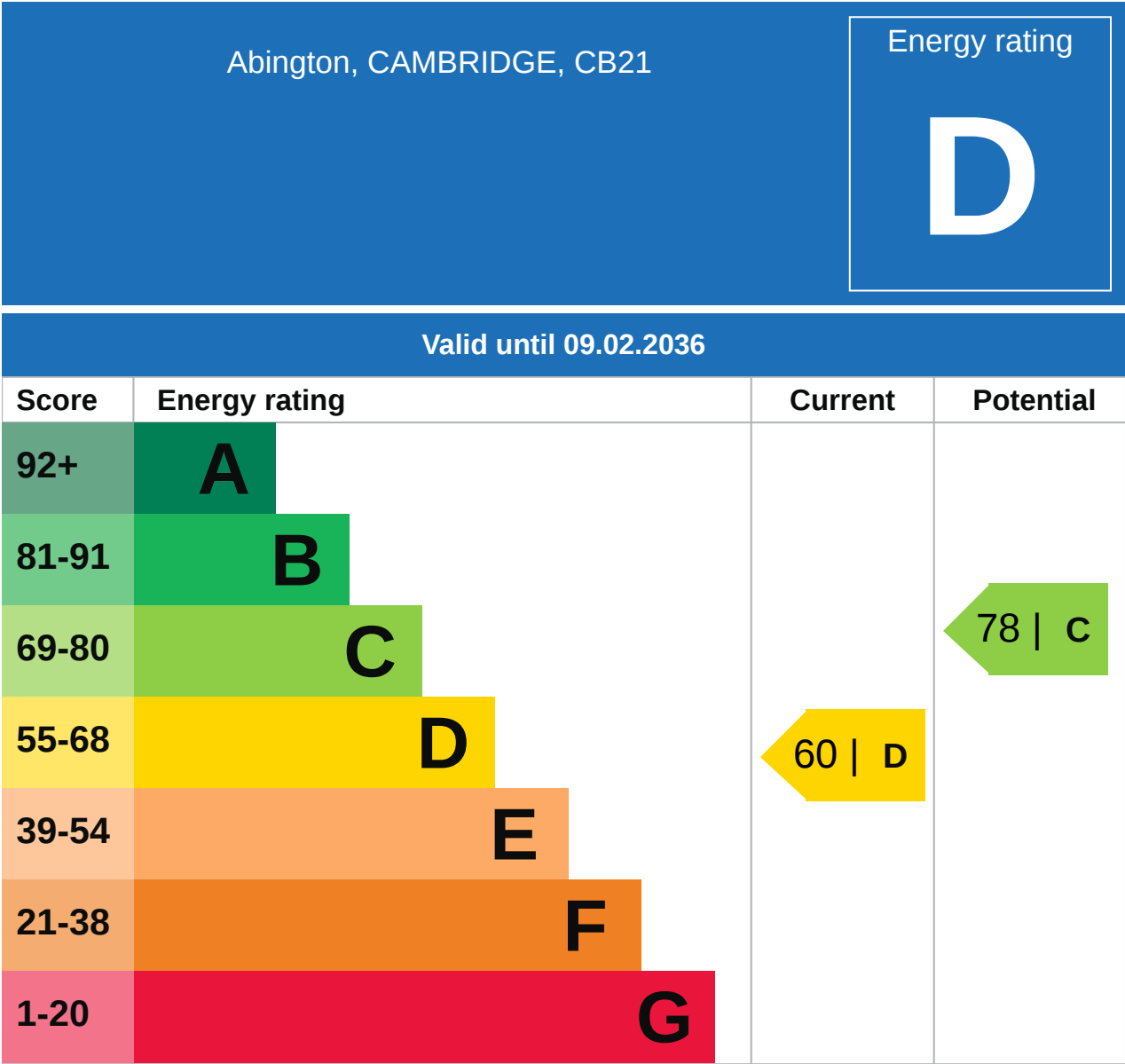

Additional EPC Data

Property Type:	Semi-detached bungalow
Walls:	Cavity wall, filled cavity
Walls Energy:	Good
Roof:	Pitched, 200 mm loft insulation
Roof Energy:	Good
Window:	Fully double glazed
Window Energy:	Poor
Main Heating:	Electric storage heaters
Main Heating Energy:	Average
Main Heating Controls:	Manual charge control
Main Heating Controls Energy:	Poor
Hot Water System:	Electric immersion, off-peak
Hot Water Energy Efficiency:	Average
Lighting:	Good lighting efficiency
Lighting Energy:	Good
Floors:	Solid, no insulation (assumed)
Secondary Heating:	Room heaters, electric
Air Tightness:	(not tested)
Total Floor Area:	58 m ²

Building Safety

Accessibility / Adaptations

Restrictive Covenants

Rights of Way (Public & Private)

Construction Type

1960 Block

Property Lease Information

Listed Building Information

Stamp Duty

Other

Other

Electricity Supply

British Gas

Gas Supply

Central Heating

Yes

Water Supply

Cambridge Water

Drainage

Testimonial 1



Great service from Cooke Curtis & co. We used them for the sale of our home as they were the agents for a property we wanted to buy. They quickly valued, took photos and put it on the market with viewings soon after. Them handling both sides of the deal was a huge help with one complexity of the epic process of house purchasing removed. The agents were particularly calm, reasonable and responsive by email and telephone. Thanks you!

Testimonial 2



Since purchasing our house from Cooke Curtis and Co in 2017, we knew that if ever we were to sell, it would be with them. Of the various estate agents we asked to value the property, Cooke Curtis and Co were the *only* company that didn't need chasing and returned our calls promptly, and kept us up-to-date on progress of the sale. I have no hesitation in recommending Cooke Curtis and Co, as indeed I have done to friends thinking of selling in the area.

Testimonial 3



Being from Cambridge we have rented, bought and sold through many different estate agents over the years, and I can safely say that Cooke Curtis & Co have been by far the best we have come across. After failing to sell our house with another agent, we made the switch and didn't regret our decision. Cooke Curtis & Co clearly care about their reputation and make sure to look after their clients. We found the team to be trustworthy, professional and reliable.

Testimonial 4



We bought a property sold by Cooke Curtis and Co. They were helpful and responded swiftly to our enquiries. It seems buying a house always takes a long time but I got the impression the estate agents did all they could to speed things along. Very happy.



/cookecurtisco



/cookecurtisco

Important - Please read

Flood Risk

Surface Water - Flood Risk



This map shows the chance of flooding where rainwater has nowhere to drain. This kind of flooding can occur far from rivers or seas.

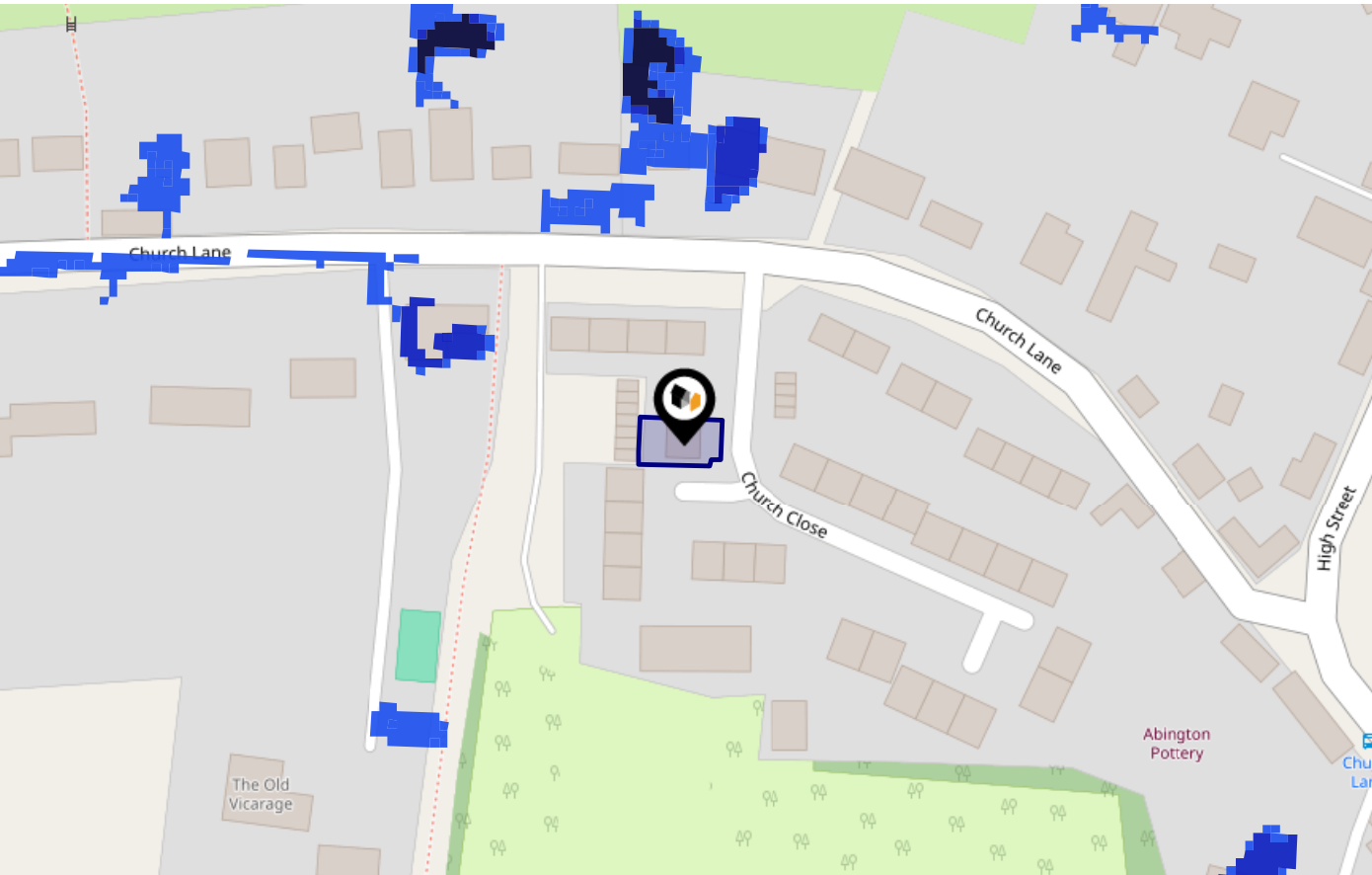

Risk Rating: Very low

The map does not contain sufficient information for it to be used to determine flood risk to individual properties, but it does give you an indication of whether your area may be affected by surface water flooding at this risk level.

- High Risk** - an area which has a chance of flooding of greater than 1 in 30 (3.3%) in any one year.
- Medium Risk** - an area which has a chance of flooding of greater than 1 in 100 (1.0%) in any one year.
- Low Risk** - an area which has a chance of flooding of greater than 1 in 1000 (0.1%) in any one year.
- Very Low Risk** - an area in which the risk is below 1 in 1000 (0.1%) in any one year.

Chance of flooding to the following depths at this property:



Flood Risk

Surface Water - Climate Change



This map shows the future chance of flooding **between 2040 and 2060** where rainwater has nowhere to drain. This kind of flooding can occur far from rivers or seas. The government climate change models cannot predict exactly when the chance of flooding will go up. It could happen at any time during the time period.

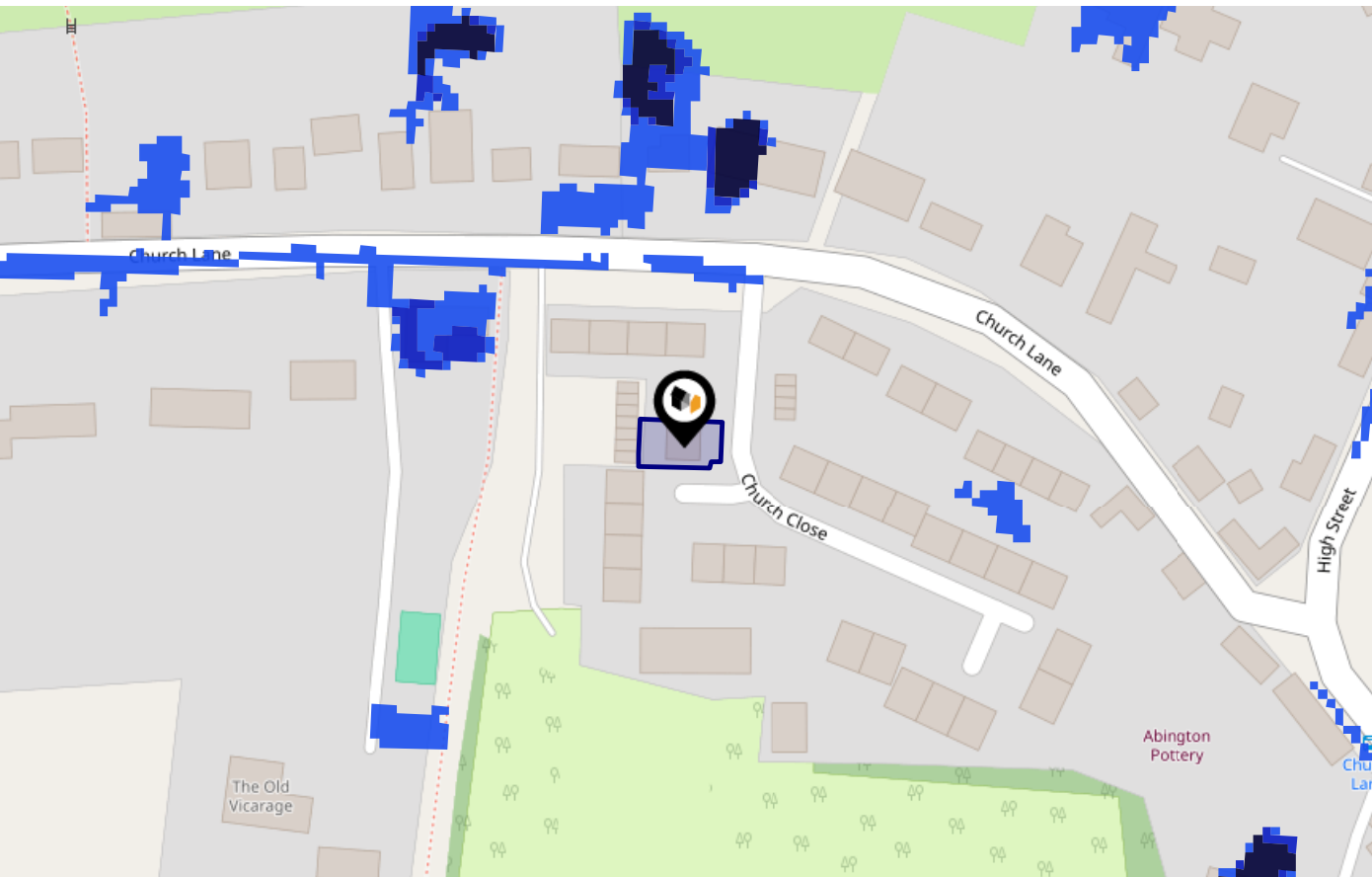

Risk Rating: Very low

The map does not contain sufficient information for it to be used to determine flood risk to individual properties, but it does give you an indication of whether your area may be affected by surface water flooding at this risk level.

- High Risk** - an area which has a chance of flooding of greater than 1 in 30 (3.3%) in any one year.
- Medium Risk** - an area which has a chance of flooding of greater than 1 in 100 (1.0%) in any one year.
- Low Risk** - an area which has a chance of flooding of greater than 1 in 1000 (0.1%) in any one year.
- Very Low Risk** - an area in which the risk is below 1 in 1000 (0.1%) in any one year.

Chance of flooding to the following depths at this property:

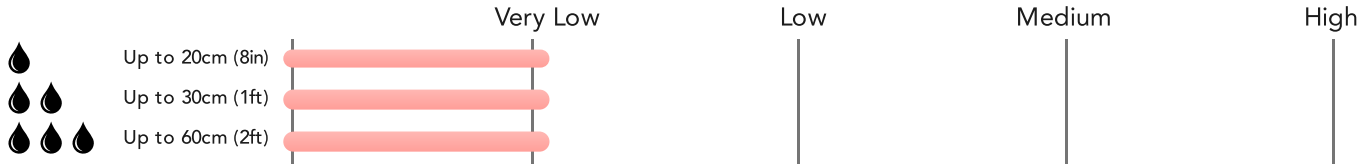

Flood Risk

Rivers & Seas - Flood Risk



This map shows the chance of flooding from rivers and / or the sea, taking into account flood defences and their condition.

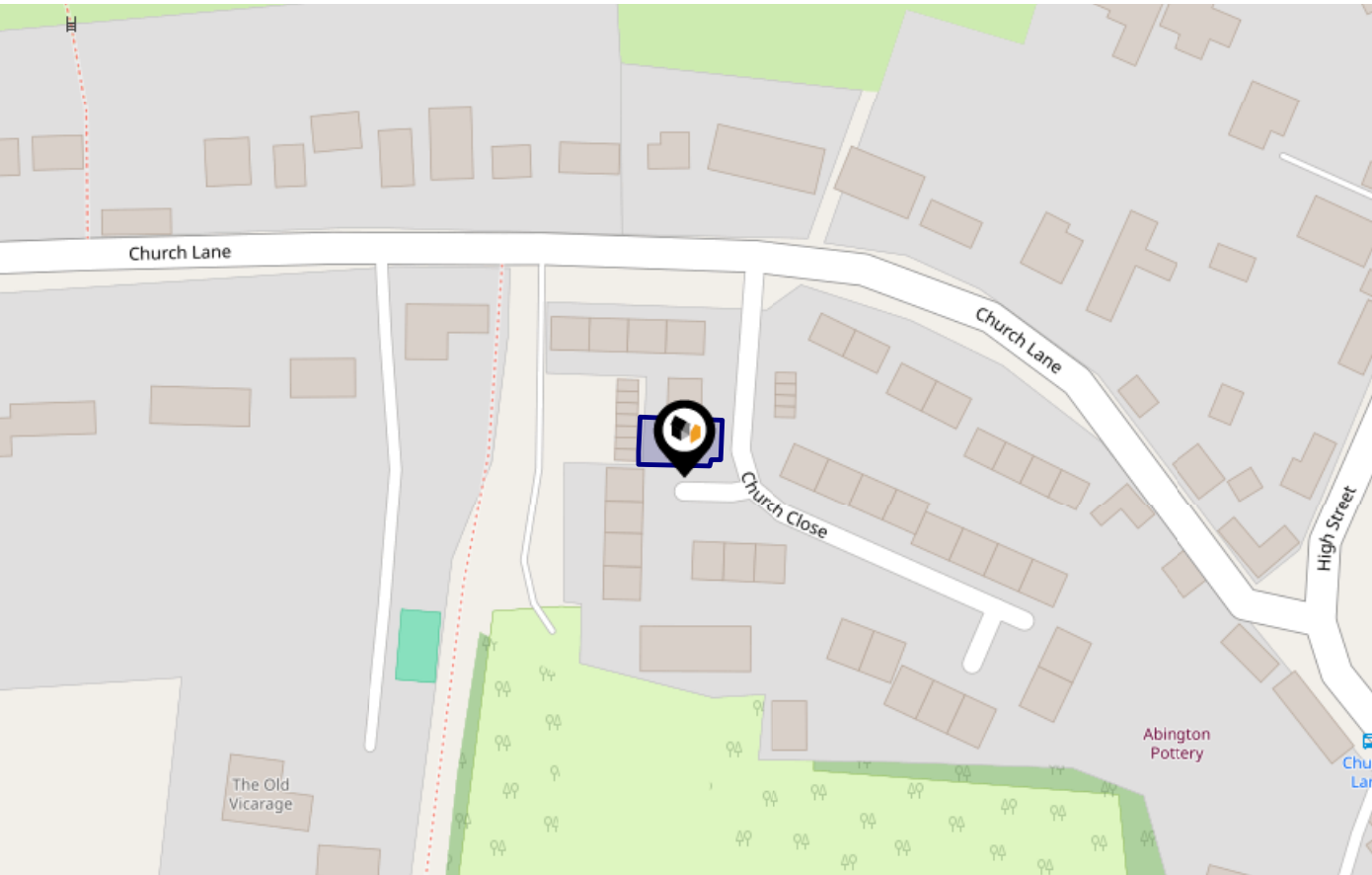

Risk Rating: Very low

The map does not contain sufficient information for it to be used to determine flood risk to individual properties, but it does give you an indication of whether your area may be affected by surface water flooding at this risk level.

- High Risk** - an area which has a chance of flooding of greater than 1 in 30 (3.3%) in any one year.
- Medium Risk** - an area which has a chance of flooding of greater than 1 in 100 (1.0%) in any one year.
- Low Risk** - an area which has a chance of flooding of greater than 1 in 1000 (0.1%) in any one year.
- Very Low Risk** - an area in which the risk is below 1 in 1000 (0.1%) in any one year.

Chance of flooding to the following depths at this property:

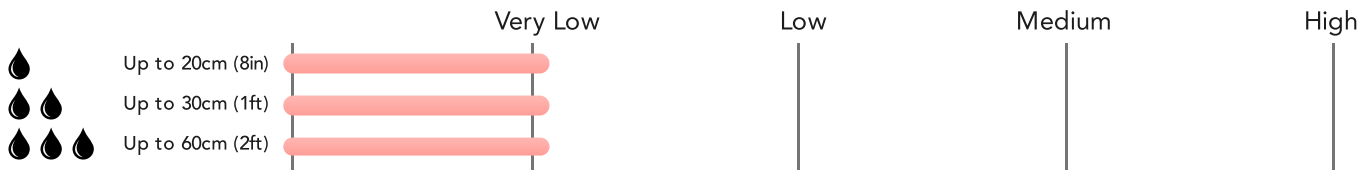

Flood Risk

Rivers & Seas - Climate Change



This map shows the future chance of flooding from rivers and / or the sea **between 2036 and 2069**, taking into account flood defences and their condition. The government climate change models cannot predict exactly when the chance of flooding will go up. It could happen at any time during the time period.

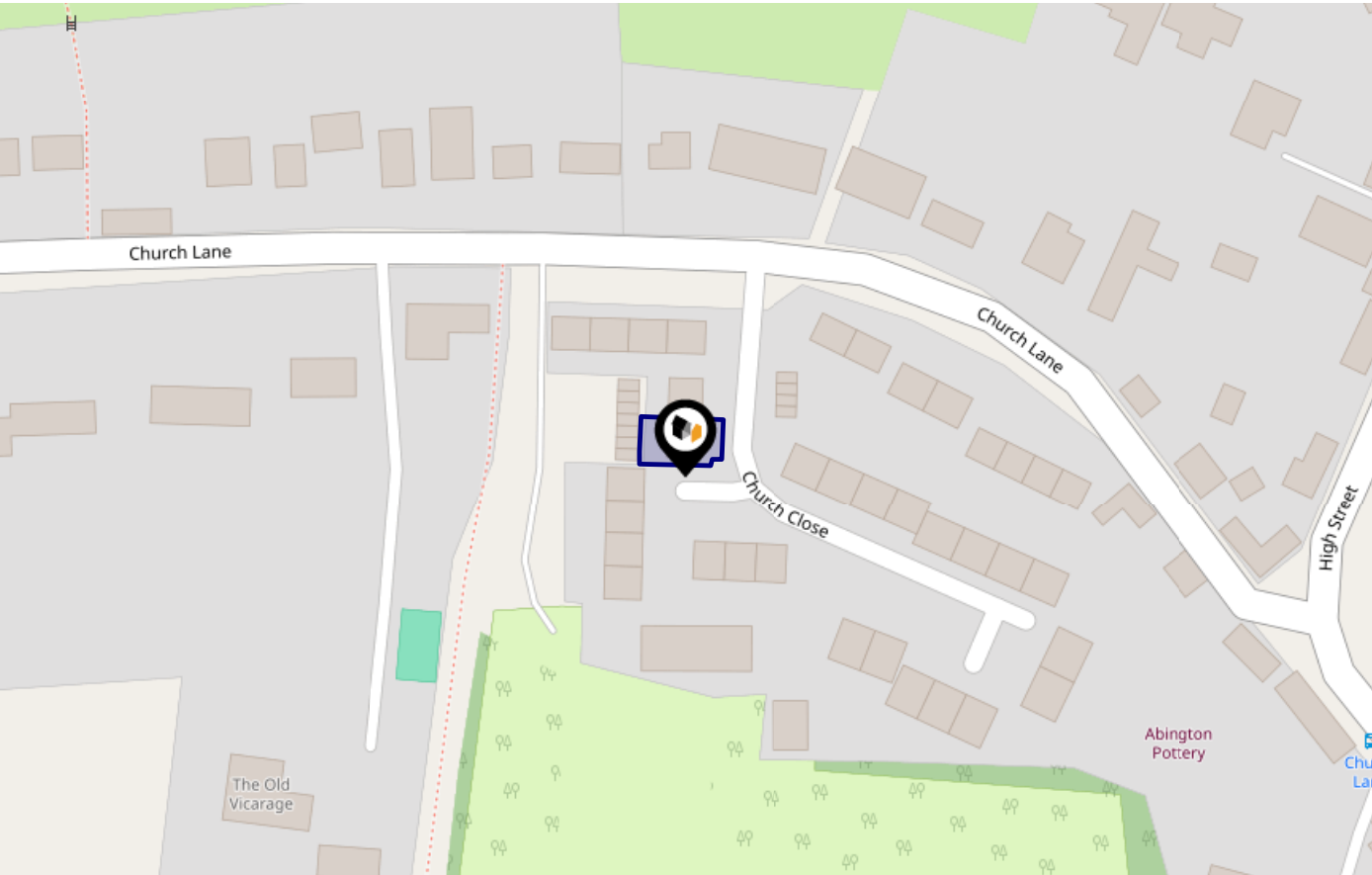

Risk Rating: Very low

The map does not contain sufficient information for it to be used to determine flood risk to individual properties, but it does give you an indication of whether your area may be affected by surface water flooding at this risk level.

- High Risk** - an area which has a chance of flooding of greater than 1 in 30 (3.3%) in any one year.
- Medium Risk** - an area which has a chance of flooding of greater than 1 in 100 (1.0%) in any one year.
- Low Risk** - an area which has a chance of flooding of greater than 1 in 1000 (0.1%) in any one year.
- Very Low Risk** - an area in which the risk is below 1 in 1000 (0.1%) in any one year.

Chance of flooding to the following depths at this property:

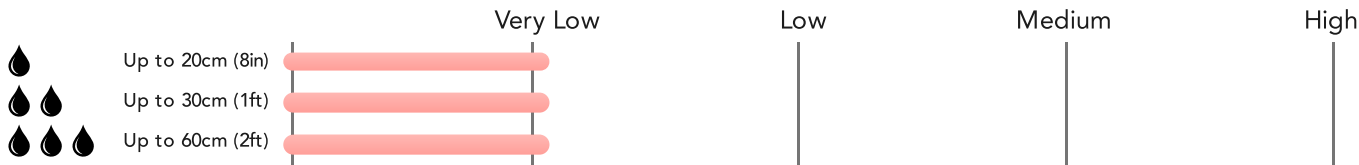

This map displays nearby official conservation areas. Every local authority in England has at least one conservation area. Most are designated by the Council as the local planning authority, though Historic England and the Secretary of State also have the power to create them.

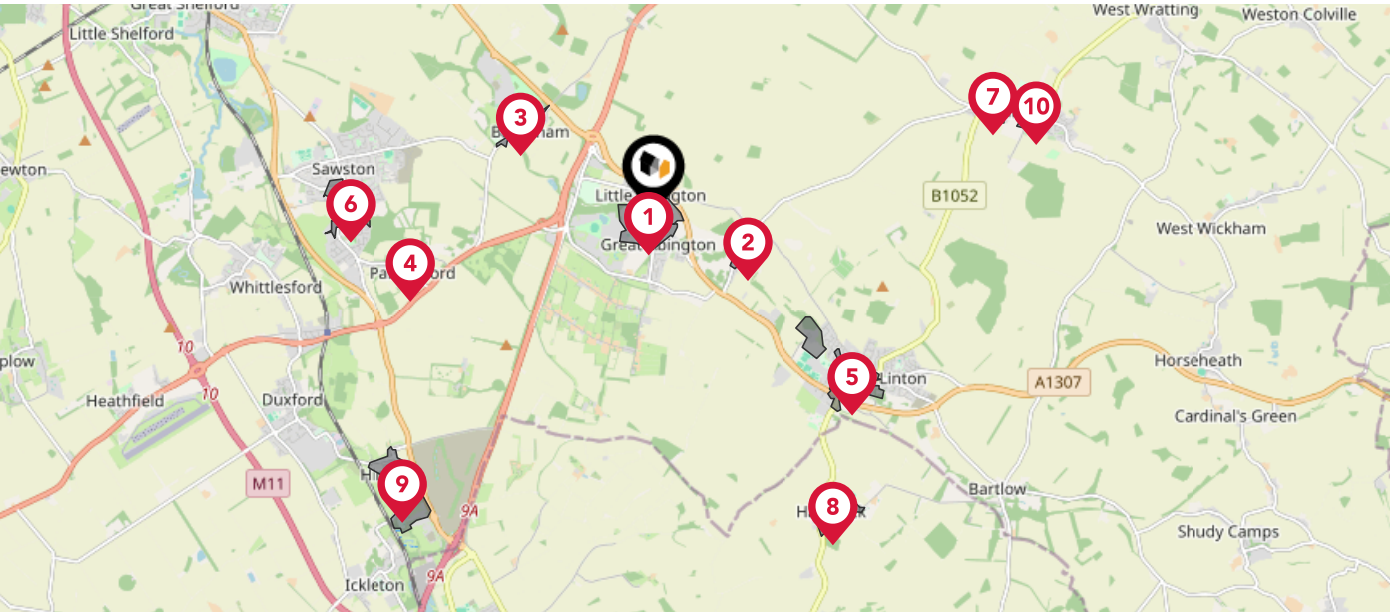

Nearby Conservation Areas	
1	Great and Little Abington
2	Hildersham
3	Babraham
4	Pampisford
5	Linton
6	Sawston
7	Balsham West End
8	Hadstock
9	Hinxton
10	Balsham Village

This map displays the location of known landfill sites. Historic sites are where there is no environmental permit in force. Active sites are currently authorised by the Environment Agency under Environmental Permitting Regulations.



Nearby Landfill Sites		
1	Home Farm-Babraham	Historic Landfill
2	Home Farm-Babraham	Historic Landfill
3	Home Farm-Babraham	Historic Landfill
4	Home Farm-Babraham, Cambridge	Historic Landfill
5	Home Farm-Babraham	Historic Landfill
6	Pen Farm-Hadstock	Historic Landfill
7	Sindalls-Sawston	Historic Landfill
8	Eastern County Leather-Sawston	Historic Landfill
9	Middleton Aggregates Ltd - Hinxton Quarry-Lordship Farm, Hinxton, Cambridgeshire	Historic Landfill
10	North Hinxton Landfill-Hinxton, Cambridgeshire	Historic Landfill

This map displays nearby coal mine entrances and their classifications.

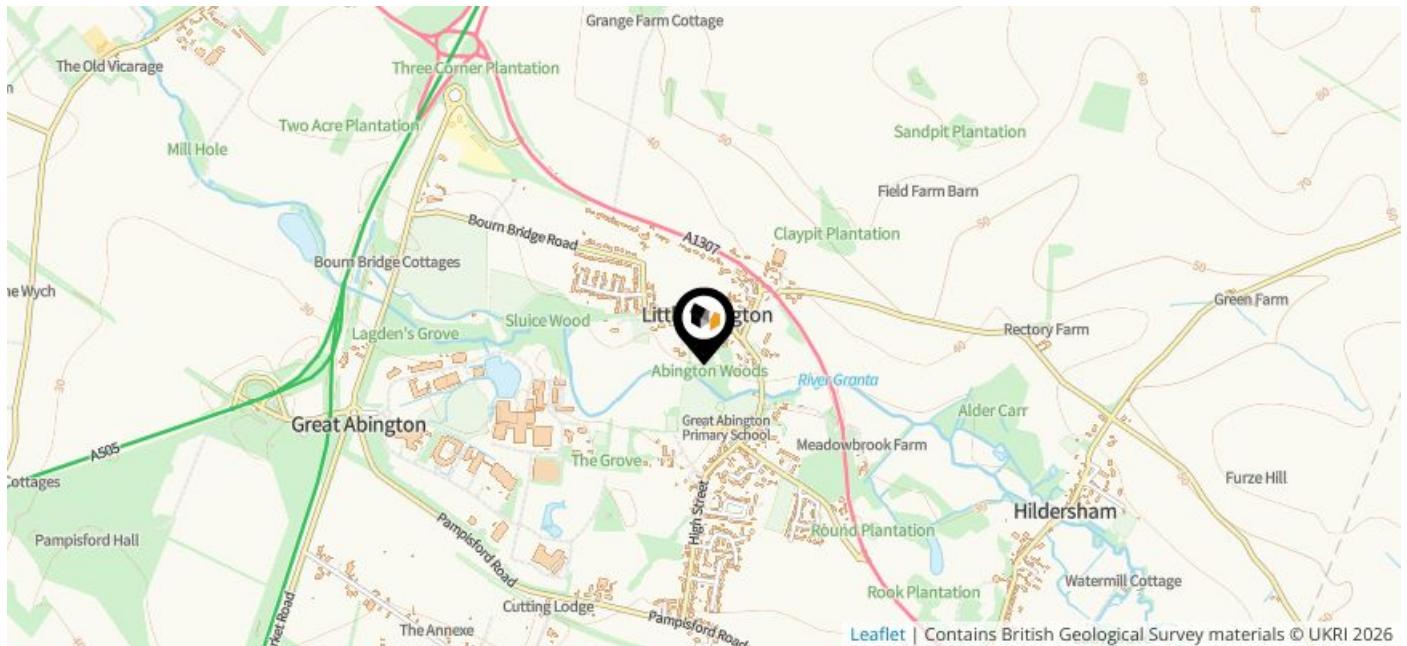

Mine Entry

- ✕ Adit
- ✕ Gutter Pit
- ✕ Shaft

The Coal Authority has records of over 175,000 mine entries within the UK captured in the National Coal Mining database, derived from sources including abandonment plans, geological and topographical plans.

Coal mining activity is recorded as far back as the 13th century, but prior to 1872 there was no requirement to deposit abandonment plans. It is therefore believed there may be many unrecorded mine entries of which the Authority has no information or knowledge. These entries do not, therefore, appear within the Authority's national dataset as shown on this map.

The UK is divided into wards that are used for local elections to elect local government councillors. Sometimes these are known as 'electoral divisions'. Population counts can vary substantially between wards, but the national average is about 5,500

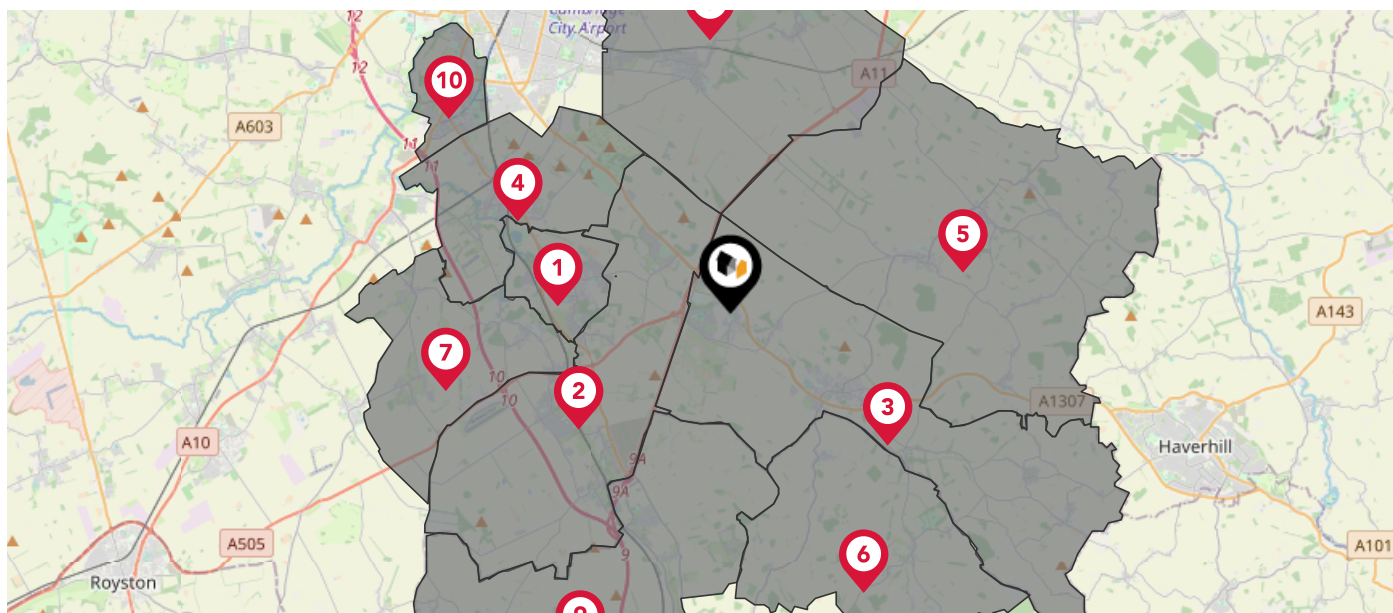

Nearby Council Wards

1

Sawston Ward

2

Duxford Ward

3

Linton Ward

4

Shelford Ward

5

Balsham Ward

6

Ashdon Ward

7

Whittlesford Ward

8

Fen Ditton & Fulbourn Ward

9

Littlebury, Chesterford & Wenden Lofts Ward

10

Trumpington Ward

What is Radon?

Radon is a natural radioactive gas, which enters buildings from the ground. Exposure to high concentrations increases the risk of lung cancer. The UK Health Security Agency (UKHSA) recommends that radon levels should be reduced in homes where the annual average is at or above 200 becquerels per cubic metre (200 Bq/m³).

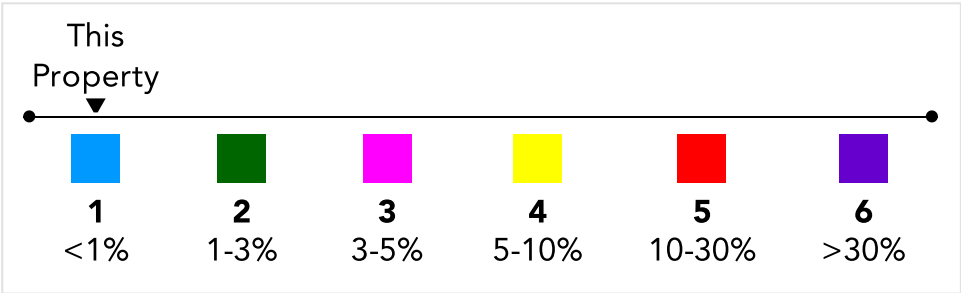
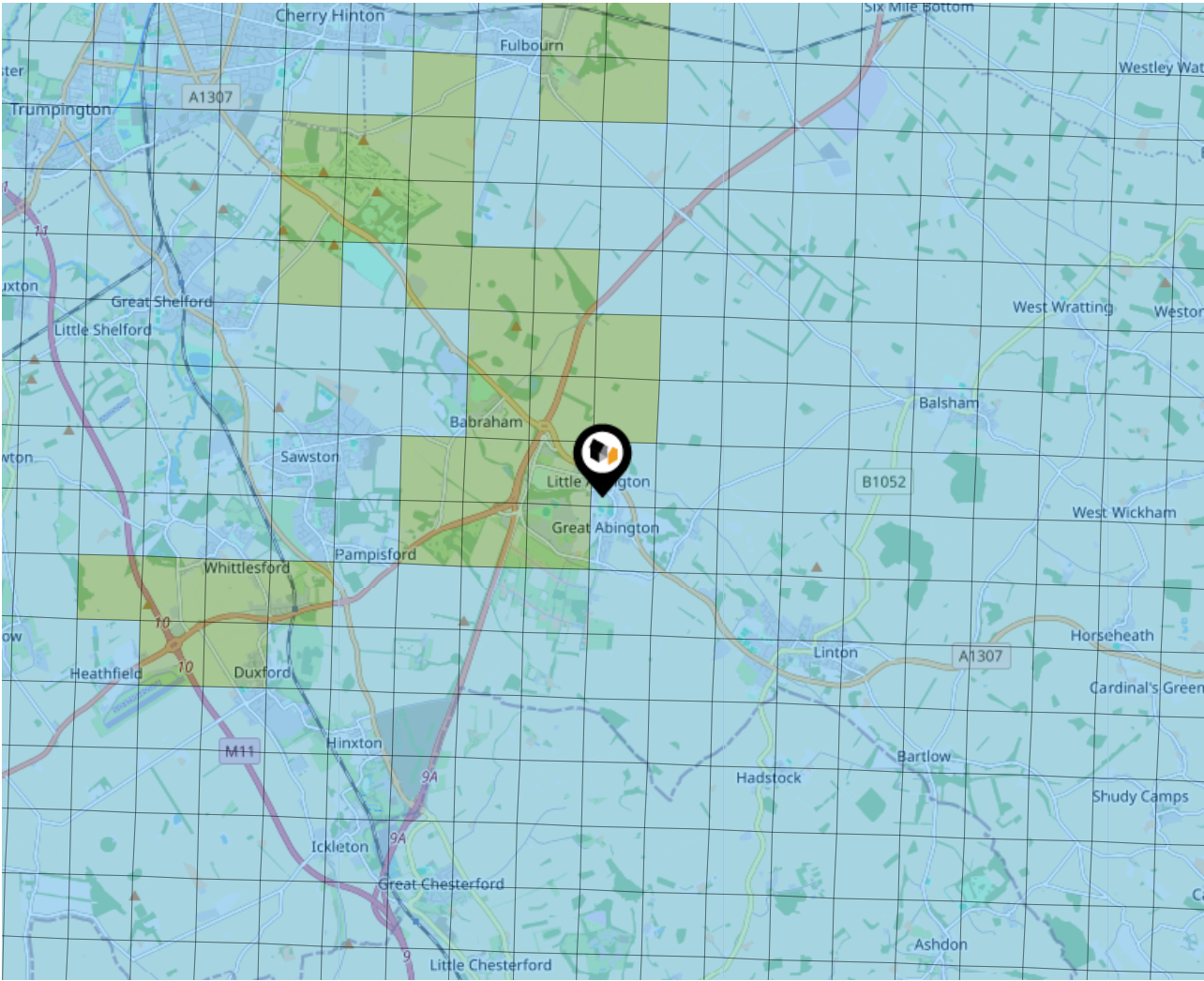

Ground Composition for this Address (Surrounding square kilometer zone around property)

Carbon Content:	HIGH	Soil Texture:	CHALKY CLAY TO CHALKY
Parent Material Grain:	ARGILLIC -		LOAM
	ARENACEOUS	Soil Depth:	INTERMEDIATE-SHALLOW
Soil Group:	MEDIUM TO LIGHT(SILTY) TO HEAVY		

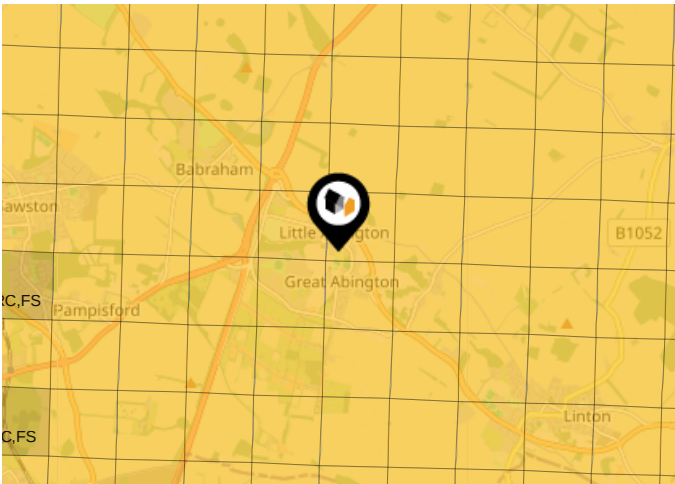



Primary Classifications (Most Common Clay Types)

C/M	Claystone / Mudstone
FPC,S	Floodplain Clay, Sand / Gravel
FC,S	Fluvial Clays & Silts
FC,S,G	Fluvial Clays, Silts, Sands & Gravel
PM/EC	Prequaternary Marine / Estuarine Clay / Silt
QM/EC	Quaternary Marine / Estuarine Clay / Silt
RC	Residual Clay
RC/LL	Residual Clay & Loamy Loess
RC,S	River Clay & Silt
RC,FS	Riverine Clay & Floodplain Sands and Gravel
RC,FL	Riverine Clay & Fluvial Sands and Gravel
TC	Terrace Clay
TC/LL	Terrace Clay & Loamy Loess

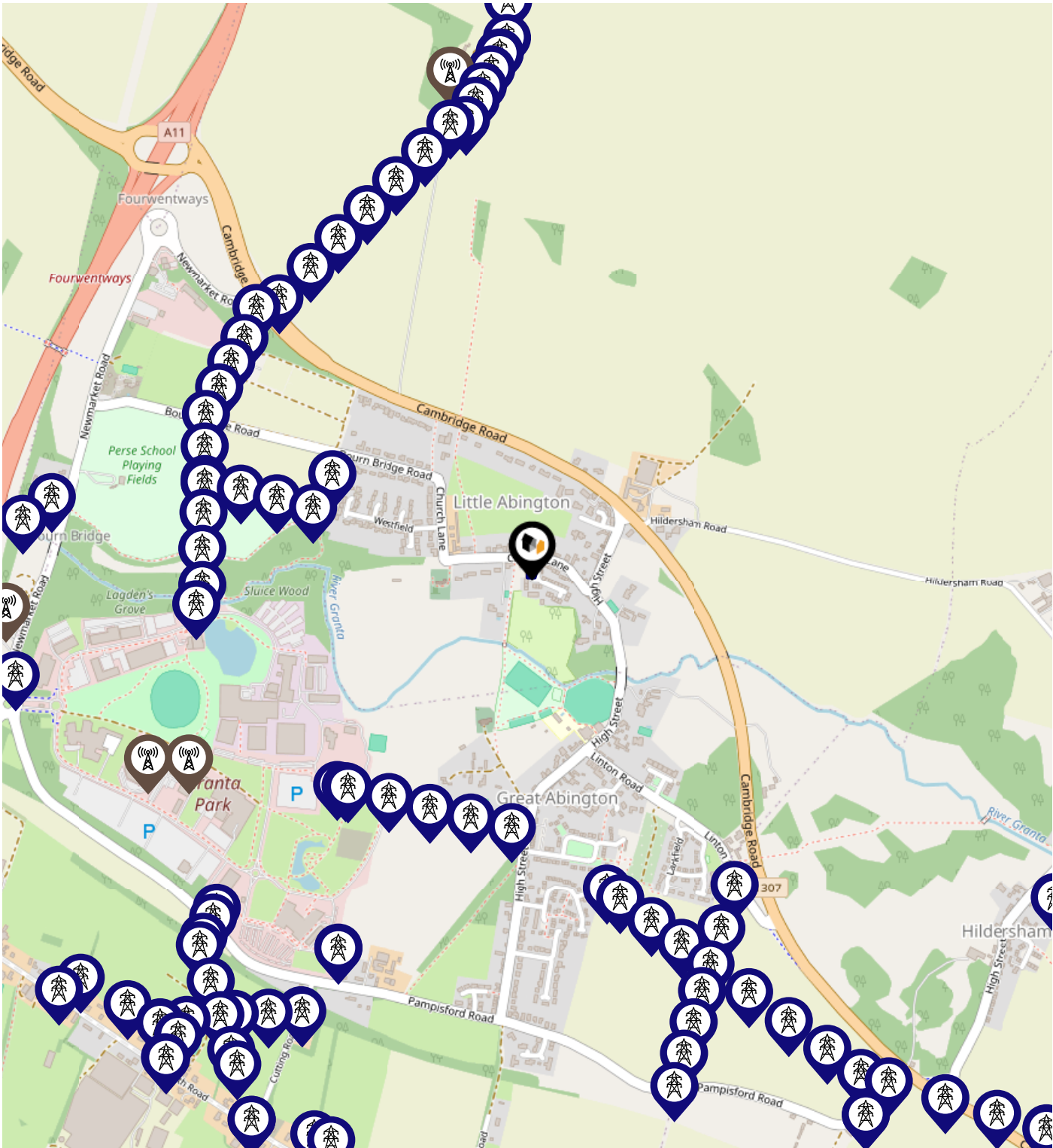
Local Area Masts & Pylons









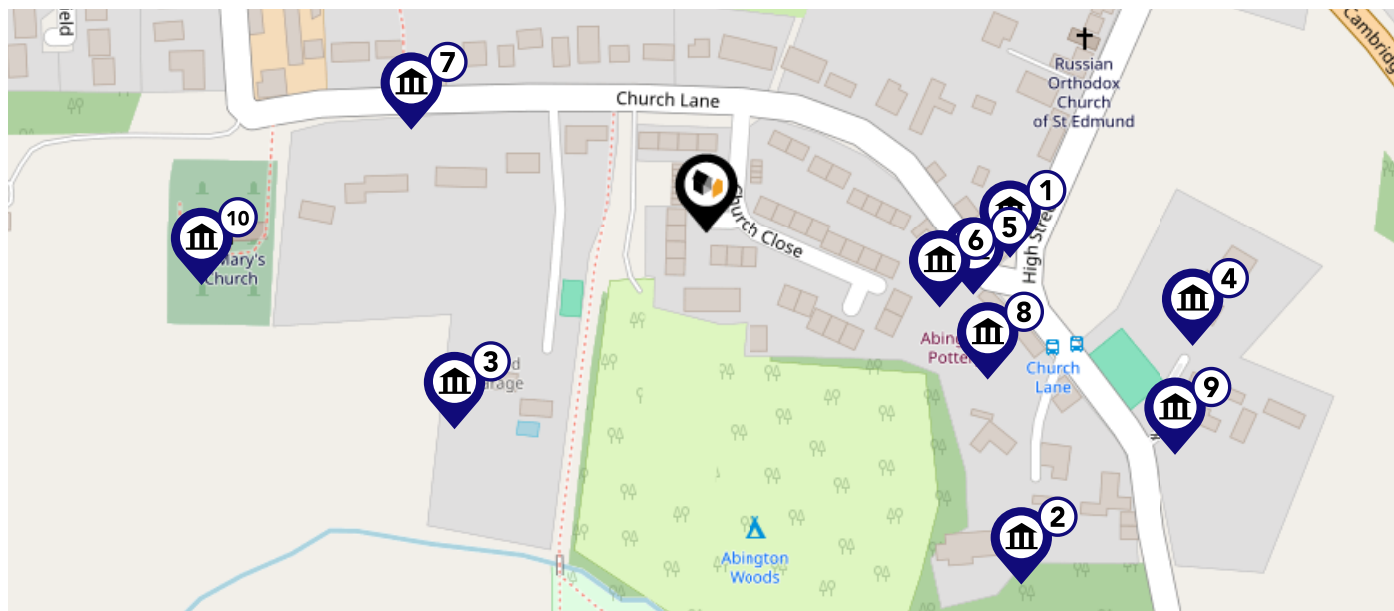



Key:

-  Power Pylons
-  Communication Masts

This map displays nearby listed buildings and protected structures, as well as their listed tier and distance from the target property...









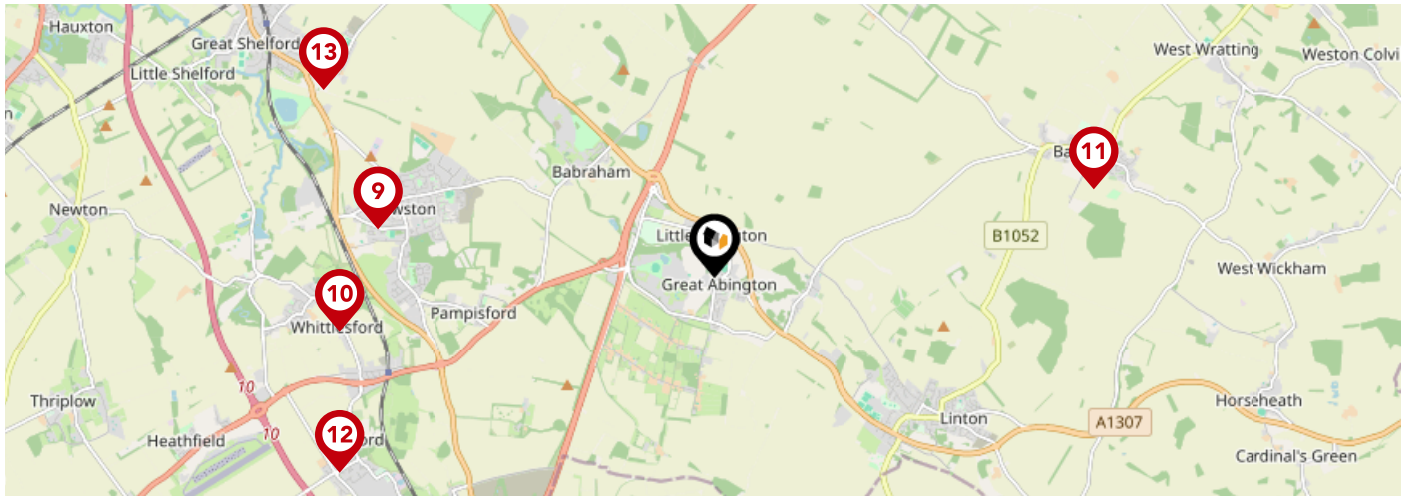

Listed Buildings in the local district		Grade	Distance
	1331187 - Princes Cottage	Grade II	0.1 miles
	1163185 - Damson Cottage	Grade II	0.1 miles
	1127655 - The Old Vicarage	Grade II	0.1 miles
	1127659 - 5, High Street	Grade II	0.1 miles
	1163158 - Jeremiahs Cottage	Grade II	0.1 miles
	1163116 - 1, Church Lane	Grade II	0.1 miles
	1309297 - Churchview	Grade II	0.1 miles
	1331188 - 28, 30 And 32, High Street	Grade II	0.1 miles
	1309285 - The Old House	Grade II	0.1 miles
	1309328 - Parish Church Of St Mary The Virgin	Grade II	0.1 miles



		Nursery	Primary	Secondary	College	Private
1	Great Abington Primary School Ofsted Rating: Good Pupils: 133 Distance:0.44	<input type="checkbox"/>	<input checked="" type="checkbox"/>	<input type="checkbox"/>	<input type="checkbox"/>	<input type="checkbox"/>
2	Babraham CofE (VC) Primary School Ofsted Rating: Outstanding Pupils: 91 Distance:1.36	<input type="checkbox"/>	<input checked="" type="checkbox"/>	<input type="checkbox"/>	<input type="checkbox"/>	<input type="checkbox"/>
3	Linton Village College Ofsted Rating: Good Pupils: 833 Distance:2.11	<input type="checkbox"/>	<input type="checkbox"/>	<input checked="" type="checkbox"/>	<input type="checkbox"/>	<input type="checkbox"/>
4	Granta School Ofsted Rating: Requires improvement Pupils: 175 Distance:2.27	<input type="checkbox"/>	<input type="checkbox"/>	<input checked="" type="checkbox"/>	<input type="checkbox"/>	<input type="checkbox"/>
5	The Icknield Primary School Ofsted Rating: Good Pupils: 200 Distance:2.38	<input type="checkbox"/>	<input checked="" type="checkbox"/>	<input type="checkbox"/>	<input type="checkbox"/>	<input type="checkbox"/>
6	Linton CofE Infant School Ofsted Rating: Good Pupils: 149 Distance:2.42	<input type="checkbox"/>	<input checked="" type="checkbox"/>	<input type="checkbox"/>	<input type="checkbox"/>	<input type="checkbox"/>
7	Linton Heights Junior School Ofsted Rating: Good Pupils: 249 Distance:2.73	<input type="checkbox"/>	<input checked="" type="checkbox"/>	<input type="checkbox"/>	<input type="checkbox"/>	<input type="checkbox"/>
8	The Bellbird Primary School Ofsted Rating: Good Pupils: 415 Distance:2.8	<input type="checkbox"/>	<input checked="" type="checkbox"/>	<input type="checkbox"/>	<input type="checkbox"/>	<input type="checkbox"/>



		Nursery	Primary	Secondary	College	Private
	Sawston Village College Ofsted Rating: Good Pupils: 1162 Distance:3.1	<input type="checkbox"/>	<input type="checkbox"/>	<input checked="" type="checkbox"/>	<input type="checkbox"/>	<input type="checkbox"/>
	William Westley Church of England VC Primary School Ofsted Rating: Good Pupils: 186 Distance:3.45	<input type="checkbox"/>	<input checked="" type="checkbox"/>	<input type="checkbox"/>	<input type="checkbox"/>	<input type="checkbox"/>
	Meadow Primary School Ofsted Rating: Good Pupils: 212 Distance:3.54	<input type="checkbox"/>	<input checked="" type="checkbox"/>	<input type="checkbox"/>	<input type="checkbox"/>	<input type="checkbox"/>
	Duxford Church of England Community Primary School Ofsted Rating: Good Pupils: 172 Distance:3.85	<input type="checkbox"/>	<input checked="" type="checkbox"/>	<input type="checkbox"/>	<input type="checkbox"/>	<input type="checkbox"/>
	Stapleford Community Primary School Ofsted Rating: Good Pupils: 215 Distance:3.94	<input type="checkbox"/>	<input checked="" type="checkbox"/>	<input type="checkbox"/>	<input type="checkbox"/>	<input type="checkbox"/>
	Great Chesterford Church of England Primary Academy Ofsted Rating: Good Pupils: 197 Distance:4.25	<input type="checkbox"/>	<input checked="" type="checkbox"/>	<input type="checkbox"/>	<input type="checkbox"/>	<input type="checkbox"/>
	Fulbourn Primary School Ofsted Rating: Good Pupils: 267 Distance:4.26	<input type="checkbox"/>	<input checked="" type="checkbox"/>	<input type="checkbox"/>	<input type="checkbox"/>	<input type="checkbox"/>
	Landmark International School Ofsted Rating: Good Pupils: 104 Distance:4.45	<input type="checkbox"/>	<input type="checkbox"/>	<input checked="" type="checkbox"/>	<input type="checkbox"/>	<input type="checkbox"/>

Area

Transport (National)

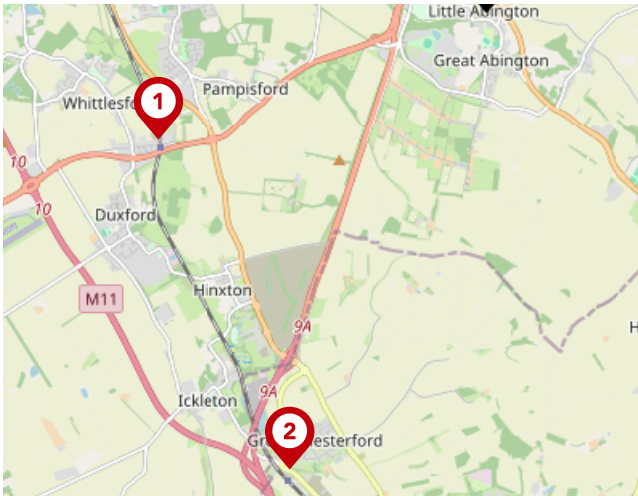



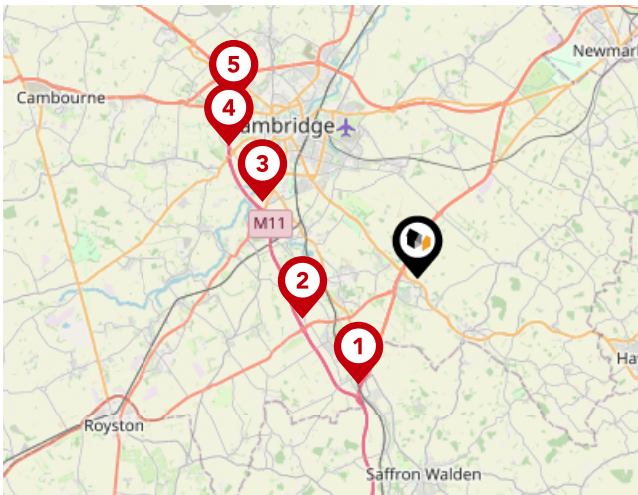

National Rail Stations

Pin	Name	Distance
	Whittlesford Parkway Rail Station	3.2 miles
	Great Chesterford Rail Station	4.53 miles
	Shelford (Cambs) Rail Station	4.54 miles





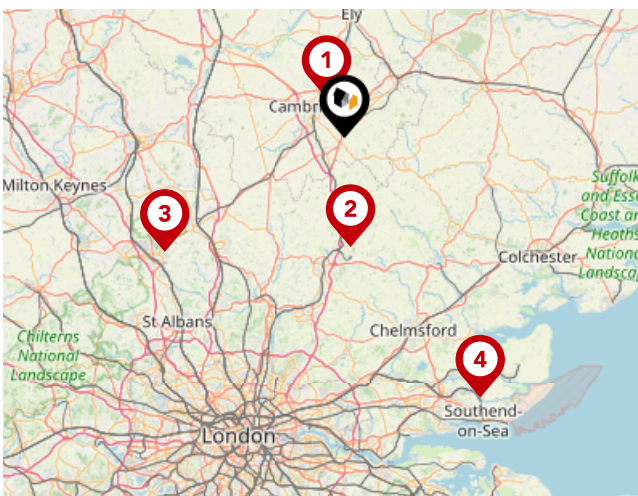

Trunk Roads/Motorways

Pin	Name	Distance
	M11 J9	4.41 miles
	M11 J10	4.42 miles
	M11 J11	6.28 miles
	M11 J12	8.37 miles
	M11 J13	9.25 miles



Airports/Helipads

Pin	Name	Distance
	Cambridge	6.47 miles
	Stansted Airport	15.91 miles
	Luton Airport	30.96 miles
	Southend-on-Sea	43.04 miles

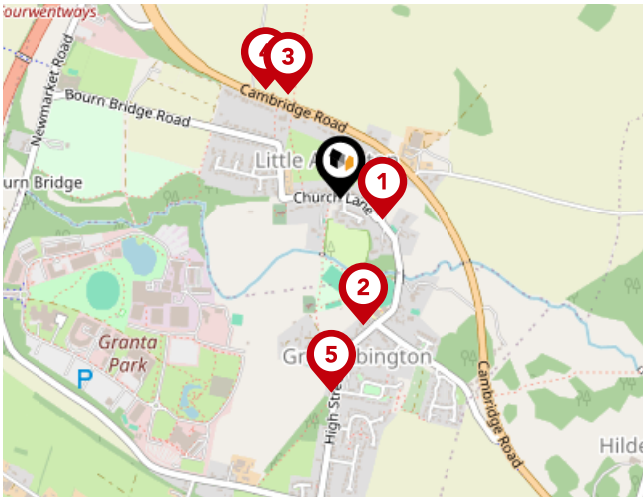

Bus Stops/Stations

Pin	Name	Distance
1	High Street	0.11 miles
2	Linton Road	0.29 miles
3	Cambridge Road	0.26 miles
4	Cambridge Road	0.3 miles
5	Magna Close	0.44 miles

Cooke Curtis & Co

Data Quality

We are committed to comprehensive property data being made available upfront to make the home buying and selling process quicker, easier and cheaper. This is why we have partnered with Sprift, the UK's leading supplier of property-specific data.



Contains public sector information licensed under the Open Government License v3.0

The information contained within this report is for general information purposes only.

Sprift Technologies Ltd aggregate this data from a wide variety of sources and while we endeavour to keep the information up to date and correct, we make no representations or warranties of any kind, express or implied, about the completeness, accuracy, reliability, of the information or related graphics contained within this report for any purpose.

Any reliance you place on such information is therefore strictly at your own risk. In no event will we be liable for any loss or damage including without limitation, indirect or consequential loss or damage, or any loss or damage whatsoever arising from loss of data or profits arising out of, or in connection with, the use of this report.



Cooke Curtis & Co

40 High Street Trumpington Cambridge

CB2 9LS

01223 508 050

jessica@cookecurtis.co.uk

www.cookecurtis.co.uk

