



Cottongrass Road, Harwell, Didcot

Oxfordshire

 **Hodsons**
...your move, our passion
Sales | Lettings

Cottongrass Road

Hodsons are delighted to offer to the market with no onward chain, this well-presented two-bedroom home which is located on the highly sought-after Great Western Park development.

The ground floor features an entrance hall, cloakroom, a modern kitchen with integrated appliances, and a spacious lounge/dining area with an understairs storage cupboard and French doors opening onto the rear garden.

Upstairs, the property offers two double bedrooms, including a principal bedroom with built-in wardrobes, along with a contemporary family bathroom. Additional benefits include allocated driveway parking plus a visitor space, gas central heating, UPVC double glazing, and a private, enclosed south-facing rear garden. Both bedrooms are also equipped with air-conditioning units—an excellent bonus for year-round comfort. With its desirable location and excellent presentation, this property is well worth viewing.

Great Western Park offers modern living in a thoughtfully arranged, community-centred environment. With excellent transport, good schools, ample leisure spaces, and on-site services, it suits families, professionals, and commuters looking for a self-sufficient yet well-connected neighbourhood. A compelling choice for anyone drawn to a fresh, inclusive place—including those who love new-build homes, open space, and easy access to London and Oxford.





Cottongrass Road

Harwell, Didcot

- Two bedroom end terrace house situated on Cottongrass Road, Didcot
- Coming to market with a closed chain
- Kitchen has integrated appliance and good storage
- Spacious lounge with generous storage cupboard and French doors leading out into the garden
- Generous main bedroom with fitted wardrobes
- Second double bedroom
- Modern family bathroom with shower over the bath
- One allocated parking space and visitors parking available







Cottongrass Road, OX11

Approximate Gross Internal Area = 62.50 sq m / 673 sq ft

For identification only - Not to scale

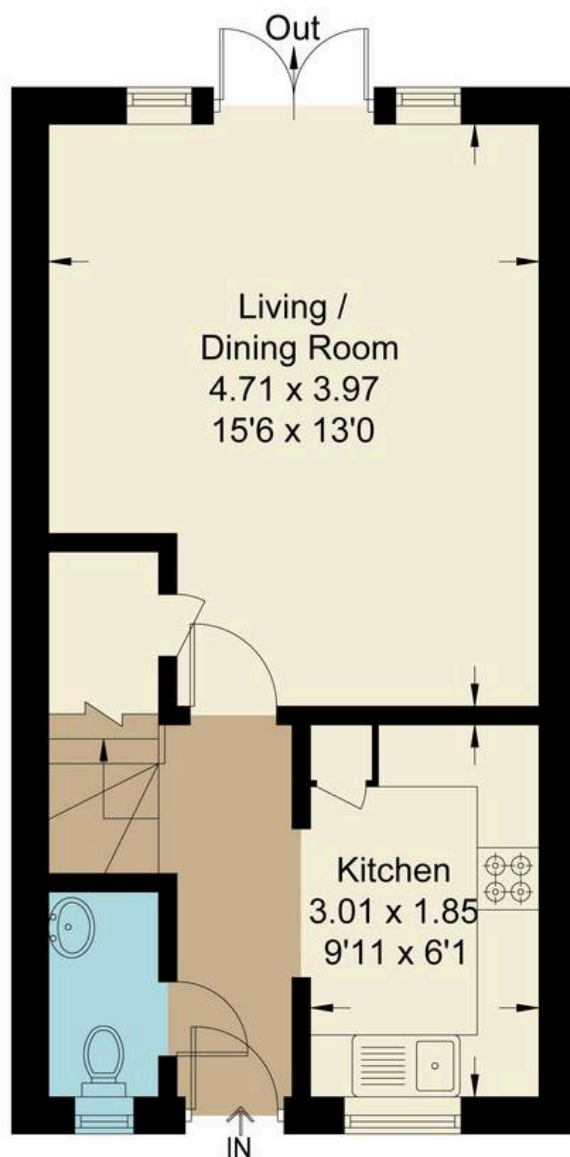

Ground Floor

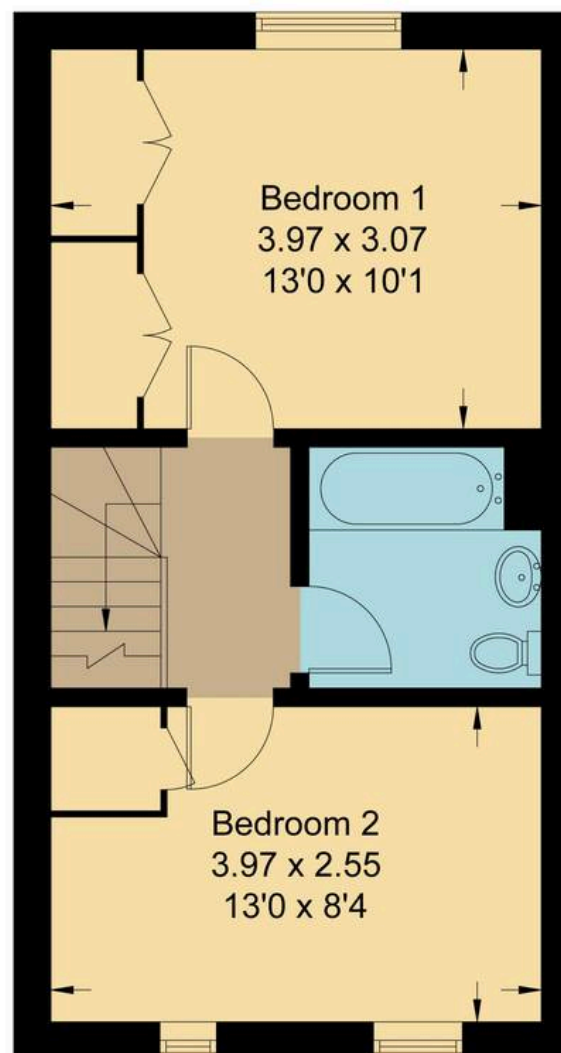

First Floor

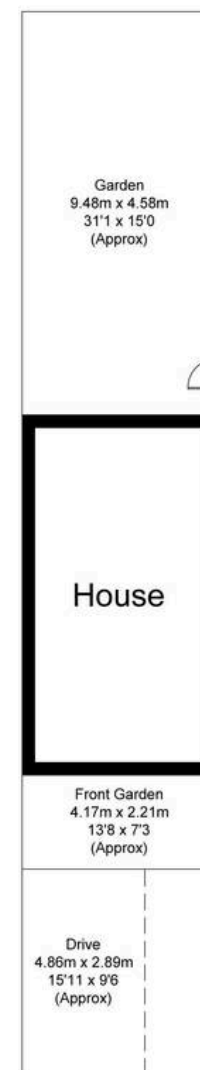

Not to scale, for illustration and layout purposes only.
© Mortimer Photography. Produced for Hodsons.
Unauthorised reproduction prohibited



Hodsons
...your move, our passion
Sales | Lettings

220 Broadway, Didcot
Oxfordshire, OX11 8RS
T: 01235 511406
E: didcot@hodsons.co.uk
www.hodsons.co.uk