



25 Poplar Road
Bridgwater, Somerset, TA6 4UH

Brightestmove

Brightest move

£250,000



Brightestmove are pleased to offer for sale this superbly presented three-bedroom semi-detached home, pleasantly positioned on the popular Polden Meadows development on the eastern side of Bridgwater. Beautifully maintained and tastefully styled throughout, the property enjoys an abundance of natural light and modern fittings, creating a warm and inviting atmosphere. The current owners have taken great care to ensure the home is presented to an exceptional standard. Outside, the property benefits from off-road parking and a garage equipped with light, power and plumbing, offering additional practicality and potential. The enclosed rear garden provides a private and secure space. The accommodation briefly comprises an entrance hall, a comfortable living room, a well-appointed kitchen, and a separate dining room on the ground floor. To the first floor are three bedrooms, including two generous doubles, along with a stylish family shower room. An early internal inspection is highly recommended to fully appreciate the quality and charm this delightful home has to offer.



Bridgwater is an emerging town situated in the heart of the borough of Sedgemoor and within 11 miles of Taunton and 38 miles of Bristol. The town which is famed for its annual carnival is a thriving place with many new jobs being created in recent years.

SERVICES: Mains electricity, water and drainage

HEATING: Electric Storage Heating

TENURE: Freehold

COUNCIL TAX BAND: B

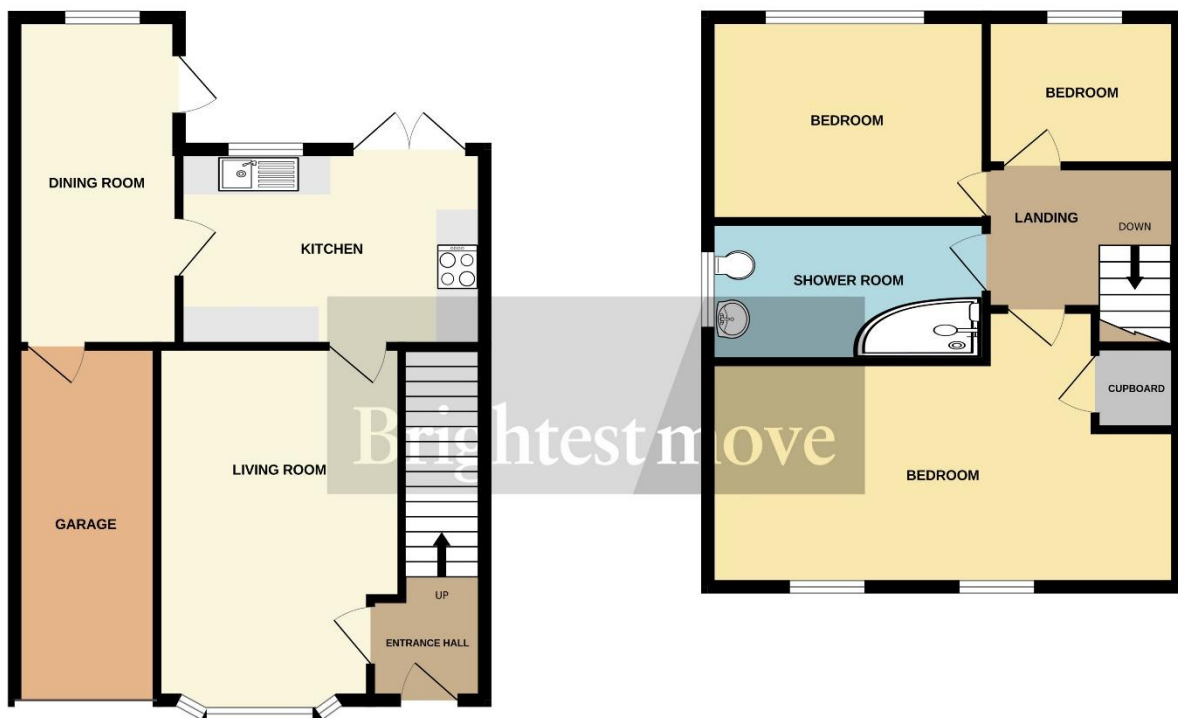

Living Room 15' 07" x 10' 05" (4.75m x 3.18m)

Kitchen 13' 06" x 8' 08" (4.11m x 2.64m)

Dining Room 14' 06" x 7' 03" (4.42m x 2.21m)

Bedroom One 12' 09" x 8' 04" (3.89m x 2.54m)

Bedroom Two 10' 05" x 7' 05" (3.18m x 2.26m)

Bedroom Three 7' 06" x 5' 09" (2.29m x 1.75m)

EPC - TBA

No statement in these details is to be relied upon as representation of fact, and purchasers should satisfy themselves by inspection or otherwise as to the accuracy of the statements contained within. These details do not constitute any part of any offer or contract. CMH Southwest limited trading as Brightest Move and their employees and agents do not have any authority to give warranty or representation whatsoever in respect of this property. These details and all statements herein are provided without any responsibility on the part of CMH Southwest limited trading as Brightest Move or the vendors. CMH Southwest limited trading as Brightest Move has not tested the equipment or central heating system mentioned in these particulars and the purchasers are advised to satisfy themselves as to the working order and condition. Measurements: Great care is taken when measuring, but measurements should not be relied upon for ordering carpets, equipment, etc. This property sheet forms part of our database, and is protected by the database right and copyright laws. No unauthorised copying or distribution without permission.

28 High Street, Bridgwater, Somerset TA6 3BJ

Tel: 01278 420444

bridgwater@brightestmove.co.uk

www.brightestmove.co.uk

Brightest move