



High Street, London NW10

£375,000 Leasehold

Ideally positioned in a highly convenient location, this recently renovated three-bedroom apartment offers generous living space, modern comfort, and exceptional versatility-perfect for both first-time buyers and investors alike.

The property boasts a spacious and well-designed layout, presented in great condition throughout. A real highlight is the private, spacious garden, providing a rare and valuable outdoor retreat, ideal for relaxing, entertaining, or enjoying family life. The added benefit of its own private entrance enhances both privacy and practicality, giving the home a true house-like feel.

- **Ideally located**
- **Spacious**
- **Three Bedrooms**
- **Low Service Charge**
- **Ideal for both first time buyers and Landlords/investors**
- **Private spacious garden**
- **Own Entrance**
- **Great Transport links**
- **Recently renovated**
- **Great condition**

Ground Floor

Approx. 60.3 sq. metres (649.5 sq. feet)

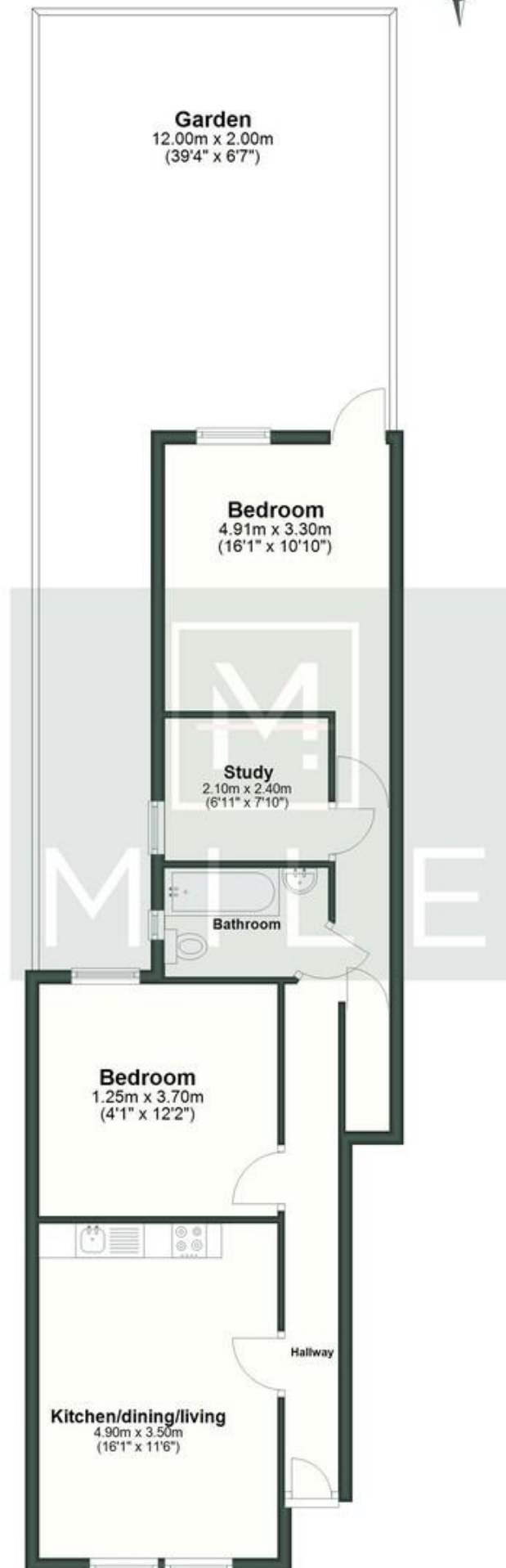

MONEY LAUNDERING REGULATIONS 2003: Intending purchasers will be asked to produce identification documentation at a later stage and we would ask for your co-operation in order that there will be no delay in agreeing the sale.

General: While we endeavour to make our sales particulars fair, accurate and reliable, they are only a general guide to the property and, accordingly, if there is any point which is of particular importance to you, please contact the office and we will be pleased to check the position for you, especially if you are contemplating travelling some distance to view the property.

Measurements: These approximate room sizes are only intended as general guidance. You must verify the dimensions carefully before ordering carpets or any built-in furniture.

Services: Please note we have not tested the services or any of the equipment or appliances in this property, accordingly we strongly advise prospective buyers to commission their own survey or service reports before finalising their offer to purchase.