

Jasper Wharf

Floorplans

Jasper Wharf

Jasper Wharf is the jewel in the crown of our award-winning Abbey Quay development in Barking. The spectacular Jasper Wharf building has 29 storeys and really offers that something extra, with exceptional views of London, Canary Wharf and the River Roding. As you step inside your apartment in Jasper Wharf, you'll find spacious, contemporary interiors with a designer kitchen and bespoke bathrooms, complete with built-in Smart technology – all included at no extra cost. One and two bedroom apartments are available in this impressive building, the majority with their own private balcony or terrace.

Where the
river meets
the sky





The O2

Canary Wharf

The Shard

The City

Liverpool Street

Jasper Wharf

Queen Elizabeth Olympic Park
Westfield Stratford

Development Layout

Life on the river starts here

From the striking silhouette of Jasper Wharf, to the tranquil podium gardens, Abbey Quay brings together beautiful homes and exceptional amenities in a riverside setting.

- 1 Jasper Wharf
- 2 Residents' Hub & Concierge
- 3 Community Hub
- 4 Loxford Plaza & Proposed Restaurant/Café
- 5 Makers Yard
- 6 Abbey Green Walk
- 7 Abbey Road
- 8 River Roding
- 9 Gym*
- 10 Supermarket



Jasper Wharf

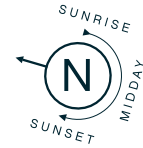

Key

Discount Market Sale Apartments
■ 2 Bedroom Apartments

Full Market Value Apartments
 1 Bedroom Apartments
 2 Bedroom Apartments

■ ■ Inset Balconies

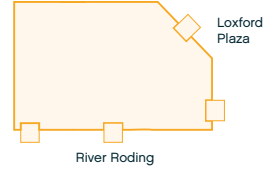

Floor 02

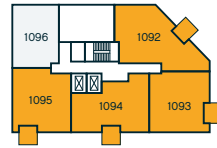

Floor 03

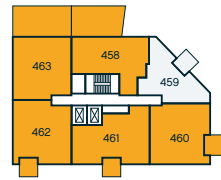

Floor 04

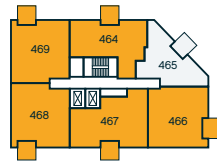

Floor 05

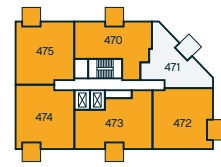

Floor 06

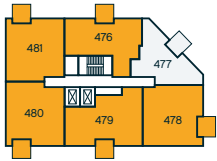

Floor 07

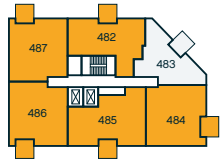

Floor 08

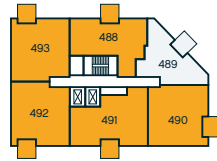

Floor 09

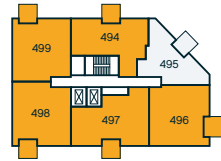

Floor 10

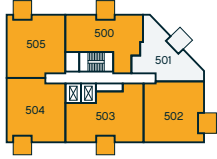

Floor 11

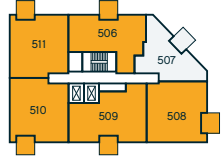

Floor 12

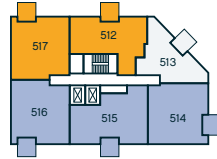

Floor 13

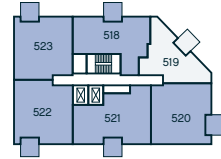

Floor 14

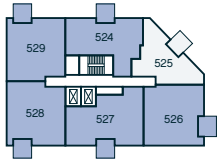

Floor 15

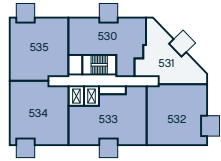

Floor 16

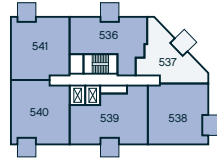

Floor 17

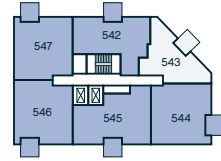

Floor 18

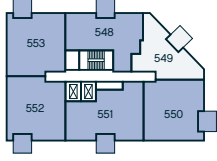

Floor 19

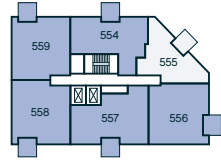

Floor 20

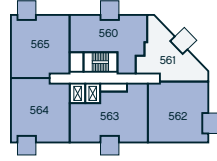

Floor 21

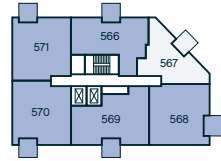

Floor 22

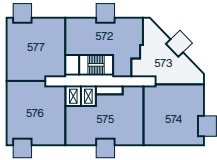

Floor 23

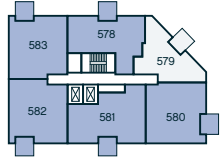

Floor 24

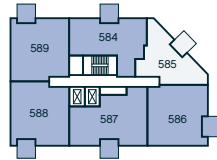

Floor 25

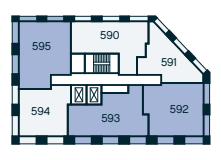

Floor 26

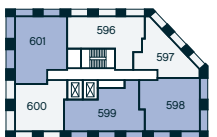

Floor 27

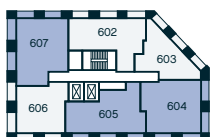

Floor 28

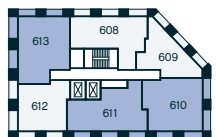

Floor 29



Accommodation Finder

Apartment No.	Floor	Bedrooms	Page No.
458	3	2	22
459	3	1	13
460	3	2	24
461	3	2	28
462	3	2	26
463	3	2	30
464	4	2	19
465	4	1	13
466	4	2	24
467	4	2	28
468	4	2	26
469	4	2	27
470	5	2	19
471	5	1	13
472	5	2	24
473	5	2	28
474	5	2	26
475	5	2	27
476	6	2	19
477	6	1	13
478	6	2	24
479	6	2	28
480	6	2	26
481	6	2	27
482	7	2	19
483	7	1	13
484	7	2	24
485	7	2	28
486	7	2	26
487	7	2	27
488	8	2	19
489	8	1	13
490	8	2	24
491	8	2	28
492	8	2	26
493	8	2	27
494	9	2	19
495	9	1	13
496	9	2	24
497	9	2	28
498	9	2	26
499	9	2	27
500	10	2	19
501	10	1	13
502	10	2	24
503	10	2	28
504	10	2	26
505	10	2	27
506	11	2	19
507	11	1	13
508	11	2	24
509	11	2	28
510	11	2	26
511	11	2	27
512	12	2	19
513	12	1	13
514	12	2	24
515	12	2	28

Apartment No.	Floor	Bedrooms	Page No.
516	12	2	26
517	12	2	27
518	13	2	19
519	13	1	13
520	13	2	24
521	13	2	28
522	13	2	26
523	13	2	27
524	14	2	19
525	14	1	13
526	14	2	24
527	14	2	28
528	14	2	26
529	14	2	27
530	15	2	19
531	15	1	13
532	15	2	24
533	15	2	28
534	15	2	26
535	15	2	27
536	16	2	19
537	16	1	13
538	16	2	24
539	16	2	28
540	16	2	26
541	16	2	27
542	17	2	19
543	17	1	13
544	17	2	24
545	17	2	28
546	17	2	26
547	17	2	27
548	18	2	19
549	18	1	13
550	18	2	24
551	18	2	28
552	18	2	26
553	18	2	27
554	19	2	19
555	19	1	13
556	19	2	24
557	19	2	28
558	19	2	26
559	19	2	27
560	20	2	19
561	20	1	13
562	20	2	24
563	20	2	28
564	20	2	26
565	20	2	27
566	21	2	19
567	21	1	13
568	21	2	24
569	21	2	28
570	21	2	26
571	21	2	27
572	22	2	19
573	22	1	13

Apartment No.	Floor	Bedrooms	Page No.
574	22	2	24
575	22	2	28
576	22	2	26
577	22	2	27
578	23	2	19
579	23	1	13
580	23	2	24
581	23	2	28
582	23	2	26
583	23	2	27
584	24	2	19
585	24	1	13
586	24	2	24
587	24	2	28
588	24	2	26
589	24	2	27
590	25	1	14
591	25	1	12
592	25	2	20
593	25	2	21
594	25	1	18
595	25	2	23
596	26	1	14
597	26	1	12
598	26	2	20
599	26	2	21
600	26	1	18
601	26	2	23
602	27	1	14
603	27	1	12
604	27	2	20
605	27	2	21
606	27	1	18
607	27	2	23
608	28	1	14
609	28	1	12
610	28	2	20
611	28	2	21
612	28	1	18
613	28	2	23
614	29	1	14
615	29	1	12
616	29	2	20
617	29	2	21
618	29	1	18
619	29	2	23
1092	2	2	31
1093	2	2	24
1094	2	2	29
1095	2	2	25
1096	2	1	15

Discount Market Sale

Helping You Onto The Property Ladder

Elevate your life for less with Discount Market Sale (DMS). This fantastic home ownership product is designed to help eligible buyers step onto the property ladder whilst still owning 100% of their new home.

DMS allows you to purchase a new build property that is discounted by 20% of the full market value. Selected properties at Jasper Wharf are available with Discount Market Sale and Weston Homes' fully inclusive premium specification is included as standard. Buyers also have the opportunity to personalise their new home and select luxurious finishing touches.*

DMS is subject to eligibility criteria, terms and conditions. To find out more about this superb scheme and whether you are eligible, please speak to our Sales Consultants regarding your individual circumstances.

Advertised prices include the 20% saving.
*Subject to the stage of construction.



“

When I found the Discount Market Sale scheme I thought: Wow! With this we could afford one of the flats.

We needed three bedrooms and by saving £100,000 using the discount, we were able to buy. We went directly to the showroom and within five minutes we wanted one of the homes. We bought immediately. We love the flat and my wife is just incredibly happy. It is absolutely fantastic. ”

Alessandro
Happy Weston Homes buyer

1 Bedroom Apartment

Type 08

Total Area	44.2 SQM	476 SQFT
Kitchen / Living / Dining	4.75m x 6.98m	15' 7" x 22' 11"
Bedroom	3.18m x 4.07m	10' 5" x 13' 4"
Balconies (x3)	2.64m x 1.04m	8' 9" x 3' 5"

Full Market Value

591, 597, 603, 609 & 615

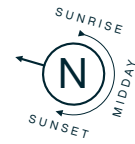

South & South East Elevation

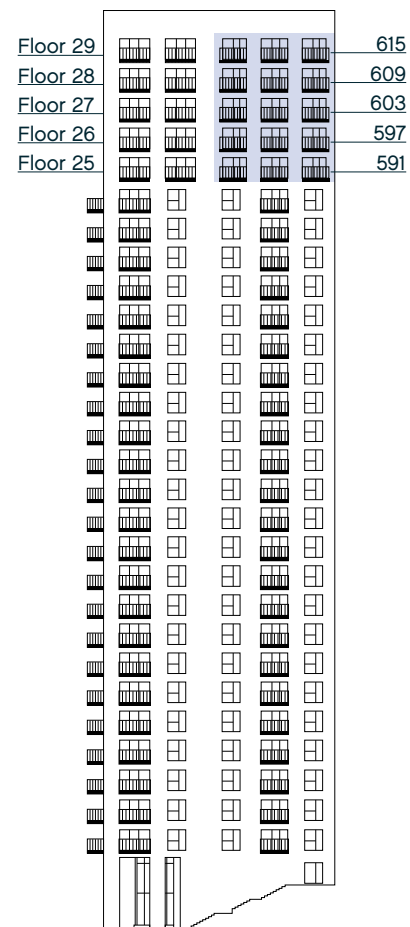

Floor 25 shown below

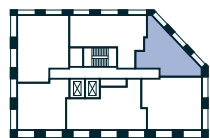

Key

- ↔ Measurement Points
- ← TV Aerial Point
- W Wardrobe
- C Cupboard

1 Bedroom Apartment

Type 02

Total Area	51.3 SQM	552 SQFT
Kitchen / Living / Dining	5.51m x 7.21m	18' 1" x 23' 6"
Bedroom	3.26m x 6.14m	10' 8" x 20' 11"
Balcony	2.62m x 2.71m	8' 7" x 8' 10"

Full Market Value

459, 465, 471, 477, 483, 489, 495, 501, 507, 513, 519, 525, 531, 537, 543, 549, 555, 561, 567, 573, 579 & 585

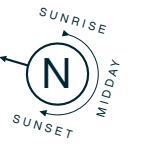

South & South East Elevation

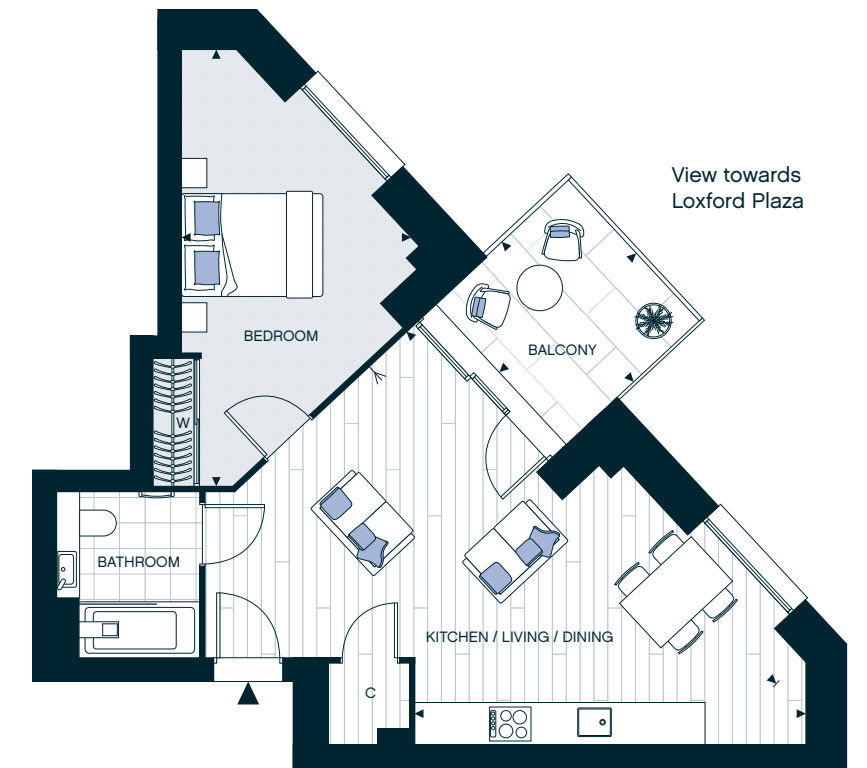
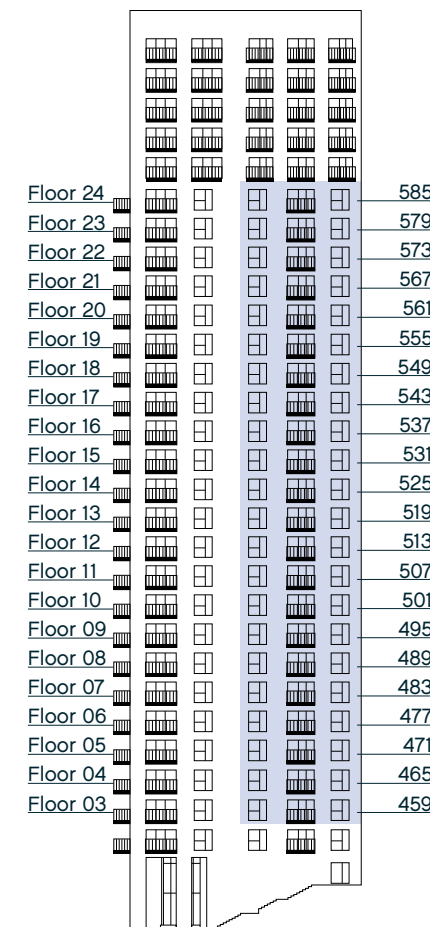

Floor 03 shown below

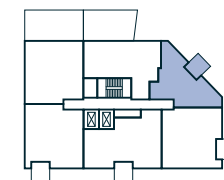

Key

- ↔ Measurement Points
- ← TV Aerial Point
- W Wardrobe
- C Cupboard

1 Bedroom Apartment

Type 07

Total Area	58.5 SQM	630 SQFT
Kitchen / Living / Dining	7.08m x 4.41m	23' 3" x 14' 6"
Bedroom	3.12m x 2.82m	10' 3" x 9' 3"
Balconies (x3)	2.67m x 1.04m	8' 9" x 3' 5"

Full Market Value

590, 596, 602, 608 & 614

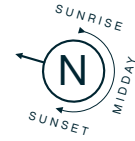

East Elevation

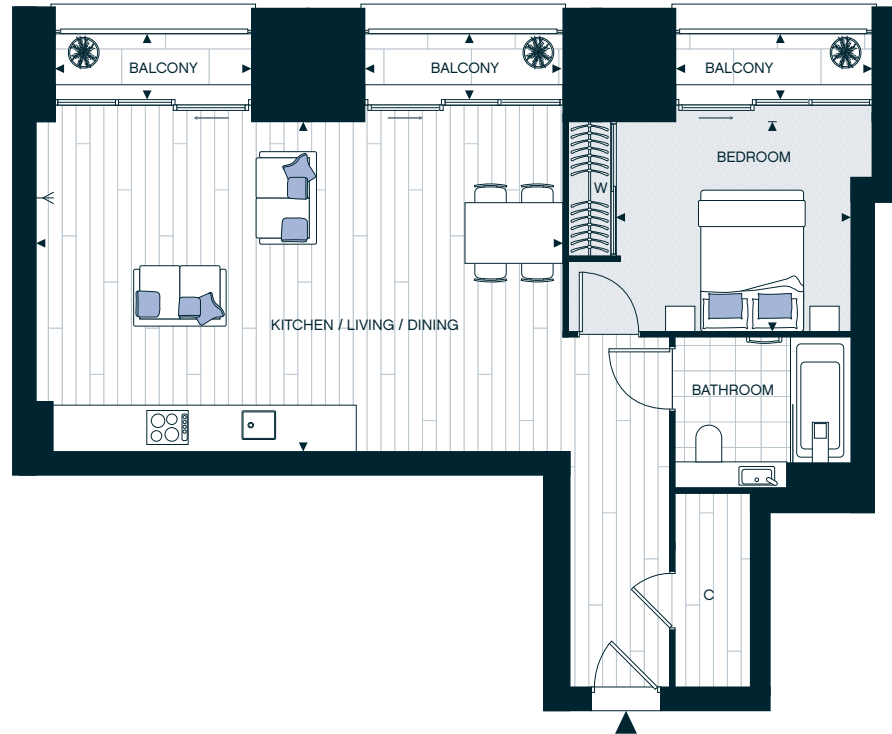
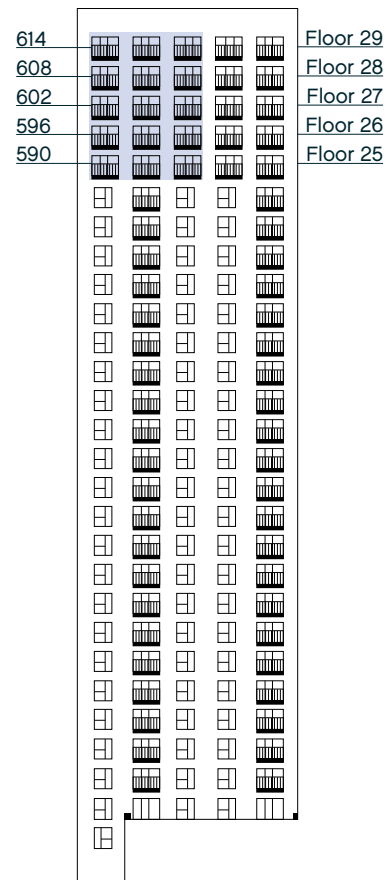

Floor 25 shown below

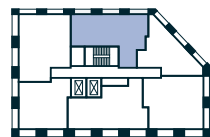

Key

- ↔ Measurement Points
- ← TV Aerial Point
- W Wardrobe
- C Cupboard

1 Bedroom Apartment

Type 13

Total Area	60.8 SQM	655 SQFT
Kitchen / Living / Dining	6.79m x 5.63m	22' 3" x 18' 6"
Bedroom	4.58m x 4.28m	15' 0" x 14' 0"

Full Market Value

1096

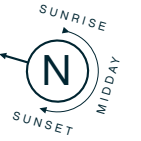

East Elevation

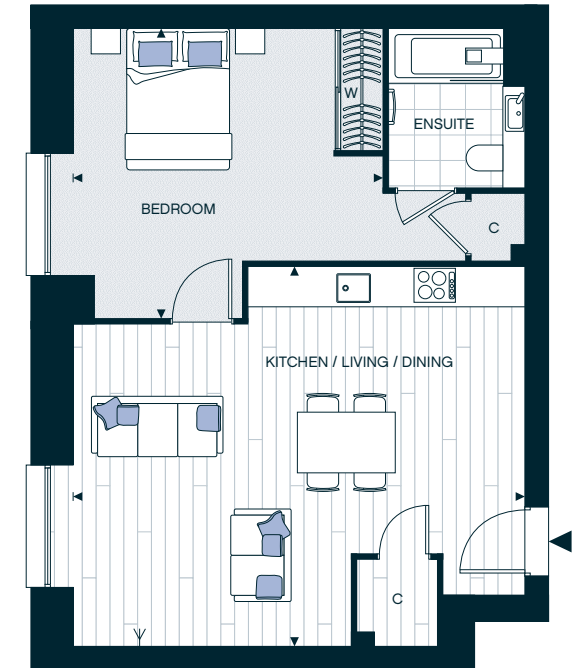
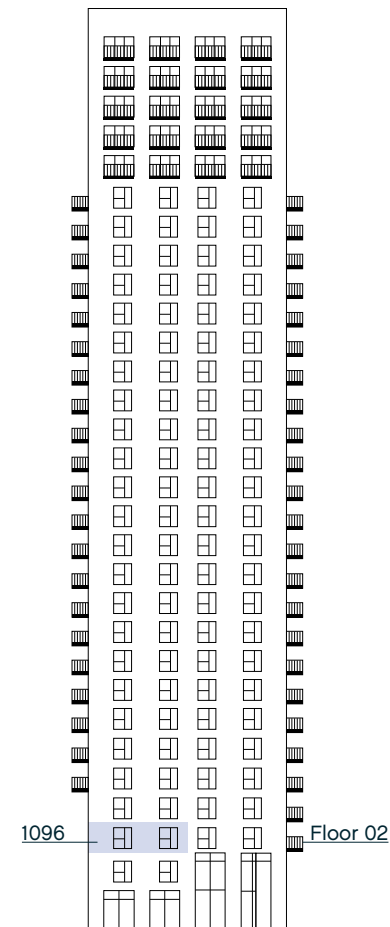

Floor 02 shown below

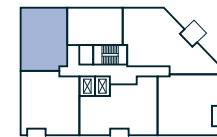

Key

- ↔ Measurement Points
- ← TV Aerial Point
- W Wardrobe
- C Cupboard

Panoramic views from Barking's premier address



1 Bedroom Apartment

Type 11

Full Market Value

594, 600, 606, 612 & 618

Total Area	53.2 SQM	573 SQFT
Kitchen / Living / Dining	3.33m x 6.79m	10' 11" x 22' 3"
Bedroom	3.75m x 2.76m	12' 4" x 9' 1"
Balcony 1 (x2)	3.01m x 1.04m	9' 10" x 3' 5"
Balcony 2 (x2)	2.67m x 1.04m	8' 9" x 3' 5"

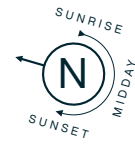

West Elevation

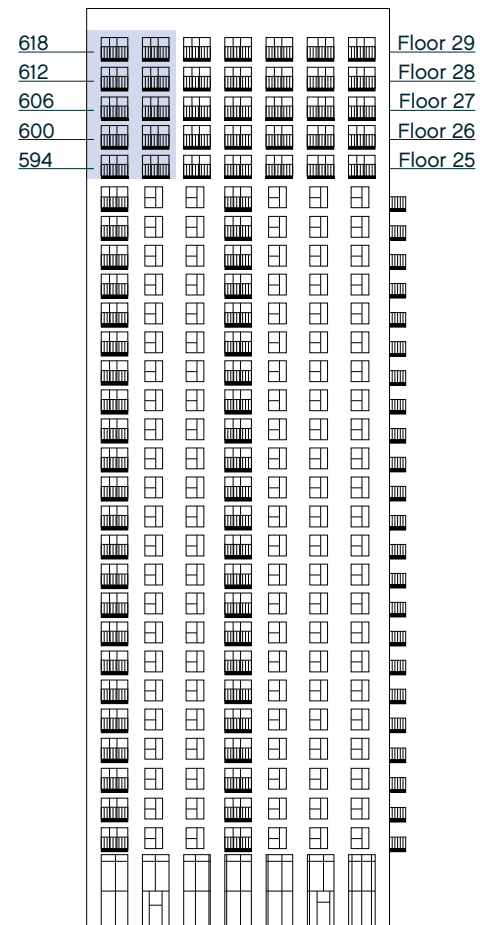

View towards London and the River Roding

Floor 25 shown below

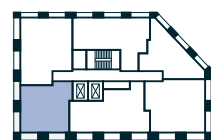

Key

- ▶ Measurement Points
- ← TV Aerial Point
- W Wardrobe
- C Cupboard

2 Bedroom Apartment

Type 15

Full Market Value

518, 524, 530, 536, 542, 548, 554, 560, 566, 572, 578 & 584

Discount Market Sale

464, 470, 476, 482, 488, 494, 500, 506, 512

Total Area	65.8 SQM	708 SQFT
Kitchen / Living / Dining	5.40m x 4.41m	17' 9" x 14' 6"
Bedroom 1	2.75m x 3.13m	9' 0" x 10' 3"
Bedroom 2	3.04m x 3.26m	10' 0" x 10' 8"
Balcony	2.62m x 2.21m	8' 7" x 8' 11"

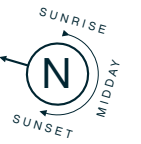

West Elevation

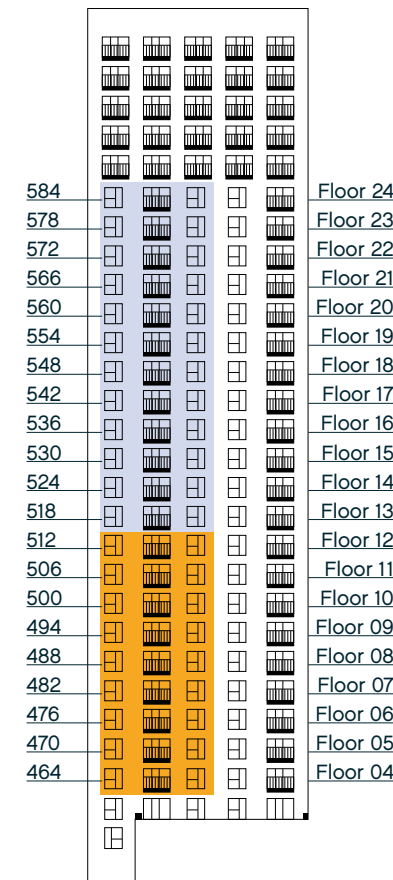

Floor 14 shown below

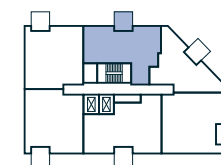

Key

- ▶ Measurement Points
- ← TV Aerial Point
- W Wardrobe
- C Cupboard
- SW Space for Wardrobe

2 Bedroom Apartment

Type 09

Full Market Value

592, 598, 604, 610 & 616

Total Area	65.9 SQM	709 SQFT
Kitchen / Living / Dining	4.30m x 4.81m	14' 2" x 15' 10"
Bedroom 1	3.17m x 2.75m	10' 5" x 9' 0"
Bedroom 2	2.97m x 3.06m	9' 9" x 10' 1"
Balcony 1 (x2)	3.01m x 1.04m	9' 10" x 3' 5"
Balcony 2 (x2)	2.67m x 1.04m	8' 9" x 3' 5"

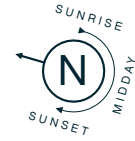

West Elevation

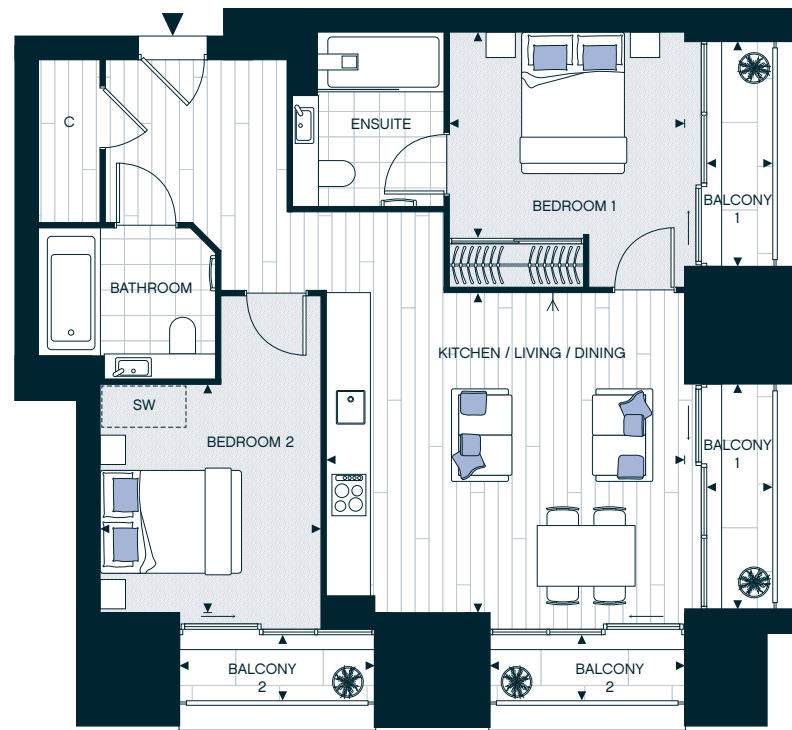
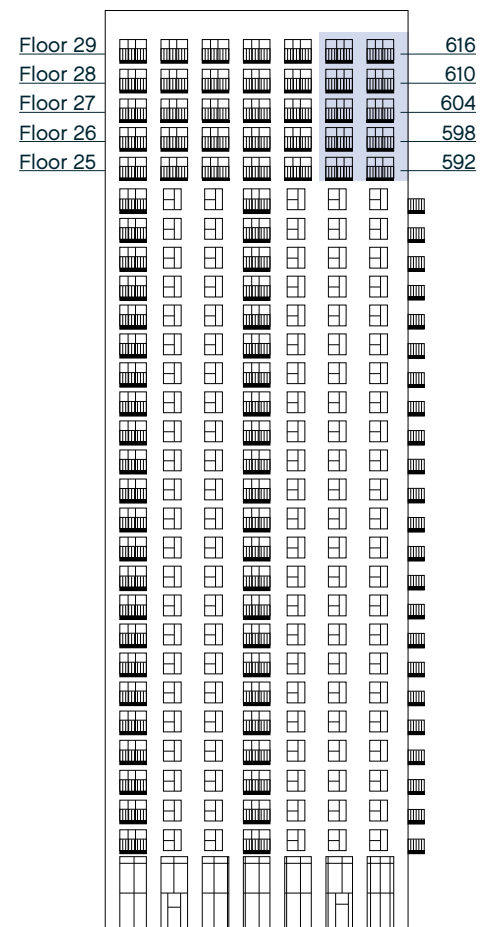

View towards London and the River Roding

Floor 25 shown below

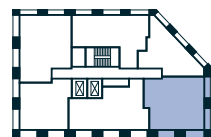

Key

- ▶ Measurement Points
- ← TV Aerial Point
- W Wardrobe
- C Cupboard
- SW Space for Wardrobe

2 Bedroom Apartment

Type 10

Full Market Value

593, 599, 605, 611 & 617

Total Area	66.4 SQM	715 SQFT
Kitchen / Living / Dining	4.06m x 6.27m	13' 4" x 20' 7"
Bedroom 1	4.31m x 2.36m	14' 2" x 7' 9"
Bedroom 1 Wardrobe	2.63m x 2.03m	8' 8" x 6' 8"
Bedroom 2	3.34m x 2.85m	10' 11" x 9' 4"
Balconies (x3)	2.67m x 1.04m	8' 9" x 3' 5"

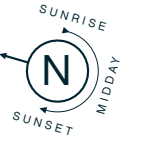

West Elevation

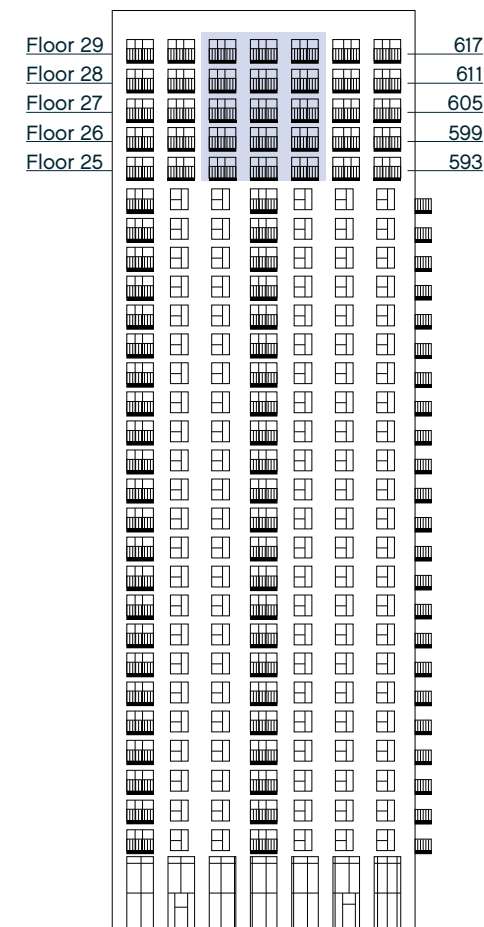

View towards London, the River Roding and Loxford Plaza

Floor 25 shown below

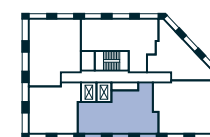

Key

- ▶ Measurement Points
- ← TV Aerial Point
- W Wardrobe
- C Cupboard
- SW Space for Wardrobe

2 Bedroom Apartment

Type 01

Discount Market Sale

458

Total Area	69.7 SQM	750 SQFT
Kitchen / Living / Dining	6.10m x 5.43m	20' 0" x 17' 10"
Bedroom 1	2.75m x 3.77m	9' 0" x 12' 4"
Bedroom 2	3.04m x 3.26m	10' 0" x 10' 8"
Terrace	7.59m x 4.03m	24' 10" x 13' 2"

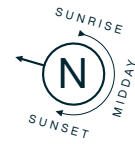

East Elevation

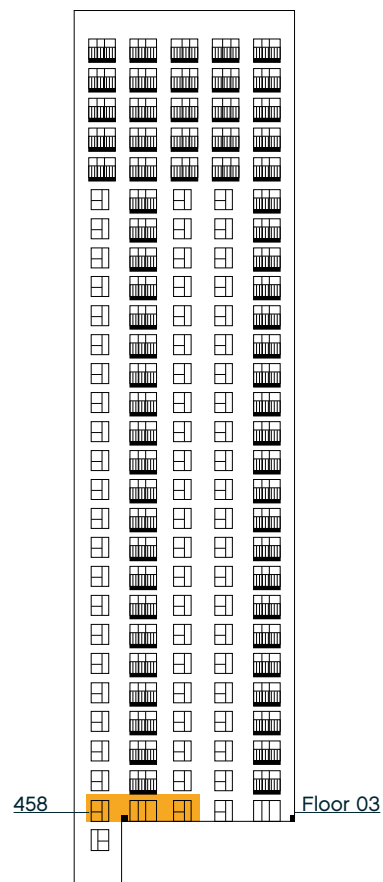

Floor 03 shown below

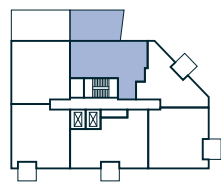

Key

- ▶ Measurement Points
- ◀ TV Aerial Point
- W Wardrobe
- C Cupboard
- SW Space for Wardrobe



2 Bedroom Apartment

Type 12

Full Market Value

595, 601, 607, 613 & 619

Total Area	70.2 SQM	756 SQFT
Kitchen / Living / Dining	7.66m x 5.24m	25' 2" x 17' 2"
Bedroom 1	2.70m x 4.44m	8' 11" x 14' 7"
Bedroom 2	2.77m x 4.77m	9' 1" x 15' 8"
Balcony 1 (x2)	3.01m x 1.04m	9' 10" x 3' 5"
Balcony 2 (x2)	2.67m x 1.04m	8' 9" x 3' 5"

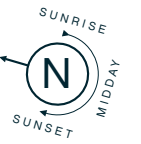

West Elevation

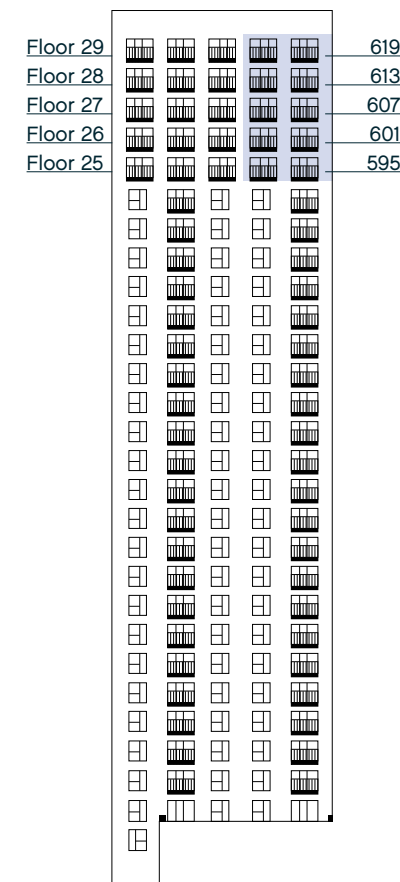

Floor 25 shown below

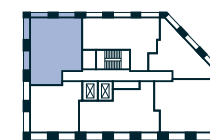

Key

- ▶ Measurement Points
- ◀ TV Aerial Point
- W Wardrobe
- C Cupboard
- SW Space for Wardrobe

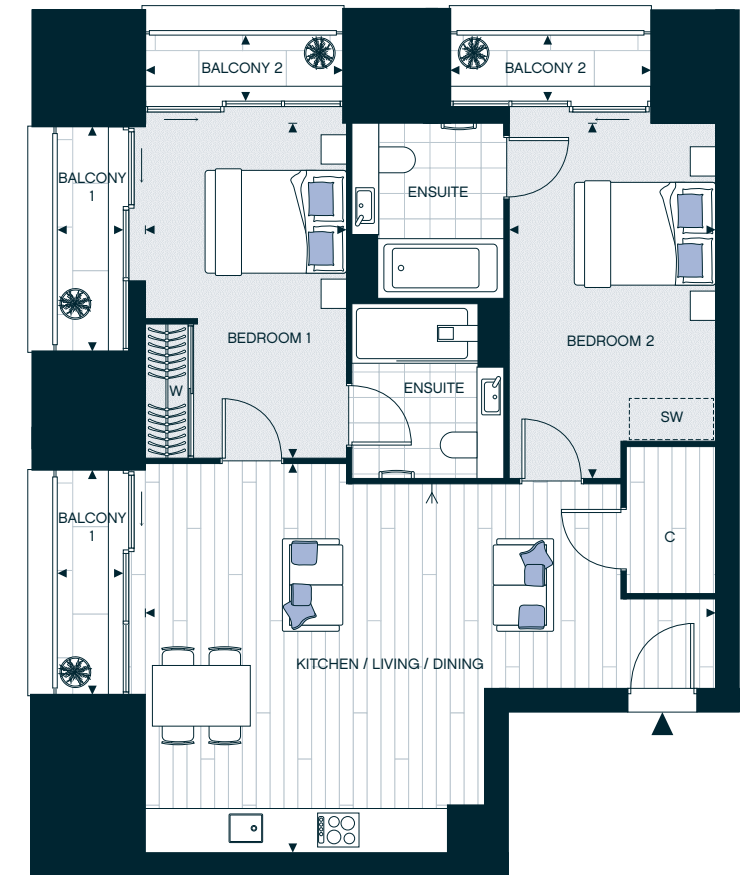

2 Bedroom Apartment

Type 03

Full Market Value

514, 520, 526, 532, 538, 544, 550, 556, 562, 568, 574, 580 & 586

Discount Market Sale

1093, 460, 466, 472, 478, 484, 490, 496, 502, 508

Total Area	72.4 SQM	779 SQFT
Kitchen / Living / Dining	4.56m x 5.34m	14' 11" x 17' 6"
Bedroom 1	3.11m x 3.74m	10' 2" x 12' 3"
Bedroom 2	3.15m x 3.34m	10' 4" x 10' 11"
Balcony	2.63m x 3.04m	8' 7" x 9' 11"

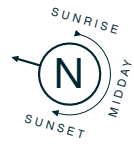

West Elevation

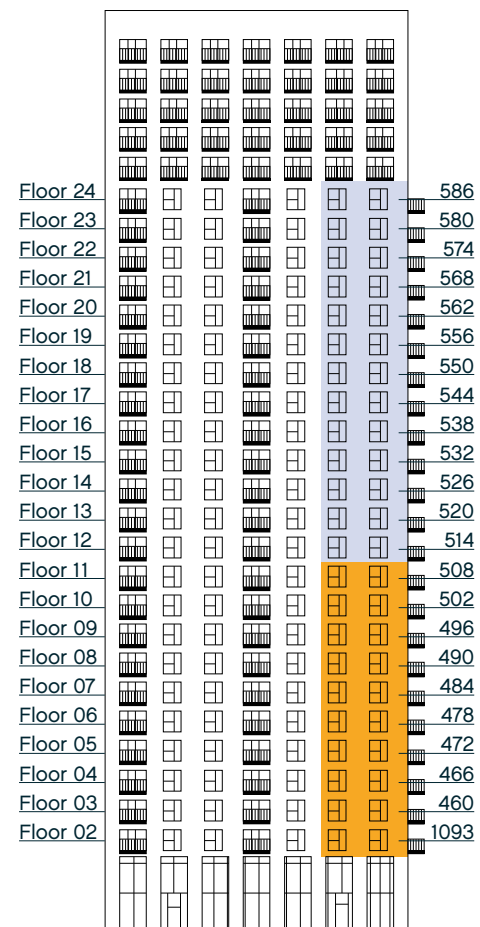

Floor 02 shown below

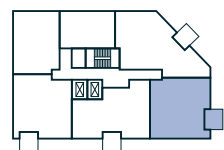

Key

- ▶ Measurement Points
- ← TV Aerial Point
- W Wardrobe
- C Cupboard
- SW Space for Wardrobe

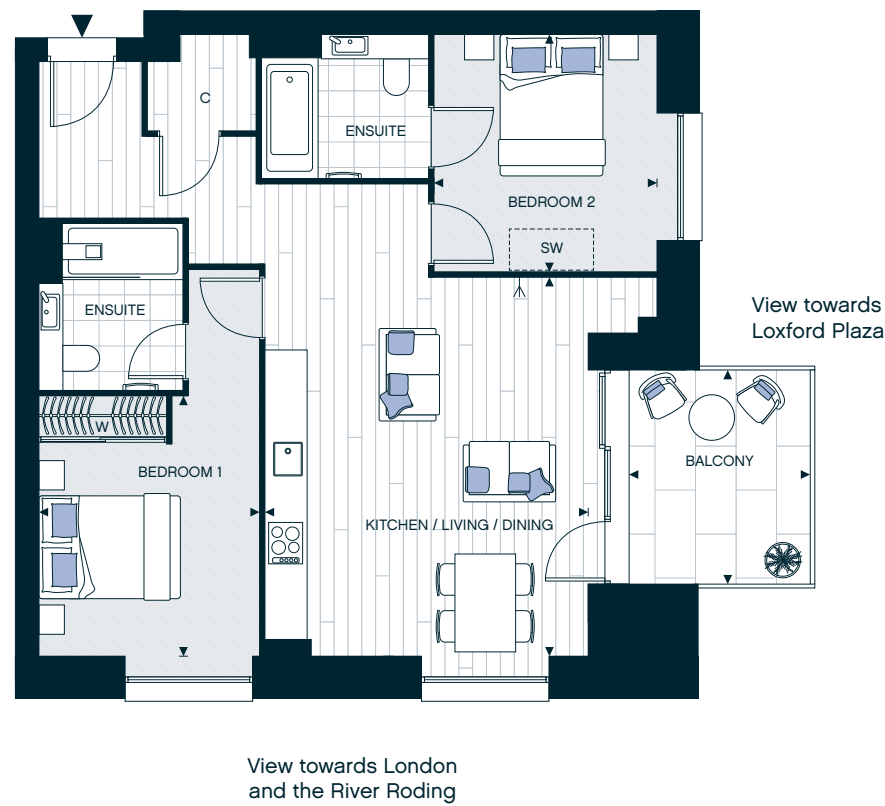

2 Bedroom Apartment

Type 14

Discount Market Sale

1095

Total Area	73.3 SQM	789 SQFT
Kitchen / Living / Dining	4.99m x 4.56m	16' 4" x 14' 11"
Bedroom 1	3.07m x 3.68m	10' 1" x 12' 1"
Bedroom 2	3.48m x 3.34m	11' 5" x 11' 0"
Balcony	2.62m x 2.71m	8' 7" x 8' 11"

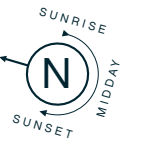

West Elevation

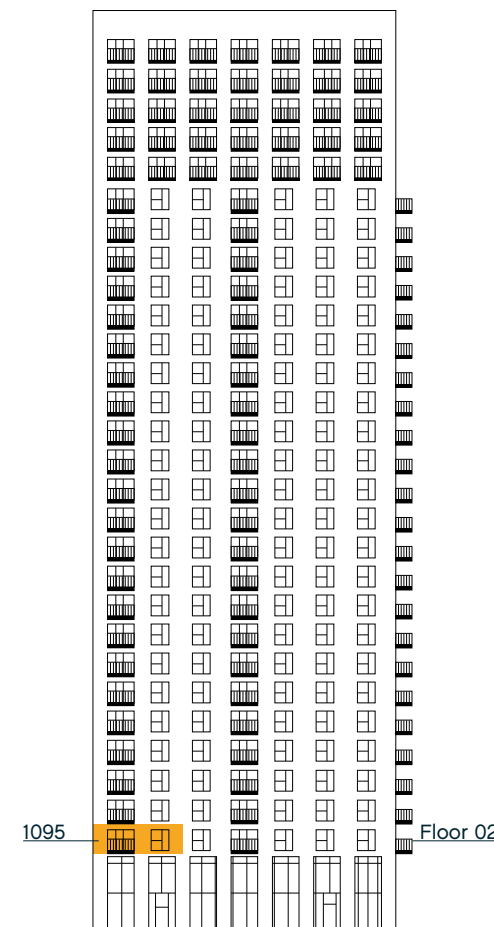

Floor 02 shown below

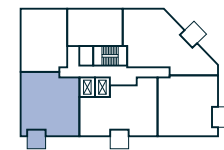

Key

- ▶ Measurement Points
- ← TV Aerial Point
- W Wardrobe
- C Cupboard
- SW Space for Wardrobe

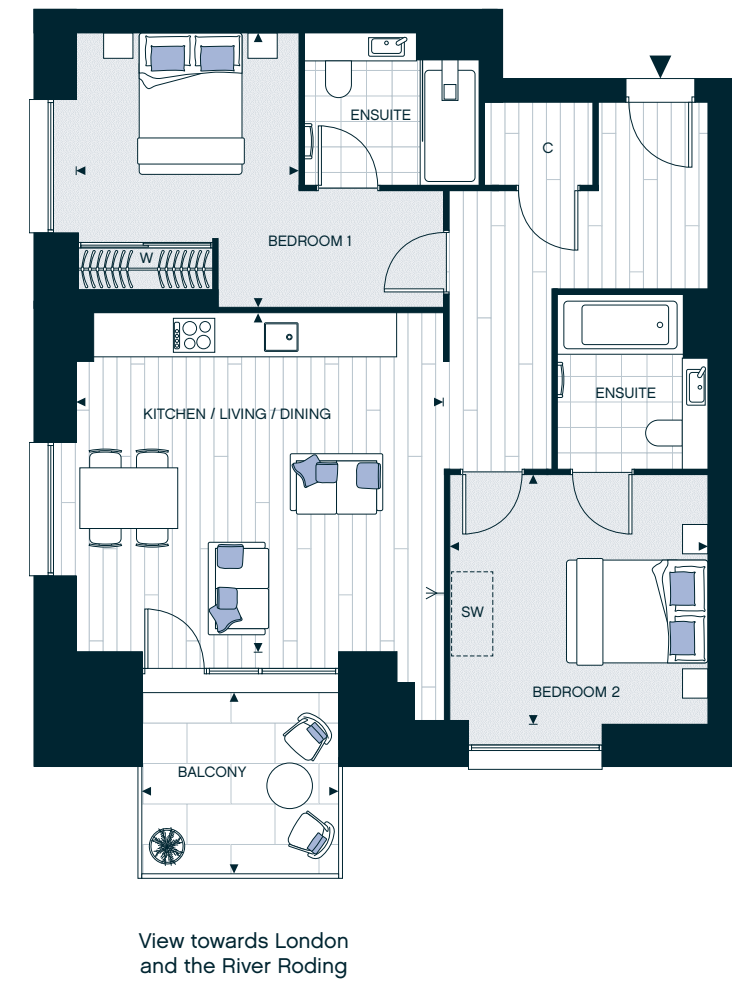

2 Bedroom Apartment

Type 05

Full Market Value

516, 522, 528, 534, 540, 546, 552, 558, 564, 570, 576, 582 & 588

Discount Market Sale

462, 468, 474, 480, 486, 492, 498, 504, 510

Total Area	74.4 SQM	801 SQFT
Kitchen / Living / Dining	4.96m x 4.80m	16' 3" x 15' 9"
Bedroom 1	3.10m x 3.43m	10' 2" x 11' 3"
Bedroom 2	3.60m x 3.34m	11' 10" x 10' 11"
Balcony	2.62m x 2.71m	8' 7" x 8' 10"

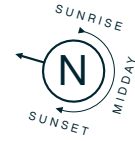

West Elevation

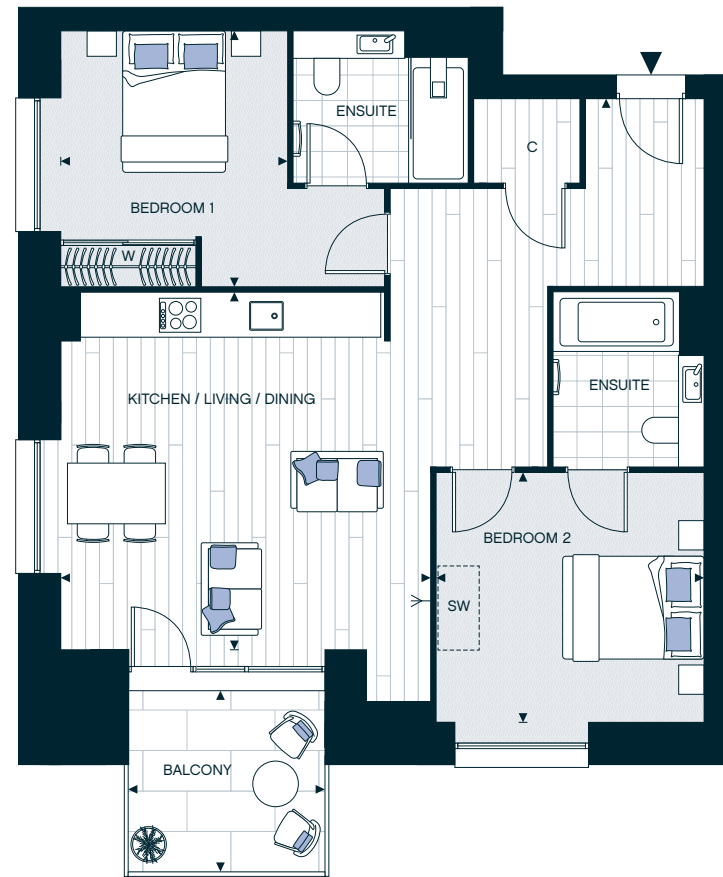
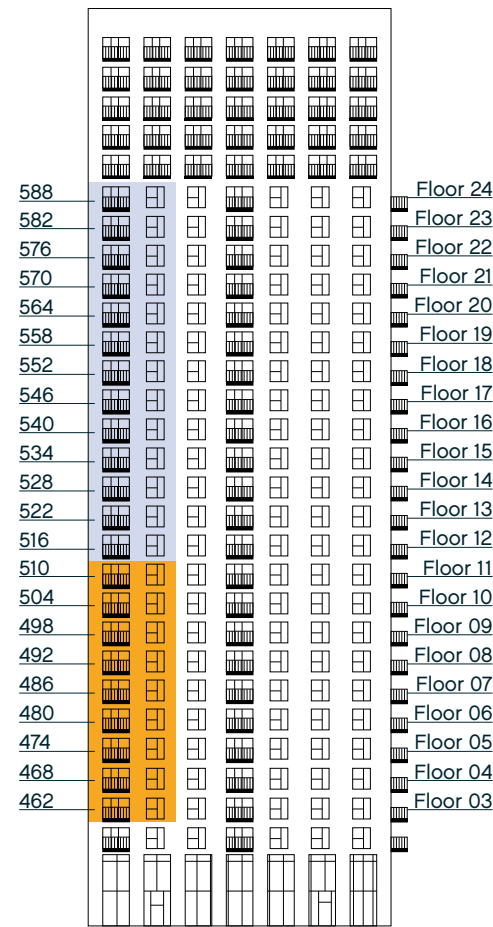

View towards London and the River Roding

Floor 03 shown below



Key

- ▶ Measurement Points
- ← TV Aerial Point
- W Wardrobe
- C Cupboard
- SW Space for Wardrobe

2 Bedroom Apartment

Type 06

Full Market Value

523, 529, 535, 541, 547, 553, 559, 565, 571, 577, 583 & 589

Discount Market Sale

469, 475, 481, 487, 493, 499, 505, 511, 517

Total Area	74.9 SQM	806 SQFT
Kitchen / Living / Dining	5.04m x 4.81m	16' 7" x 15' 9"
Bedroom 1	3.10m x 3.43m	10' 1" x 11' 3"
Bedroom 2	3.60m x 3.32m	11' 10" x 10' 11"
Balcony	2.62m x 2.71m	8' 7" x 8' 10"

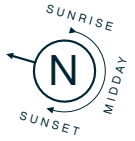

East Elevation

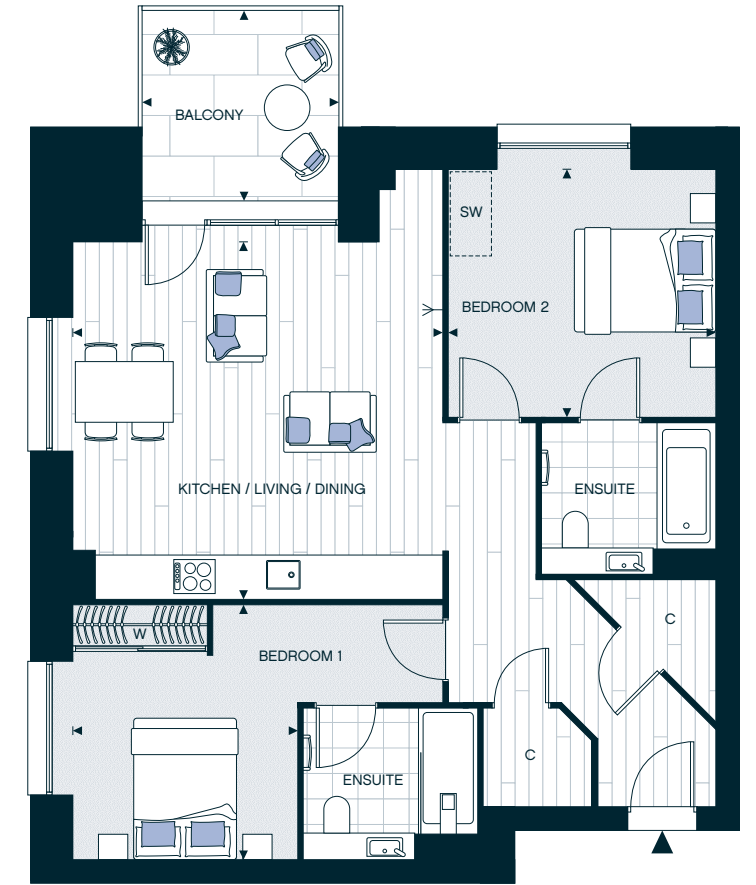
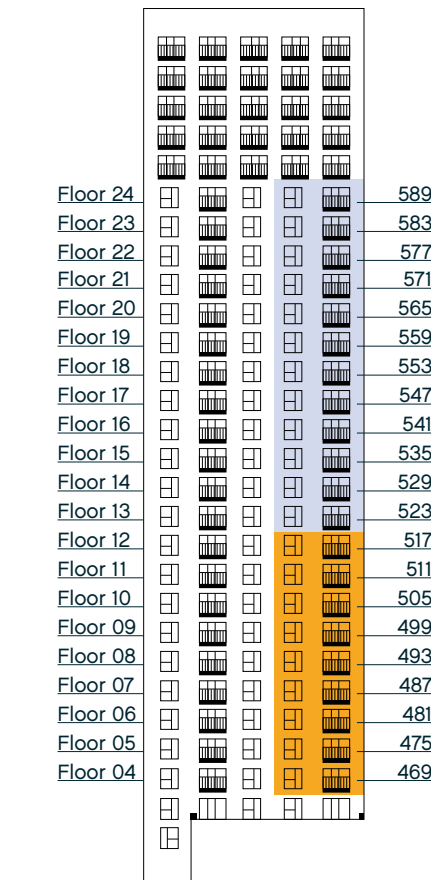

Floor 04 shown below

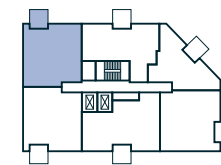

Key

- ▶ Measurement Points
- ← TV Aerial Point
- W Wardrobe
- C Cupboard
- SW Space for Wardrobe

2 Bedroom Apartment

Type 04

Full Market Value

515, 521, 527, 533, 539, 545, 551, 557, 563, 569, 575, 581 & 587

Discount Market Sale

461, 467, 473, 479, 485, 491, 497, 503, 509

Total Area	75.1 SQM	808 SQFT
Kitchen / Living / Dining	4.06m x 6.26m	13' 4" x 20' 6"
Bedroom 1	3.31m x 4.34m	10' 11" x 14' 3"
Bedroom 1 Wardrobe	2.10m x 2.03m	6' 11" x 6' 8"
Bedroom 2	2.88m x 3.95m	9' 5" x 12' 11"
Balcony	2.62m x 2.71m	8' 7" x 8' 10"

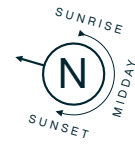

West Elevation

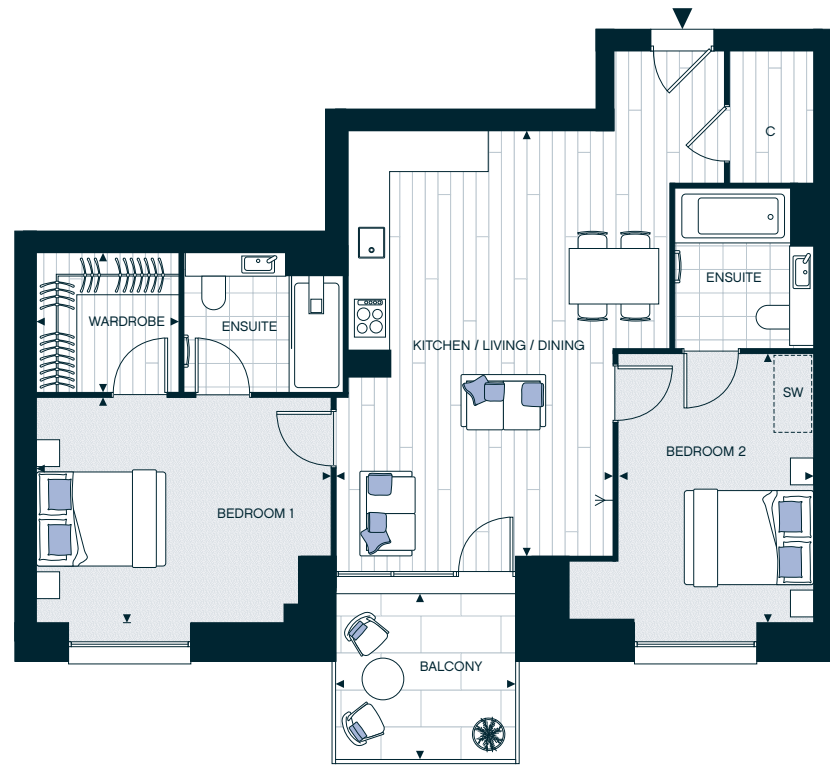
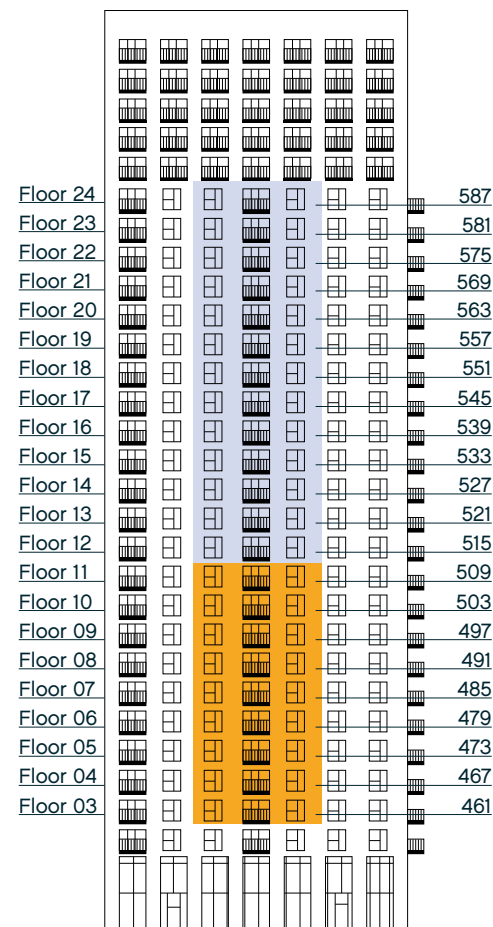

View towards London and the River Roding

Floor 03 shown below

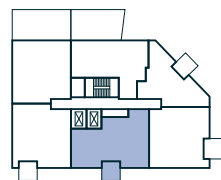

Key

- ▶ Measurement Points
- ◀ TV Aerial Point
- W Wardrobe
- C Cupboard
- SW Space for Wardrobe

2 Bedroom Apartment

Type 16

Discount Market Sale

1094

Total Area	74.9 SQM	806 SQFT
Kitchen / Living / Dining	4.07m x 6.14m	13' 4" x 20' 2"
Bedroom 1	3.29m x 4.47m	10' 10" x 14' 8"
Bedroom 1 Wardrobe	2.25m x 2.03m	7' 5" x 6' 8"
Bedroom 2	3.70m x 2.87m	12' 2" x 9' 5"
Balcony	2.62m x 2.71m	8' 7" x 8' 11"

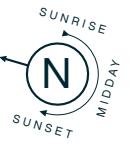

West Elevation

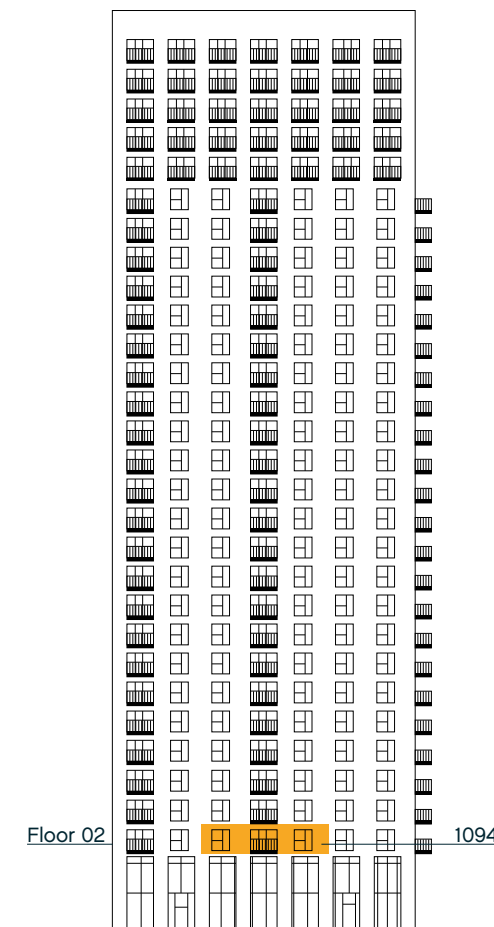

View towards London and the River Roding

Floor 02 shown below

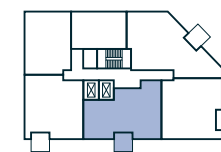

Key

- ▶ Measurement Points
- ◀ TV Aerial Point
- W Wardrobe
- C Cupboard
- SW Space for Wardrobe

2 Bedroom Apartment

Type 17

Discount Market Sale
463

Total Area	78.4 SQM	844 SQFT
Kitchen / Living / Dining	4.96m x 5.77m	16' 3" x 18' 11"
Bedroom 1	3.10m x 3.43m	10' 1" x 11' 3"
Bedroom 2	3.60m x 3.32m	11' 10" x 10' 11"
Balcony	8.81m x 4.03m	28' 10" x 13' 2"

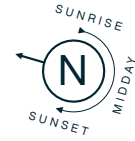

West Elevation

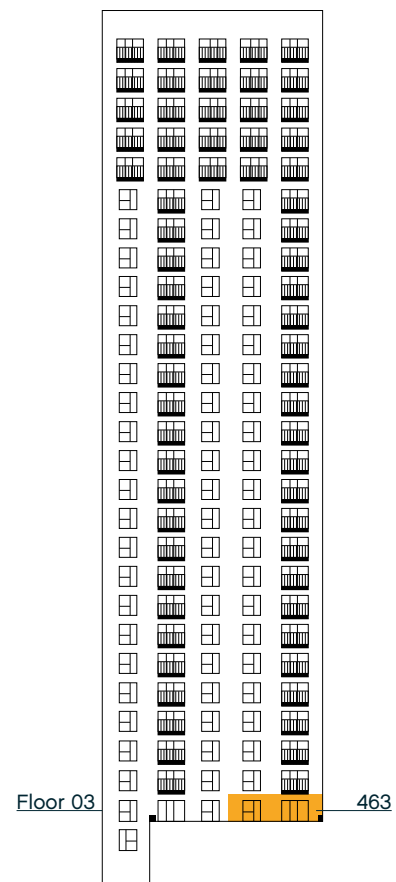

Floor 03 shown below

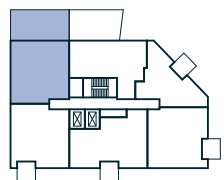

Key

- ▶ Measurement Points
- ◀ TV Aerial Point
- W Wardrobe
- C Cupboard
- SW Space for Wardrobe

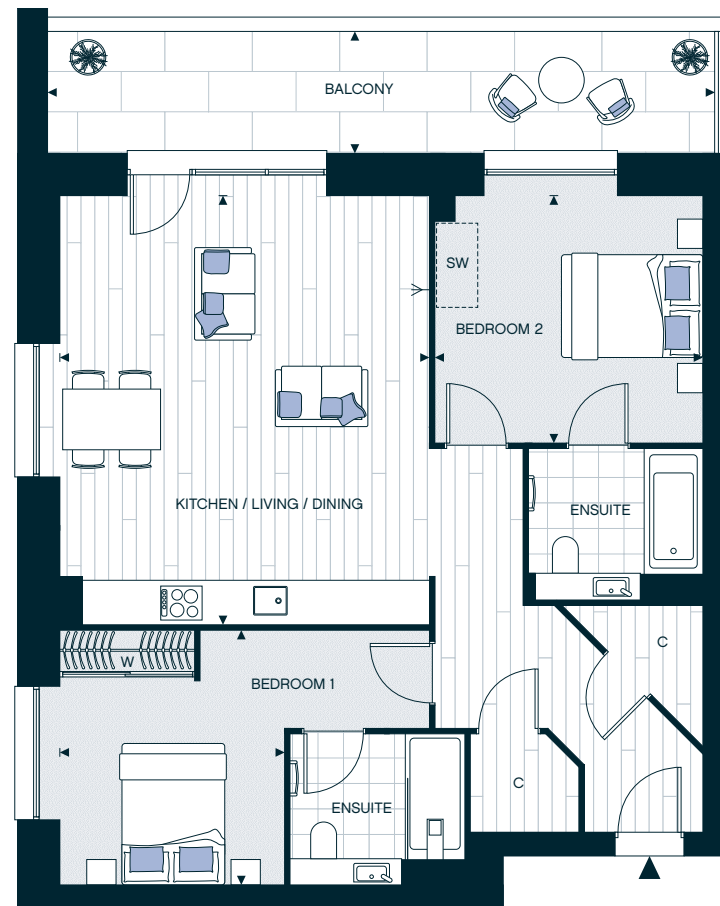

2 Bedroom Apartment

Type 18

Discount Market Sale
1092

Total Area	871 SQM	938 SQFT
Kitchen / Living / Dining	3.98m x 7.37m	13' 1" x 24' 2"
Bedroom 1	3.96m x 4.21m	13' 0" x 13' 10"
Bedroom 2	4.58m x 3.97m	15' 0" x 13' 0"
Balcony	2.62m x 2.71m	8' 7" x 8' 11"

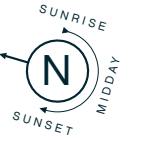

South & South East Elevation

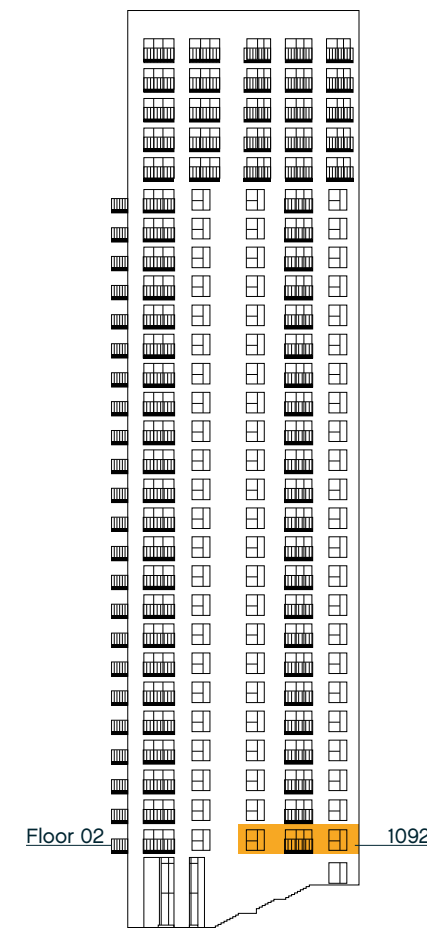

Floor 02 shown below

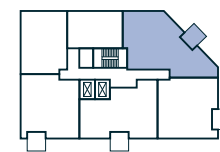

Key

- ▶ Measurement Points
- ◀ TV Aerial Point
- W Wardrobe
- C Cupboard
- SW Space for Wardrobe



An iconic view.
An iconic home.





Photography of Abbey Quay.

Built with Passion, Delivered with Pride

Weston Homes was formed in 1987 by Bob Weston, establishing what has now become one of the major property developers in the South East of England. Weston Homes has established a reputation for high quality design and build standards, delivered with a passionate desire to make a genuine difference to the lives of our customers and to leave a legacy of which we are justly proud.

Continually reassessing the marketplace, Weston Homes has combined the traditional skills of house-building with the ever-expanding opportunities created by new technology. The company has taken a revolutionary approach to property development - many of our properties' components are now pre-manufactured and tested in our own carefully controlled Weston-run factory, rather than on site. This enables the efficient fitting at a late stage of construction of fixtures such as kitchen worktops, wardrobes and bathroom vanity units which incorporate bespoke basins, storage cabinets and associated plumbing. This minimises wasted materials whilst maximising the quality of your brand new home.

Weston Homes provides properties to exceed the expectations of purchasers both in terms of quality and value for money. Projects are hugely varied, ranging from select housing developments to large-scale city apartment complexes of many hundreds of homes. As well as new-build, the company has extensive experience of refurbishment and restoration work, breathing new life into historic and Listed buildings to give new purpose to Britain's architectural heritage.



Photograph of Springfield Park, Maidstone.



Weston Homes Plc
 The Weston Group Business Centre
 Parsonage Road, Takeley
 Essex CM22 6PU
 T: 01279 873300
 E: sales@weston-homes.com
 W: weston-homes.com

Please Note:

- (i) The particulars are set out as a general outline only for the guidance of intending purchasers or lessees and do not constitute, nor constitute part of, an offer or contract.
- (ii) All descriptions, dimensions, references to condition and necessary permissions for use and occupation, and other details are given without responsibilities and any intending purchasers or tenants should not rely on them as statements or representations of fact but must satisfy themselves by inspection or otherwise as to the correctness of each of them.

The information contained in this brochure is for guidance only. Weston Homes Plc operates a policy of continuous product development and features may therefore vary from time to time. Floor plans and dimensions can only be given as a guide and are indicative of the type only. The computer generated images, floor plans, configuration and layouts are included for guidance only, please refer to drawings in the Sales & Marketing Suite. It should be noted that the representations of Abbey Quay may not necessarily be accurate in every respect. These particulars should not be relied on as accurately describing any of the specific matters described by any order under the Consumer Protection from Unfair Trading Regulations (2008). This information does not constitute a contract of warranty. All details correct at time of going to print. Abbey Quay is the marketing name for use until a permanent postal address has been issued.

Sources for travel times: Google Maps and Transport for London

Images are indicative of typical properties by Weston Homes. Photography copyright is owned by Weston Homes Plc.

Weston
Homes 