

25 The Weir
Hessle
HU13 0SB

T: 01482 645100 F: 01482 648900
E: info@hudson-property.co.uk
www.hudson-property.co.uk

HUDSON
PROPERTY



Elloughton Dale, Elloughton

Guide price £124,950

- Plot of Land (0.44 acres)
- Full Planning Approval
- Underground Eco-Home
- Off Street Parking
- Stunning Rural Location
- Close to Village/Amenities
- Outstanding Location
- Superb Opportunity!

Elloughton Dale, Elloughton

Guide price £124,950

INTRODUCTION

Designed by Hesse-based award-winning architect, David Ettridge, this is undoubtedly one of the most exciting residential property opportunities ever to hit the East Riding of Yorkshire. This plot of land, at the heart of Elloughton Dale and only a half-mile walk from the centre of Elloughton village, surrounds a former reservoir for which Full Planning Permission has been granted for the development of an underground home. The land area is about 0.44 acres with a 220 meter (720 feet) perimeter. The existing reservoir chamber is square with an area of about 1600 square feet, and the plan is to excavate 20 feet further into the hill to increase the internal area to about 2400 square feet. The existing bridge will be enlarged to create car parking for two vehicles. We are currently awaiting cost estimates from three local building firms for the complete conversion.

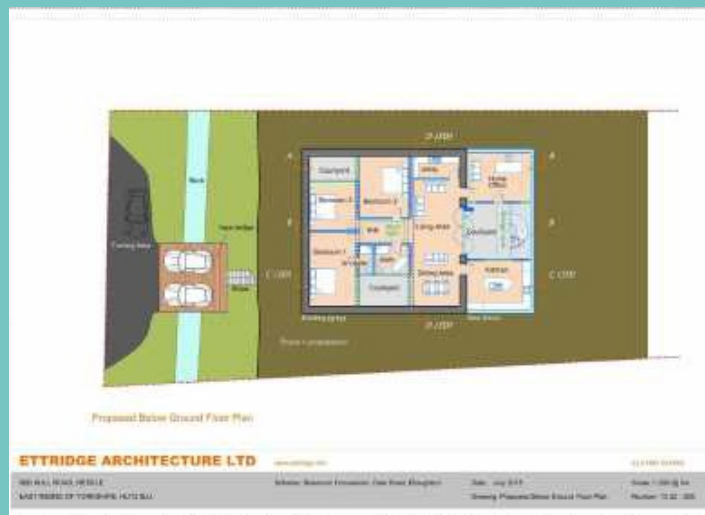

Transport & Local Amenities

Nearest shops/pub - 0.5 miles on foot, 0.7 miles by car (Elloughton Village)

Nearest train station - 2.3 miles (Brough Station, with direct service to London KX)

Nearest international airport - 20.3 miles (Humberside Airport)

Existing Reservoir

12.28m x 12.28m (40'3" x 40'3")

The existing reservoir, which is disused and empty, can currently be accessed via a manhole by descending via wall-mounted rungs. The chamber is roughly square measuring about 40 ft with an internal height of 2.28m(7'6"), giving an internal footprint of about 1600 sqft. The diagonal distance measures approximately 17m(55'9").



Elloughton Dale, Elloughton

Guide price £124,950

The Proposed Dwelling

Planning approval has been given for a development area measuring 40 ft by 60 ft (2400 sqft), which would involve the existing reservoir being extended back, below ground, by a further 20 ft.



25 The Weir T: 01482 645100 F: 01482 648900
Hessle E: info@hudson-property.co.uk
HU13 0SB www.hudson-property.co.uk

HUDSON
PROPERTY 

OTHER INFORMATION

Council tax:

Services:

Tenure: Freehold

Fixtures & Fittings:

Viewing: strictly by appointment only - call Hudson Property on 01482 645100.

NOTE ABOUT PHOTOGRAPHS

A wide angle lense has been used in order to show as much of the rooms as possible, but this can sometimes distort the size of the rooms, so please do refer to the measurements and floor plans available.

These particulars are set out as a general outline only for the guidance of intending buyers and do not constitute any part of an offer or contract. Hudson Property has not carried out a detailed survey, nor tested any services, appliances or fittings and therefore cannot confirm that they are fit for purpose or in working order. All measurements are approximate and any floor plans are provided in good faith to give a general impression only. All descriptions, dimensions, references to condition and necessary permissions for use and occupation, and other details are given in good faith and are believed to be correct but any intending buyer should not rely on them as statements or representations of fact but must satisfy themselves by inspection or otherwise as to the correctness of each of them. No person in the employment of Hudson Property has any authority to make or give any representation or warranty whatsoever in relation to this property. During the conveyancing process (the legal work involved in the sale) circumstances do change and moveable items described in these sales particulars (or on show in the photographs) may no longer be included. Hudson Property recommends a final inspection prior to exchange of contracts. Buyers are advised to take their own measurements if intending to replace floor coverings.