



Somerset Estate | Westcliff on Sea | £450,000

Westcliff-On-Sea

Fox Property Group offer for sale as sole selling agents this detached family home situated on the Somerset Estate, close to local shopping parade and Southend High School. This large family home comprises of ample living space without the sacrifice of losing any garden, boasting two large reception rooms, one of which could be utilized as a fifth bedroom, a ground floor cloakroom and a spacious kitchen / breakfast room. On the first floor, a galleried landing leading four double bedrooms, one with an en-suite, ample storage and a family bathroom. Externally to the front there is a generous lawn and driveway that leads to a detached garage measuring in excess of 28 feet and a garden which is approximately 60' x 46". This charming property retains many of its original features but has undergone some refurbishment by its current owners, an internal viewing is required to fully appreciate this properties full potential.



Detached Family Home

Two Reception Rooms

Garage & Parking

Somerset Estate

Four/Five Bedrooms

Ensuite to Master

Retaining Many Original Features

Gas Centrally Heated

Close to Shops and Schools



Accommodation Summary

Entrance Hall 14'3 x 6'3

Kitchen/Breakfast Room 24'2 x 14'6

Lounge 18'5 x 12'4

Dining Room/Fifth Bedroom 12'2 x 14'4

Ground Floor Cloakroom

First Floor Landing

Bedroom One 11'6 x 11'5

En-Suite

Bedroom Two 11'7 x 10'8

Bedroom Three 10'9 x 9'0

Bedroom Four 8'9 x 6'2

Bathroom

Rear Garden

Front Garden & Driveway

Garage 28'1 x 10'0

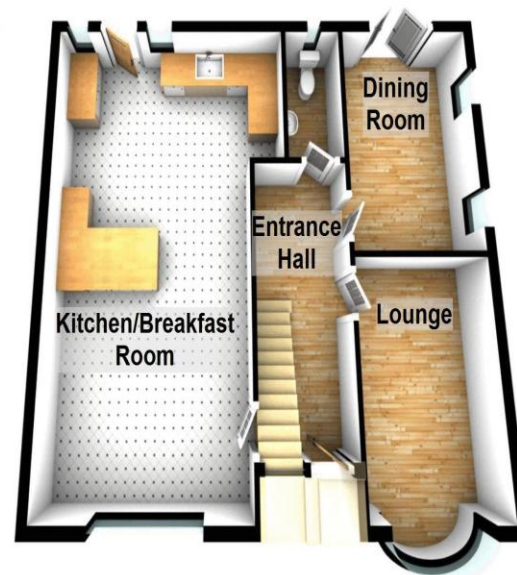





£450,000

Taunton Drive | Westcliff on Sea | SS0 0EQ

Fox Property Rochford Ltd

01702 209920 | sales@foxpropertygroup.co.uk

www.foxpropertygroup.co.uk

277-279 Ashingdon Road | Rochford | SS4 1UA

buy me

Call 01702 20 99 20
foxpropertygroup.co.uk

fox.

THE PROPERTY MISDESCRIPTIONS ACT 1991

The Agent has not tested any apparatus, equipment, fixtures and fittings or services and so cannot verify that they are in working order or fit for the purpose. A Buyer is advised to obtain verification from a Solicitor or Surveyor. References to the Tenure of a Property are based on the information supplied by the seller. The Agent has not had sight of the title documents. A Buyer is advised to obtain verification from their Solicitor. These particulars do not form part of any contract. Measurements are believed to be correct within 3 inches. Items shown in photographs are NOT included unless specifically mentioned within the sales particulars. They may however be available by separate negotiation. Buyers must check the availability of any property and make an appointment to view before embarking on any journey to see a property.