



Kendal

£450 pcm

Flat 12 Queens Lodge
Chapel Lane
Kendal
Cumbria
LA9 5LS

A self contained one bedroom unfurnished apartment, located close to the town centre. Comprising entrance hall, living room, kitchen with electric cooker, double bedroom, bathroom, economy 7 heating/hot water.

- One Bedroom First Floor Flat
- Great Central Location
- One Reception Room & One Bathroom
- Shared Communal Grounds
- Unfurnished
- Unallocated First Come Parking
- Not Suitable for Children or Pets
- No Smokers Or Sharers
- Council Tax Band A
- Available late January and Long Term

Property Ref: KR0143





Lounge

Location: Located off Kirkland at the south end of the Kendal town centre. Turn into Chapel Lane off Kirkland (opposite the Peppercorn car park) and Queens Lodge Apartments can be found on the right hand side just a short way along the lane.

Services: Mains Electric, Water & Drainage

Viewings: Strictly by appointment with Hackney & Leigh – Kendal Office.

Applying for a Tenancy: Tenancy Application Forms are available from any Hackney & Leigh office. Each application must be accompanied by payment of a Holding Deposit (one weeks rent) payable either by debit or credit card. This is paid to reserve the property and will be held by us for a period of 15 days unless we agree otherwise.

All adults of 18yrs and over who will be living at the property will be asked to provide evidence of nationality and identity to validate their "Right to Rent" under the Immigration Act 2014.

Referencing: All applicants will be required to provide satisfactory references eg: employer, current landlord and two character references. For the self-employed, a reference from your accountant or solicitor will be required. A credit reference will be obtained for each applicant. Acceptance of references and the offer of a tenancy is at our discretion.

The Tenancy: The property will be let on a fixed term Assured Shorthold Tenancy for an initial period of 6 months. There is no automatic provision within the lease for early termination and the tenant is responsible for rent for the whole term.

The tenant is responsible for Council Tax for the tenancy period and for all charges for water and sewerage, gas, electricity, telephone or other utility/service providers' charges supplied to the tenant during the tenancy.

Deposit & Rent: The successful Tenant will be required to pay a deposit (equal to a maximum of 5 weeks rent depending on the property). This will be held in accordance with the Tenancy Deposit Scheme Regulations and will be re-fundable at the end of the tenancy, subject to the property being left in a satisfactory condition. Rent is payable on or by each rent day and is payable by standing order. One month's rent in advance PLUS the deposit, is required at the time of signing the agreement. Please Note: It is NOT possible to use the deposit as rent for the final month.

Pets: Not suitable for pets due to lease of building and lack of outside space.

Insurance: It is the Tenants' responsibility to insure their own possessions. Tenants are strongly advised to take out accidental damage cover in respect of the Landlord's property and contents.

Energy Performance Certificate: The full Energy Performance Certificate is available on our website www.hackney-leigh.co.uk and also at any of our offices.

How to rent: Prospective tenants are advised to read the government's leaflet which is available here: <https://www.gov.uk/government/publications/how-to-rent>



Kitchen



Bathroom

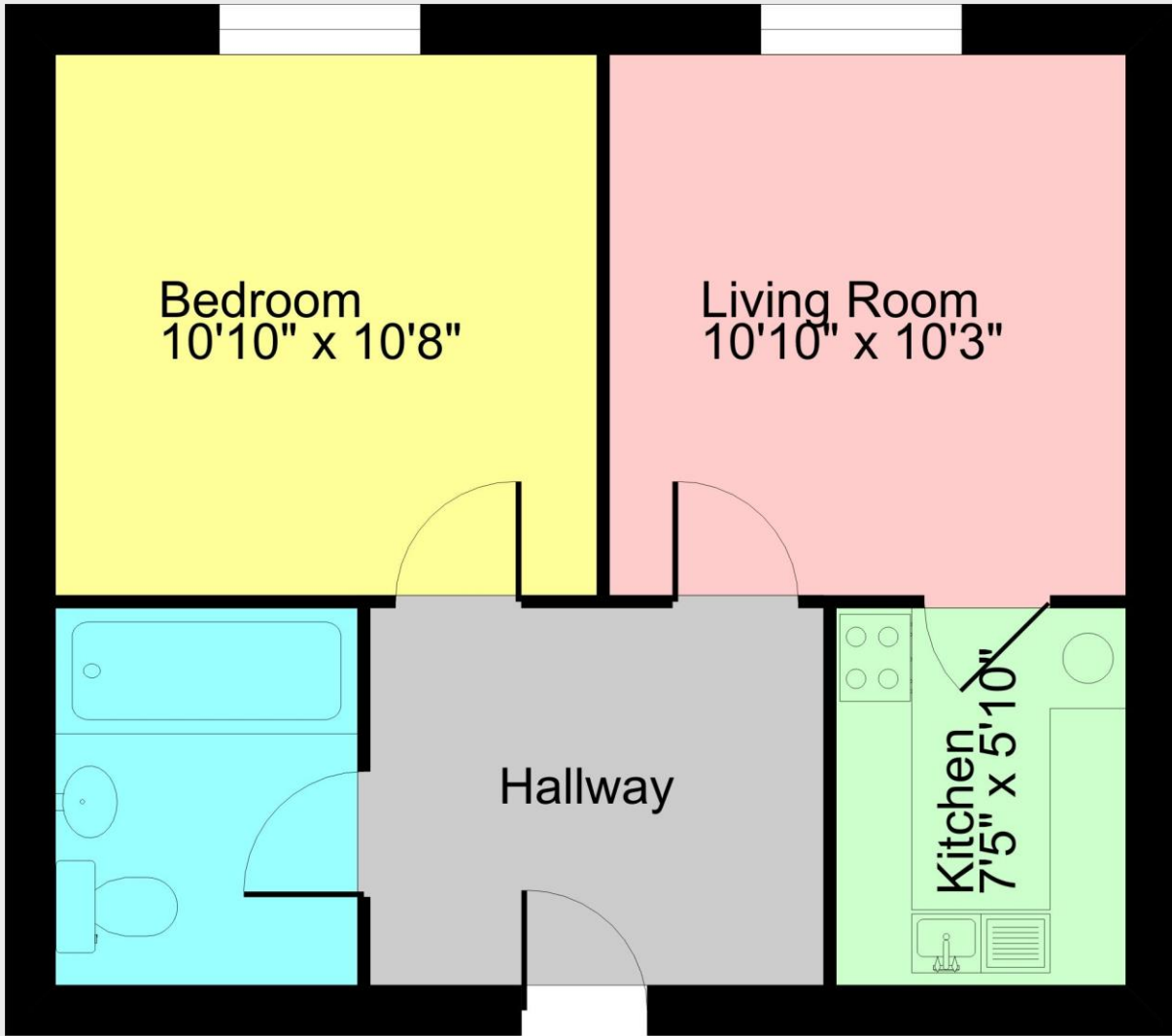

Gross internal square footage = Approx 393 Sq Ft

SKETCH PLAN FOR ILLUSTRATIVE PURPOSES ONLY

© Drawing by Business Etc Ltd. Unauthorised reproduction prohibited. Drawn in the UK.
Drawing No. KR0145R

Apartments

Chapel Lane Kendal - Ref: KR0143

Property particulars and appointments to view are provided on the understanding that all negotiations are conducted through Hackney and Leigh Ltd. This information is provided for general guidance only. It does not form part of any contract or agreement and no guarantee of accuracy is given. Prospective tenants should make their own enquiries as to the suitability or otherwise of the property. No responsibility can be accepted for any loss or expense incurred in viewing or in the event of a property being let or withdrawn. Please contact us to confirm the property's availability, especially if travelling some distance.