



RUPERT STREET, LONDON, W1D  
£535,000 LEASEHOLD

A NEWLY REFURBISHED FIRST FLOOR STUDIO FLAT IN EXCELLENT CONDITION WITH A MEZZANINE SLEEPING DECK IN A PERIOD PROPERTY IN THE HEART OF LONDON'S FASCINATING AND LIVELY SOHO DISTRICT.

West End | 020 7240 3322 | westend@winkworth.co.uk

**Winkworth**

[winkworth.co.uk](http://winkworth.co.uk)

See things differently

## DESCRIPTION:

The apartment overlooks Rupert Street and has lovely large windows providing abundant natural light. Wood floors, a modern kitchen and shower room all make this a perfect London base.

The common parts have all been upgraded and refurbished recently.

The property is found on Rupert Street near the junction with Brewer Street giving great access to all the retail, entertainment and dining opportunities of London's West End.

Service Charge: £1500 PA approx.

Ground Rent: £250 PA approx.

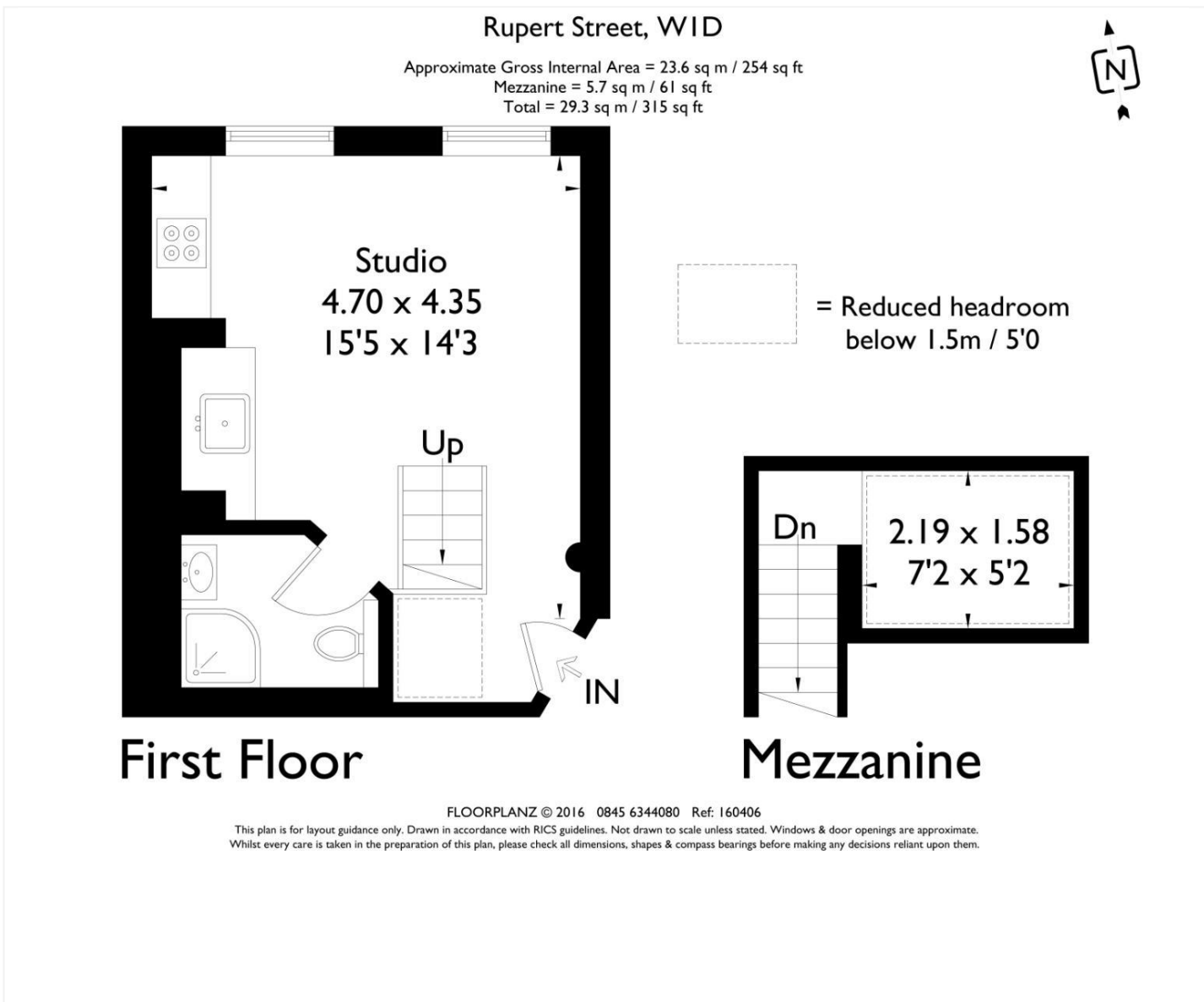

This floorplan is for illustration purposes only and is not to scale. The position and size of doors, windows, appliances and other features are approximate.

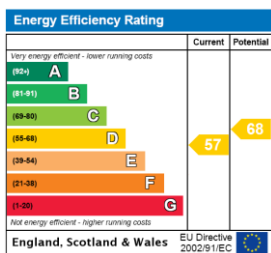

West End | 020 7240 3322 | westend@winkworth.co.uk

