

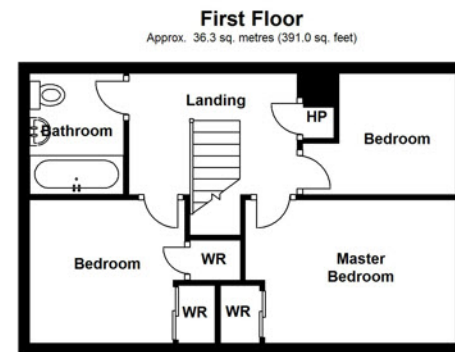

TEMPLETON
ROBINSON

TEMPLETON
ROBINSON

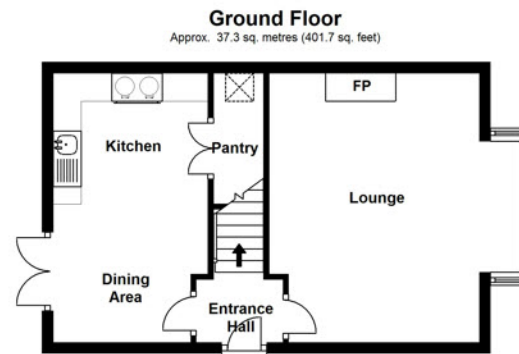

Getting You
Best Price

Epc to come



Belfast Branches

Lisburn Road - 028 90 66 3030
Ballyhackamore - 028 90 65 0000

Other Branches

Bangor - 028 91 45 1166
Holywood - 028 90 42 4747
Lisburn - 028 92 66 1700

www.templetonrobinson.com

These particulars do not constitute any part of an offer or contract. None of the statements contained in these particulars are to be relied on as statements or representations of fact and intending purchasers must satisfy themselves by inspection or otherwise to the correctness of each of the statements contained in these particulars. The Vendor does not make or give, neither Templeton Robinson, nor any person in its employment has any authority to make or give, any representation or warranty whatever in relation to this property. All dimensions are taken to nearest 3 inches.

This beautifully presented semi detached villa has been sympathetically renovated offering character and charm along with modern convenience in a relaxing environment and also benefits from off street parking and a detached garage. Set in a quiet location, yet remaining convenient to both Belfast and Lisburn, along with a variety of local amenities including shops, public paths, the lagan towpath and public transport routes, this fine home can only be fully appreciated on internal inspection.

Offers Around
£125,000

142 Glenwood
Court,
LISBURN,
BT28 3UF

Viewing by
appointment with
& through agent
028 9266 1700

142 Glenwood Court,
LISBURN,
BT28 3UF

Property Features

Delightful Semi Detached Villa In Popular Location

Luxury Fitted Kitchen Open Plan to Dining Area With Upvc Double Doors Outside

Good Sized Lounge with Feature Carved Wood Fireplace

Three Well Proportioned Bedrooms (Two With Built In Robes)

Luxury Fully Tiled Bathroom Suite

Superb Level of Presentation with a Feeling of Warmth & Character Throughout

Upvc Double Glazed Windows

Oil Fired Central Heating

Tarmac Driveway With Parking For Several Vehicles

Detached Garage

Front & Back Enclosed Garden With Decked Sitting Area

Close to Many Local Amenities Including Shops, Public Transport & Schools

Location:

From Prince William Road turn on to Ballymacash Road, continue through mini roundabout on to Glenavy Road and Glenwood Court is on the right hand side.

Property Comprises

Ground Floor

uPVC front door to...

ENTRANCE HALL: Strip wood flooring.

LOUNGE: 15' 08" x 11' 05" (4.78m x 3.48m) Matching strip wood flooring, feature fireplace with carved solid wood surround and slate hearth.

KITCHEN/DINING AREA: 15' 08" x 9' 01" (4.78m x 2.77m) Slate tiled floor, range of units, granite worktops, space for Aga cooker, door to shelved pantry, uPVC double doors leading to outside, stairs to...

First Floor

LANDING: Strip wood flooring, access to roofspace, shelved hotpress with copper cylinder.

BEDROOM (1): 12' 07" x 8' 10" (3.84m x 2.69m) Built in slide robe, strip wood flooring.

BEDROOM (2): 9' 04" x 8' 10" (2.84m x 2.69m) Matching strip wood flooring, built in shelved wardrobe, additional slide robe.

BEDROOM (3): 9' 04" x 6' 10" (2.84m x 2.08m) Matching strip wood flooring.

BATHROOM: Fully tiled with panelled bath with Rainhead shower above and telephone hand shower with glass shower screen, low flush wc, pedestal wash hand basin, extractor fan, chrome heated towel rail.

Outside

Front garden in lawn with a selection of plants and shrubs.

Enclosed rear garden in lawn with wooden decked sitting areas.

Outside tap and light. Tarmac driveway with parking for several vehicles leading to...

DETACHED GARAGE: 18' 04" x 11' 09" (5.59m x 3.58m)

Laminate wood effect floor, roller door, oil fired boiler, uPVC double glazed side door, power and light.

