



SALES

LETTINGS

MANAGEMENT

chiswick@tatepartnership.co.uk

020 8996 0000

TATEPARTNERSHIP.CO.UK



Stamford Court, W6

£1,650 pcm

*****RENT INCLUDES HOT WATER & BACKGROUND HEATING*****

Newly Decorated and ready to occupy, a well-presented one bedroom purpose built apartment, located moments from Stamford Brook station. The flat is on the ground floor of this popular development. At 506 sq/ft it comprises; entrance hall, generous living room, modern fitted kitchen, double bedroom and modern fitted bathroom. The development has off street parking for residents on First Come First Serve basis (FCFS). Included in the rent are Hot Water & Background Heating. On-site caretaker. Stamford Court is situated on Goldhawk Road, opposite Stamford Brook station (zone 2). Chiswick High Road and King Street are only a few minutes walk. Available Now. Unfurnished.

Stamford Court, W6

Floor Plan

Approximate gross internal area
47 sq m / 506 sq ft

Stamford Court, W6

Approximate Gross Internal Area
47 sq m / 506 sq ft

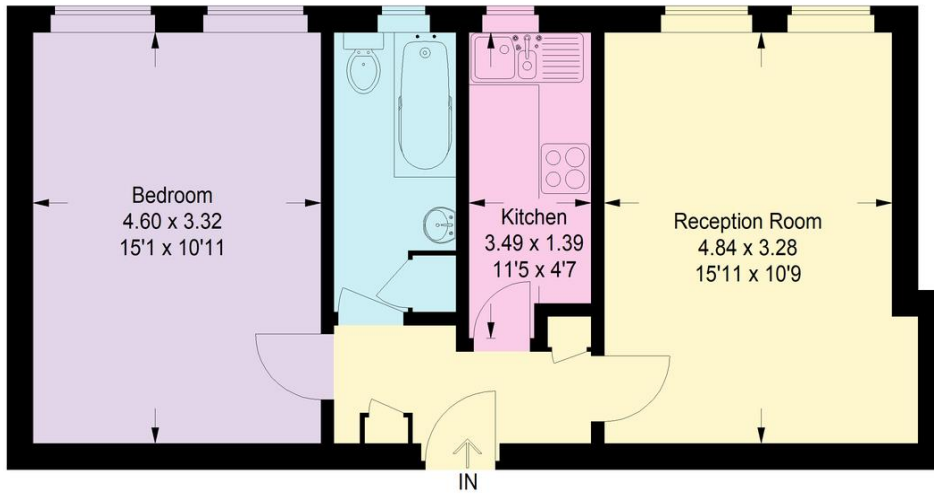
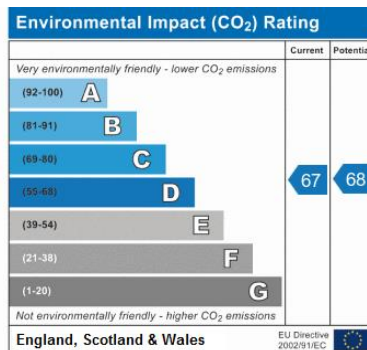
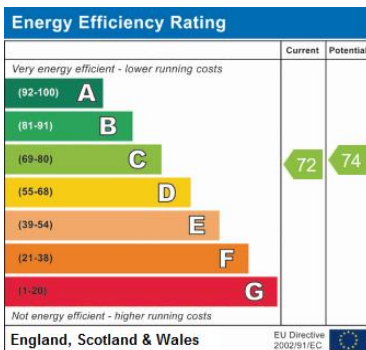

Illustration for identification purposes only, measurements are approximate, not to scale.
FloorplansuSketch.com © 2013 (ID 1016725)

EPC



Address:
Stamford Court, W6