



7 Talisman Close | | Kenilworth | CV8 1TE

£995pcm Furnished

AN IMMACULATE 2 BEDROOM SEMI IN CENTRAL KENILWORTH. With a side garage, fitted kitchen & bathroom & furnished to a high standard. Comprising a reception hallway, cloakroom, rear sitting room, fitted kitchen, two bedrooms & bathroom. Drive & side garage. Available NOW FURNISHED.

- Town Centre Location
- Two Bedroom Semi Detached
- Refitted Kitchen & Bathroom
- EPC Rating D
- Side Garage and Driveway

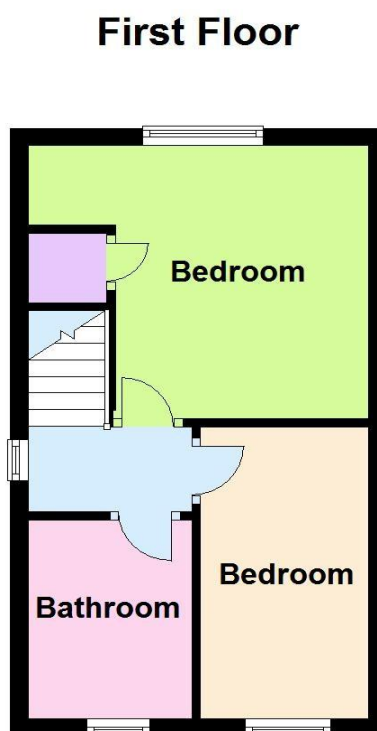
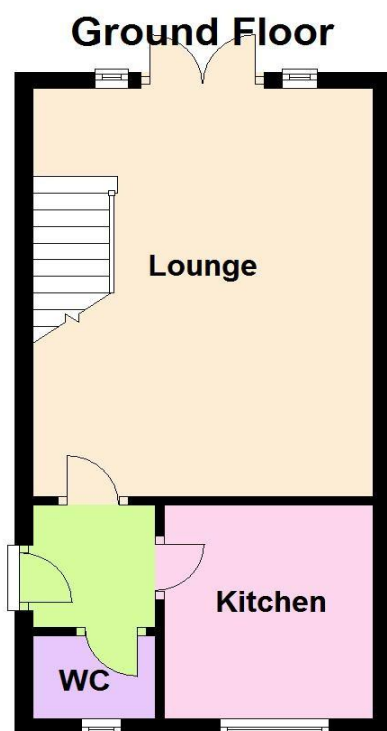

Contact Details

19 The Square
Kenilworth
Warwickshire
CV8 1EF

www.boothroyd.co.uk
lettings@boothroyd.co.uk
01926 857244

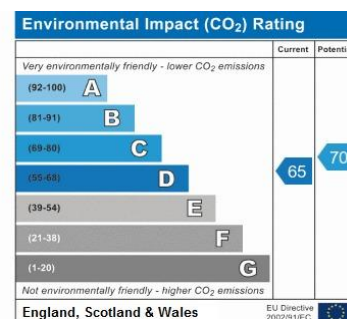
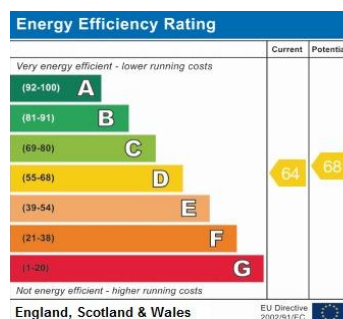

Agents Note: Whilst every care has been taken to prepare these particulars, they are for guidance purposes only. All measurements are approximate and for general guidance purposes only and whilst every care has been taken to ensure their accuracy, they should not be relied upon and potential tenants are advised to recheck the measurements.