



Glenure Court, Charlton Kings, Cheltenham

GL53 8DY

Per Month Rental Price of £700

Glenure Court is a prestigious collection of apartments set just off the Cirencester Road. This expansive one bedroom first floor apartment enjoys dual aspects overlooking the surrounding countryside, spacious accommodation and off road parking.

This very large one bedroom first floor apartment must be viewed to fully appreciate its space and layout. Occupying the west side of this Grade II listed period property, you will find a private garden to the rear and private residents parking to the front.

The foyer is open and spacious with floors laid with decorative stone tiles leading to a Regency style staircase. As you enter the apartment you will step into an enclosed hallway with rooms set off. The hallway has newly laid carpet and a large store room for coats, shoes and other household items. The bathroom sits to your right with plenty of floor space, full size bath with electric shower set within, toilet and wash hand basin with a corner window box allowing in natural light. The huge bedroom has newly fitted carpet, a period working fireplace, original sash windows and fitted wardrobes providing a large amount of storage space. The kitchen is spacious and fitted, standing between the entrance hall and the living room and benefits with newly laid flooring, a built in oven and gas hob. Beyond the kitchen, the expansive living room boasts an ornamental fireplace and dual aspects offering some lovely views of the countryside.

High ceilings, large sash windows, original ceiling mouldings and coving and tall skirting boards all compliment this apartment. This property also benefits with gas central heating and a Worcester combination boiler. A communal garden is set to the rear and is enclosed for residents to enjoy. The property is also perfectly placed for access to the A40 and has good links to the town centre.

A lovely example of a large, spacious apartment set within a beautiful period property and

Registered Company No. 9423120

t: 01242 584007 · e: info@meandyouestateagents.co.uk · 21 Rodney Road, Cheltenham, GL50 1HX

www.meandyouestateagents.co.uk

grounds.



Registered Company No. 9423120

t: 01242 584007 · e: info@meandyouestateagents.co.uk · 21 Rodney Road, Cheltenham, GL50 1HX

www.meandyouestateagents.co.uk

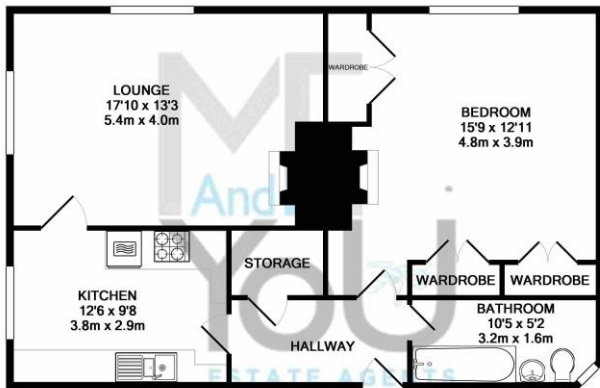

Whilst every attempt has been made to ensure the accuracy of the floor plan contained here, measurements of doors, windows, rooms and any other items are approximate and no responsibility is taken for any error, omission, or mis-statement. This plan is for illustrative purposes only and should be used as such by any prospective purchaser. The services, systems and appliances shown have not been tested and no guarantee as to their operability or efficiency can be given.
Made with Metropix ©2016





Registered Company No. 9423120

t: 01242 584007 · e: info@meandyouestateagents.co.uk · 21 Rodney Road, Cheltenham, GL50 1HX

www.meandyouestateagents.co.uk



Registered Company No. 9423120

t: 01242 584007 · e: info@meandyouestateagents.co.uk · 21 Rodney Road, Cheltenham, GL50 1HX

www.meandyouestateagents.co.uk



Registered Company No. 9423120

t: 01242 584007 · e: info@meandyouestateagents.co.uk · 21 Rodney Road, Cheltenham, GL50 1HX

www.meandyouestateagents.co.uk



Registered Company No. 9423120