



Kendal

£650 pcm

13 Camden Buildings

Kendal

Cumbria

LA9 4BH

A ground floor apartment, in Kendal Town Centre, with the added benefit of an allocated parking space. Comprising; Open-plan living accommodation, one bedroom and a bathroom.

- One Bedroom Ground Floor Apartment
- One Reception Room, One Bathroom
- Modern Kitchen
- Unfurnished
- Allocated Parking Space
- Convenient Town Centre Location
- Not Suitable For Pets
- No Smokers or Sharers
- Council Tax Band B
- Available Mid October and Long Term

Property Ref: KR0465





Kitchen area

Location: Camden Buildings can be found opposite the River Kent, just off New Road, by entering the yard to the left of the church. No 13 is located on the right hand side.

Note: Please note this property was affected by Storm Desmond in December 2015

Services: Mains electricity, gas, water and drainage.

Viewings: Strictly by appointment with Hackney & Leigh – Kendal Office

Applying for a Tenancy: Tenancy Application Forms are available from any Hackney & Leigh office. Each application must be accompanied by payment of a Holding Deposit (one weeks rent) payable either by debit or credit card. This is paid to reserve the property and will be held by us for a period of 15 days unless we agree otherwise.

All adults of 18yrs and over who will be living at the property will be asked to provide evidence of nationality and identity to validate their "Right to Rent" under the Immigration Act 2014.

Referencing: All applicants will be required to provide satisfactory references eg: employer, current landlord and two character references. For the self-employed, a reference from your accountant or solicitor will be required. A credit reference will be obtained for each applicant. Acceptance of references and the offer of a tenancy is at our discretion.

The Tenancy: The property will be let on a fixed term Assured Shorthold Tenancy for an initial period of 6 months. There is no

automatic provision within the lease for early termination and the tenant is responsible for rent for the whole term.

The tenant is responsible for Council Tax for the tenancy period and for all charges for water and sewerage, gas, electricity, telephone or other utility/service providers' charges supplied to the tenant during the tenancy.

Deposit & Rent: The successful Tenant will be required to pay a deposit (equal to a maximum of 5 weeks rent depending on the property). This will be held in accordance with the Tenancy Deposit Scheme Regulations and will be re-fundable at the end of the tenancy, subject to the property being left in a satisfactory condition. Rent is payable on or by each rent day and is payable by standing order. One month's rent in advance PLUS the deposit, is required at the time of signing the agreement. Please Note: It is NOT possible to use the deposit as rent for the final month.

Pets: Not suitable for pets due to the lack of outside space.

Insurance: It is the Tenants' responsibility to insure their own possessions. Tenants are strongly advised to take out accidental damage cover in respect of the Landlord's property and contents.

Energy Performance Certificate: The full Energy Performance Certificate is available on our website www.hackney-leigh.co.uk and also at any of our offices.

How to rent: Prospective tenants are advised to read the government's leaflet which is available here: <https://www.gov.uk/government/publications/how-to-rent>



Kitchen



Lounge area

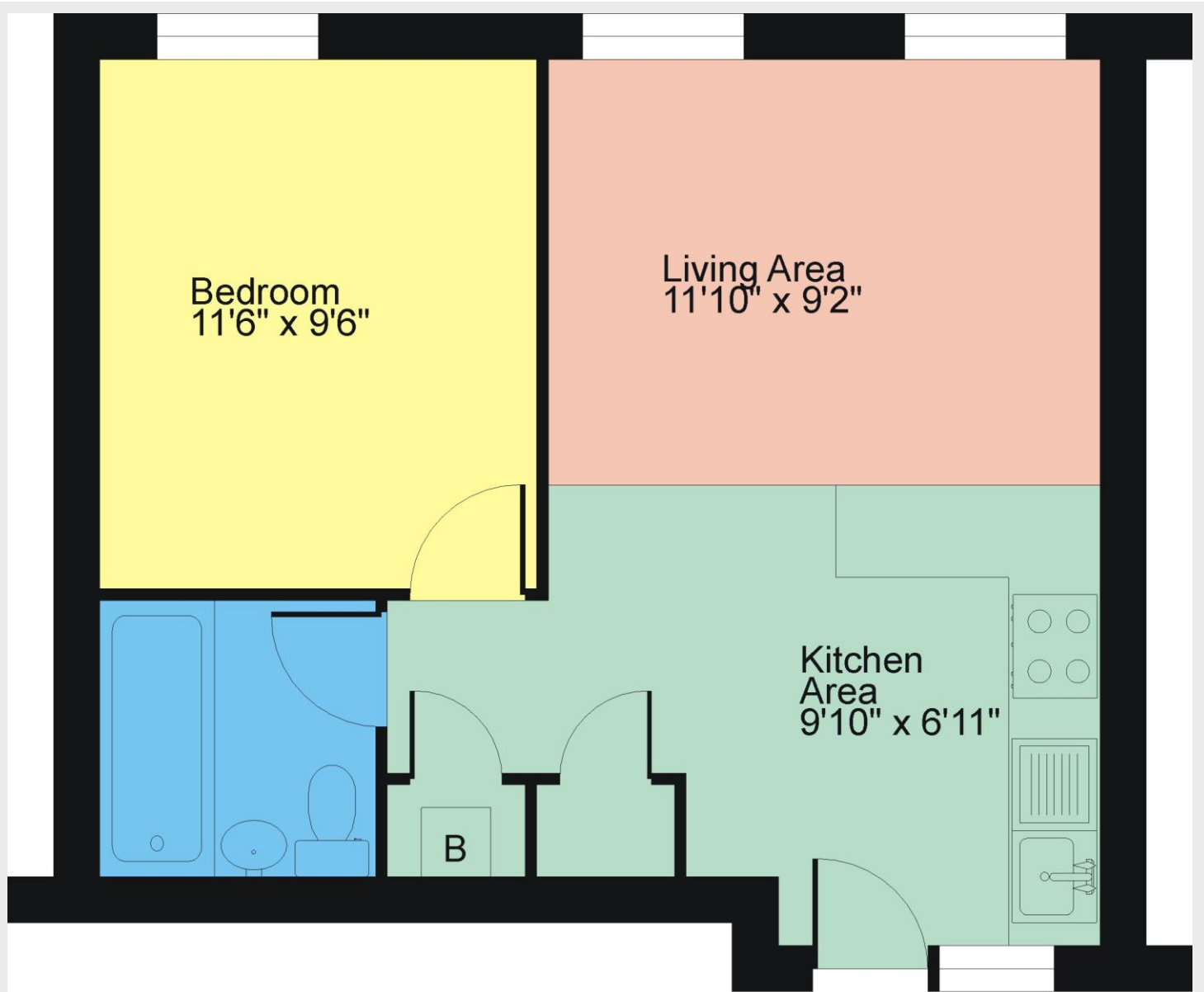

Gross internal square footage = Approx 396 Sq Ft

SKETCH PLAN FOR ILLUSTRATIVE PURPOSES ONLY

© Drawing by Business Etc Ltd. Unauthorised reproduction prohibited. Drawn in the UK.
Drawing No. KR0465/JJ

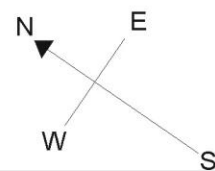

13 Camden Buildings Kendal - Ref: KR0465

Property particulars and appointments to view are provided on the understanding that all negotiations are conducted through Hackney and Leigh Ltd. This information is provided for general guidance only. It does not form part of any contract or agreement and no guarantee of accuracy is given. Prospective tenants should make their own enquiries as to the suitability or otherwise of the property. No responsibility can be accepted for any loss or expense incurred in viewing or in the event of a property being let or withdrawn. Please contact us to confirm the property's availability, especially if travelling some distance.