

CARLYLE SQUARE

CHELSEA • SW3



 Knight
Frank

CARLYLE SQUARE

CHELSEA • SW3

This is an outstanding semi-detached family house with substantial proportions throughout that now requires updating.

The house has been in the same ownership for over 50 years but has been extremely well kept. Internally there is an excellent balance of living and sleeping accommodation and there are currently 5/6 bedrooms and 2/3 reception rooms with a large kitchen/breakfast room. There is plenty of scope for further extension (subject to the usual consents) and there is a charming garden to the rear of the property.

Carlyle Square is undoubtedly one of the most sought after and well maintained garden squares in Chelsea and is situated just off the Kings Road. The award-winning gardens are owned by and can only be accessed by the residents of the square. It is also worth noting that the square has a security patrol.

Location

There are good transport links with regular bus services as well as South Kensington (Circle, District, Piccadilly lines) underground station approximately 0.6 miles away and Sloane Square (District and Circle lines) underground station approximately 0.9 miles away (all distances and times given are approximate).





5/6 bedrooms • 3 bathrooms • Reception Room • Dining room • Kitchen/Breakfast Room
• Study/ Family Room • Guest Cloakroom
• Loft/ Storage Area • Garden
• Access to Communal Garden Square

Terms

Tenure: Freehold

Local Authority: The Royal Borough of Kensington & Chelsea

Guide price: Price on Application

Viewing Arrangements

By appointment by Knight Frank Chelsea
0207 349 4300



Approximate Gross Internal Floor Area

333.7 sq.m./3,592 sq.ft.

This plan is for guidance only and must not be relied upon as a statement of fact. Attention is drawn to the Important Notice on the last page of the text of the Particulars



Lower Ground Floor



Ground Floor

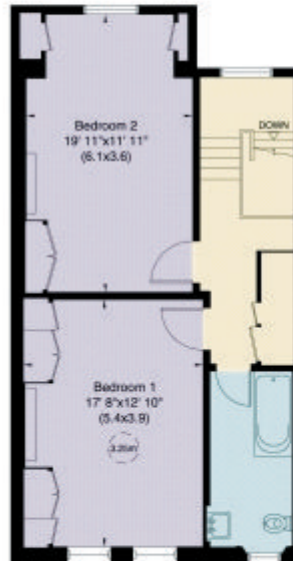

First Floor



Second Floor

