

**£675 pcm**

Haighs Close, Chatteris, Cambridgeshire PE16 6HU



To arrange a viewing call us now on 01354 694900

Deposit £778

Ground Floor

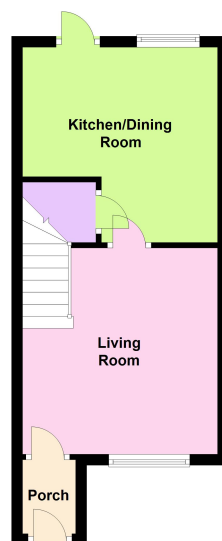

First Floor

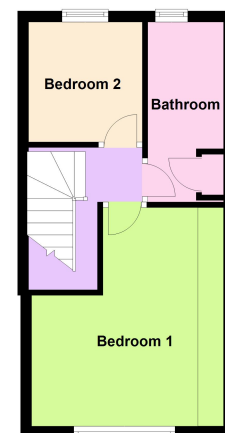

This two bedroom mid terraced property has good size kitchen/diner, living room and two good size bedrooms.

There is also a fully enclosed rear garden and allocated parking.

Available mid February, call now to book your viewing.

£675 pcm

Haighs Close, Chatteris, Cambridgeshire PE16 6HU



#### GROUND FLOOR

##### PORCH

Door leading into living room.

##### LIVING ROOM

3.76m (12'4") x 3.56m (11'8")  
Window to front, stairs rising to first floor.

##### KITCHEN / DINING ROOM

3.56m (11'8") max. x 3.56m (11'8")  
Fitted with wall and base units housing single electric oven and four ring gas hob with extractor over, plumbing for washing machine and dishwasher, space for fridge/freezer, storage cupboard, wall mounted gas boiler, window to rear, door out to garden.

#### FIRST FLOOR

##### BEDROOM 1

3.99m (13'1") x 3.50m (11'6") max.  
Window to front, wardrobes.

##### BEDROOM 2

2.19m (7'2") x 2.08m (6'10")  
Window to rear.

##### BATHROOM

Fitted with a three piece suite comprising:  
Panelled bath with mains shower over, low level WC and hand wash basin. Airing cupboard, window to rear.

#### OUTSIDE

Both the front and rear gardens are low maintenance and laid to gravel with a variety of shrubs and flowers. The rear garden also has a storage shed, patio areas and rear pedestrian access which leads to the parking area.

#### SERVICES

Mains gas, electricity, water and drainage.

#### DIRECTIONS

Proceed round into Park Street and turn right into Huntingdon Road. Take the first right into Clare Street and the second right into Haighs Close. The property is located on the left hand side.

#### VIEWINGS

By arrangement with elliswinters&co

Fenland District Council Tax band A  
Energy rating - C

INITIAL LENGTH OF TENANCY  
6 months

Ellis Winters & Co 20 Market Hill, Chatteris, Cambridgeshire, PE16 6BA  
Tel: 01354 694900 Email: [info@elliswinters.co.uk](mailto:info@elliswinters.co.uk) [www.elliswinters.co.uk](http://www.elliswinters.co.uk)