

Rockley Park, Napier Road, Poole, BH15 4LZ  
Three Bedroom Park Home In Rockley Park in Excellent Condition

 clearwater.co





# Rockley Park, Napier Road, Poole, BH15 4LZ

£35,000

## Three Bedroom Park Home In Rockley Park in Excellent Condition

- Located On An Elevated Plot With Superb Views Over Lytchett Bay
- Contemporary Living Area
- Modern Fitted Kitchen, Dining Table and Corner Sofa Suite
- One Double Bedroom with En-Suite and Two Twin Rooms
- Contemporary Shower Room & Cloakroom
- Gas Central Heating
- Patio, Garden Area and PArking
- An Abundance of Park Activities
- Park Open From 2nd March - 2nd January Each Year

### Inside Areas

A beautifully presented three bedroom park home located in the sought after Rockley Park. There is a contemporary open plan family room which comprises kitchen with built-in oven, hob and microwave and a breakfast bar. Separate dining area with corner suite and further living area. One double bedroom with en-suite and two twin rooms, all with built-in wardrobes and cabinetry.

### Outside Areas

The property is located on an elevated plot with lawned garden which enjoys fantastic views of Lytchett Bay (inner harbour). There is also a patio area directly outside the cabin which is ideal for al fresco dining.

### Park Facilities

Heated Indoor and Outdoor Swimming Pools  
Private Health Suite  
Family Crazy Golf  
Access To Nature Reserve and Beaches  
Day and Evening Entertainment  
Boat Park with Sailing School, Pontoon Moorings and Beach Cafe  
Show Bar Theatre - With Live Entertainment  
Outdoor Family Fun Zone  
Restaurant options  
Supermarket.  
Relaxation Spa - Spa Fees Available



## Room Dimensions

<b>Kitchen / Living Room</b>	3.60m (11' 10") x 5.76m (18' 11")
<b>Inner Hallway</b>	
<b>Bedroom One</b>	2.50m (8' 2") x 3.60m (11' 10")
<b>Cloakroom</b>	
<b>Bedroom Two</b>	1.69m (5' 6") x 2.50m (8' 2")
<b>Bedroom Three</b>	1.97m (6' 5") x 1.50m (4' 11")
<b>Shower Room</b>	

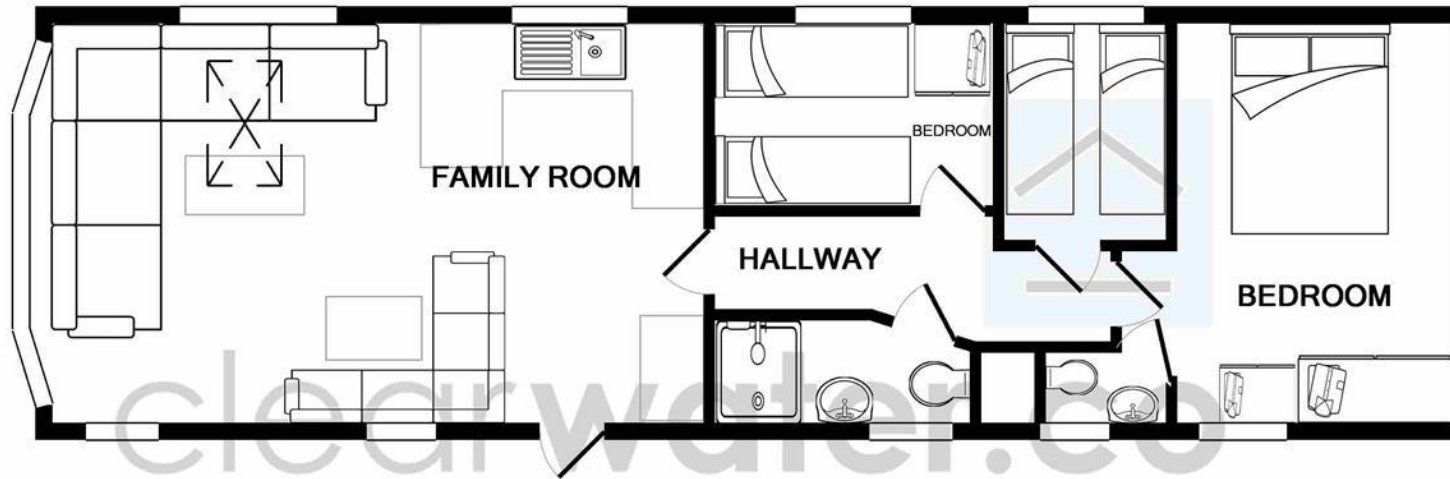

Whilst every attempt has been made to ensure the accuracy of the floor plan contained here, measurements of doors, windows, rooms and any other items are approximate and no responsibility is taken for any error, omission, or mis-statement. This plan is for illustrative purposes only and should be used as such by any prospective purchaser. The services, systems and appliances shown have not been tested and no guarantee as to their operability or efficiency can be given  
Made with Metropix ©2017

[www.clearwater.co](http://www.clearwater.co)

Sales | Rentals | Land | Finance







**Important Notice**  
Clearwater for themselves and for the Vendors of this property, whose agents they are, give notice that: 1. The particulars are intended to give a fair and substantially correct overall description for the guidance of intending purchasers and do not constitute part of an offer or contract. Prospective purchasers and lessees ought to seek their own professional advice. 2. All descriptions, dimensions, areas, reference to condition and necessary permissions for use and occupation and other details are given in good faith, and are believed to be correct, but any intending purchasers should not rely on them as statements or representations of fact, but must satisfy themselves by inspection or otherwise as to the correctness of each of them. 3. No person in the employment of Clearwater has any authority to make or give any representations or warranty in relation to this property on behalf of Clearwater, nor enter into any contract on behalf of the Vendor. 4. No responsibility can be accepted for any expenses incurred by intending purchasers in inspecting properties which have been sold, let or withdrawn.

01202 738 338

Sales | Rentals | Land | Finance



133 Penn Hill Avenue  
Penn Hill  
Poole  
Dorset  
BH14 9LY  
info@clearwater.co

