



*Moving is easy with...*

**LINLEY &  
SIMPSON**



## **SPARROW WHARF, 32 THE CALLS, LEEDS, LS2 7EW**

A WELL PRESENTED and quirky, ONE BEDROOM apartment, with JULIET style BALCONY, EXPOSED BEAMS and STRUCTURAL COLUMNS - Located on the Calls, you are moments away from the independent bars, shops and restaurants this area has to offer. CURRENTLY RENTED on a rolling basis @ £575pcm.

**Asking Price £110,000**

Linley and Simpson are proud to offer this well presented and characterful, 1 bedroom apartment.

Recently redecorated throughout and forming part of the sought after 32 The Calls development, the property offers cute and quirky accommodation - where every sqft of space is utilized.

Off the entrance hall, which features an exposed beam and structural column, is the house bathroom, double bedroom and storage/cylinder cupboard - which houses the washing machine and recently replaced water heater.

The Vendor informs us that the following charges apply:-  
Ground Rent - £50pa / Service Charge - £1,424.64pa  
There Lease runs for 125 years from 1991 = 99 years remaining

THE DEVELOPMENT

32 The Calls is a small and characterful development, located on the north bank of the River Aire. This former warehouse has been carefully converted into 32 individual, 1 and 2 bedroom apartments, all with character, including exposed beams and structural columns. Just a few minutes walk up the road and you are on Briggate, which is pedestrianised and where you will find the new Trinity centre - a shoppers paradise. Whilst across the road, you are moments away from the famous Leeds Corn Exchange.

LOUNGE / KITCHEN

This sociable open-plan living area, incorporates a cute beech effect kitchen, with grey work tops and a range of stainless steel built-in appliances - including an electric oven, halogen hob and extractor hood, as well as a free-standing fridge. Across from the kitchen is the dining and lounge area, both of which benefit from a Juliet style balcony and feature windows - both of which flood the room with light and offer views towards the Corn Exchange. In addition, the room is dominated by a huge exposed beam, complete with structural column - adding to the character of this lovely space.

BEDROOM

The bedroom is a good size for a property of this type, with 2 large feature windows, complete with deep sills, which flood the room with light - and also gives a birds eye view of the city beyond. The room allows for a double bed, single wardrobe and drawers, with the cupboard in the hallway allowing for additional storage.

HOUSE BATHROOM

The house bathroom incorporates a 3 piece white suite - with mixer shower over bath, pedestal wash hand basin and toilet.

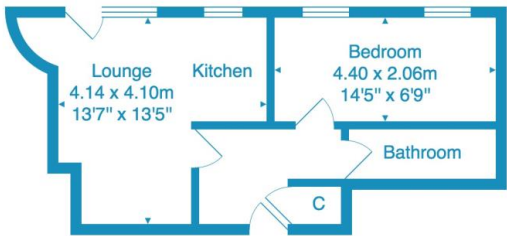

All measurements are approximate and for display purposes only.  
No liability is accepted by either the agency or Box Property Solutions Ltd as to the exact measurements of the rooms.  
Box Property Solutions Ltd retains the copyright on this plan and allows agents to use it with agreed permission.

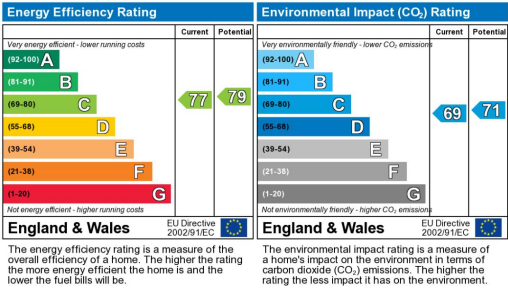

Additional Information

The Vendor informs us that the following charges apply:-  
Ground Rent - £50pa / Service Charge - £1,424.64pa  
There Lease runs for 125 years from 1991 = 99 years remaining.

AGENTS NOTES:

These brochure particulars, including photographic displays, have been prepared by Linley & Simpson Sales Ltd. No implication is made that any item is to be included in the sale by virtue of its inclusion within the photographic display. All fixtures and fittings are excluded from the sale unless included separately within the legal 'fixtures & fittings' details. All measurements are taken in imperial and are approximate. We endeavour to make all the details contained therein accurate and reliable, but they should not be relied upon as statements or representations of fact. Descriptions of appliances, services, systems, fittings and equipment should not be taken as guarantee that they are in working order, they have not been tested (unless stated) and no warranty can be given as to their condition. These particulars do not constitute any part of an offer or contract and we strongly recommend the details should be verified by any prospective purchaser or their advisors, by inspection of the property.