

Ground Floor

Approx. 29.2 sq. metres (314.7 sq. feet)

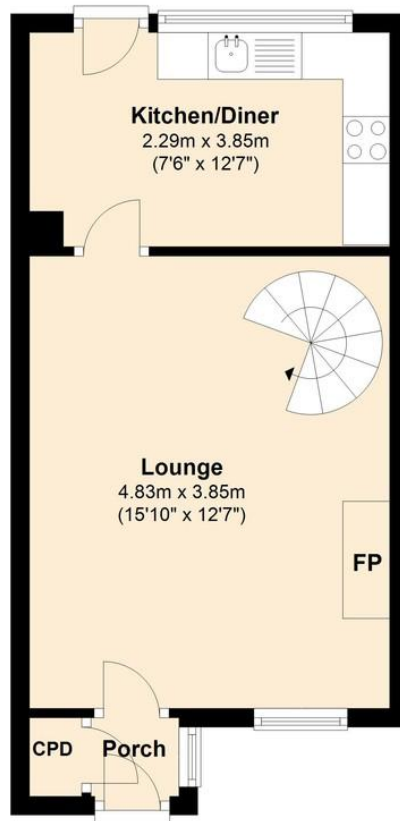

First Floor

Approx. 27.7 sq. metres (297.8 sq. feet)

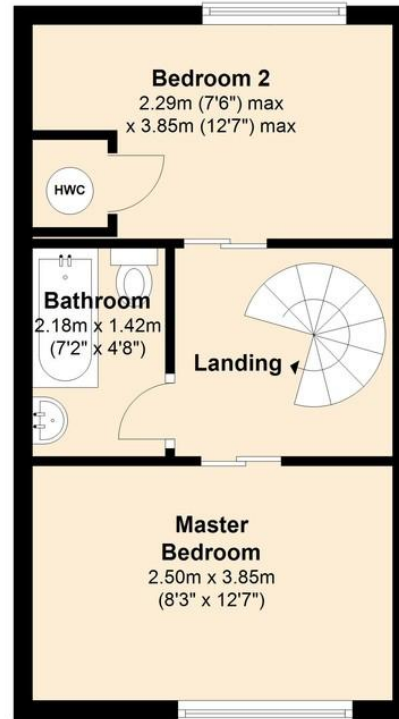

Total area: approx. 56.9 sq. metres (612.5 sq. feet)

OUTSIDE

The front garden is laid to shingle and measures approx 12' x 5' with a path leading to the entrance porch.

External access to the southerly facing rear garden is via a shared alleyway which runs behind the terraced properties and through a wooden gate to the rear of the garden. We have been advised there is allocated tandem parking to the left hand side of the row of terraces.

The rear garden measures approx 26' x 13' and is laid to shingle with a 'stepping stone' path to the rear access gate and storage shed. A wooden decking area abuts the house.

EPC Current 56 Potential 92



01603 760 770
hello@dragonflylettings.com
www.dragonflylettings.com
Unit 4 Dragonfly Lane, Cringleford, Norfolk, NR4 7FF

Whilst we have endeavoured to ensure these details are a fair and accurate representation of the property at the point of listing, please note that they are for guidance purposes only and we do not seek advice from or liaise with management companies, planning departments or building control in their preparation. We strongly advise that you inspect the property and surrounding area on Google maps and street view prior to viewing. Please also note the photographs do not infer that items shown are included, the measurements quoted are approximate and the fixtures, fittings and appliances have not been tested, therefore no guarantee can be given that they are in working order. If there is any point which is of particular importance to you then please obtain professional confirmation of it.



Attractively laid out 2 bed mid terrace property in the popular suburb of Eaton, to the south west of Norwich. Features a good-sized lounge with feature fireplace and spiral staircase, modern kitchen/diner, 2 double bedrooms and allocated tandem ORP. Internal viewing highly recommended. Available March!

84 Amdersley Drive

| Norwich | Norfolk | NR4 6JH

£695 pcm

Attractive mid terraced house in the popular suburb of Eaton

2 double bedrooms, 1 with built-in storage

Good-sized lounge with modern electric fire in an attractive surround

Feature spiral staircase leading to first floor

Kitchen/diner with modern cream high gloss units, built-in oven and hob

UPVC double glazing and newly fitted gas central heating

Low maintenance, neat courtyard-style rear garden

Allocated off road tandem parking

Applicants with cats may be considered at this property

Available March

