



James *J* LaurenceTM
Sales and Lettings

216 SELSEY ROAD, BIRMINGHAM, WEST MIDLANDS, B17
8JN
OFFERS OVER £130,000





A superb opportunity to purchase this two bedroom mid terrace home within Edgbaston.

The property boasts porch entrance leading to front facing living room, with separate dining room. A well proportioned kitchen with door to garden completes the downstairs layout.

Upstairs the two double bedrooms are complemented by a spacious bathroom complete with corner bath. Further features includes double glazing, gas central heating and private rear garden/courtyard. Parking is conveniently available on the street.

Buyers should take note as further cosmetic upgrades would make for a fantastic first home, whilst also a sound buy to let proposition in a buoyant local rental marketplace.

The area itself lends itself to professionals wanting a short commute to the city centre, with excellent road and transport links. Likewise, it offers excellent proximity to amenities of Edgbaston and Harborne, not to mention an attraction to young families being within catchment for good local schooling

A must see property.

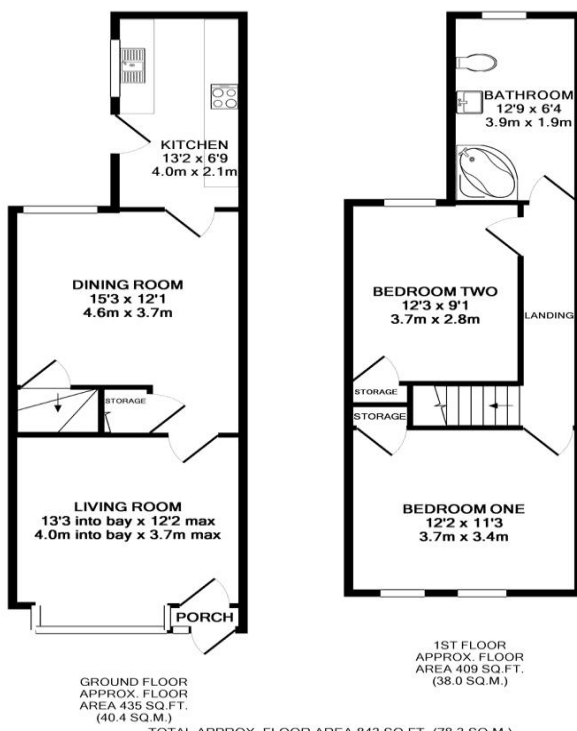

Whilst every attempt has been made to ensure the accuracy of the floor plan contained here, measurements of doors, windows, rooms and any other items are approximate and no responsibility is taken for any error, omission, or mis-statement. This plan is for illustrative purposes only and should be used as such by any prospective purchaser. The services, systems and appliances shown have not been tested and no guarantee as to their operability or efficiency can be given
Made with Metropix ©2017

