



MILE



Purves Road, Kensal Green NW10

£2,250 pcm

Mile are delighted to introduce to the market this very impressive garden apartment within the ground floor of this lovely Victorian conversion situated in the heart of Kensal Rise and within the catchment area of the famous Princess Frederica School.

EPC Rating: D

- Superb garden apartment
- Two double bedrooms
- Beautiful 25ft garden
- Newly refurbished
- Available mid August
- Offered unfurnished
- Superb 25ft lounge / kitchen / diner
- Double glazed windows
- Fantastic location
- Close to shops and transports

PURVES ROAD

Approximate Gross Internal Area 590 sq ft / 54.8 sq m

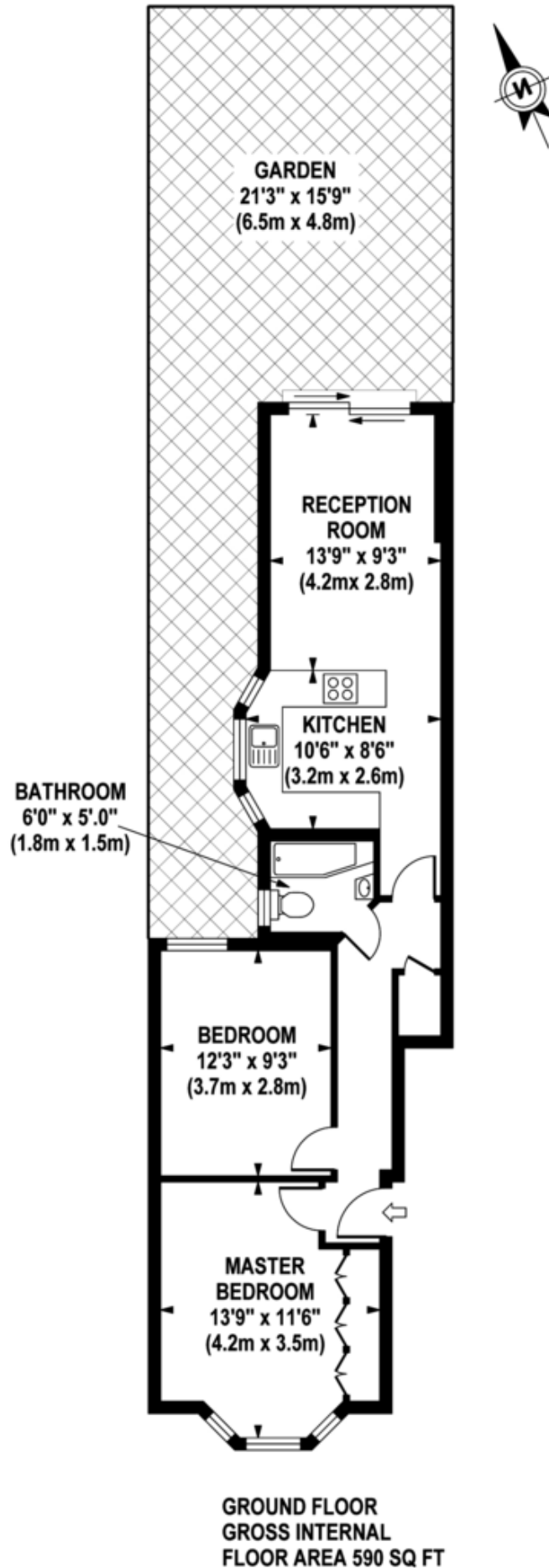

MONEY LAUNDERING REGULATIONS 2003: Intending purchasers will be asked to produce identification documentation at a later stage and we would ask for your co-operation in order that there will be no delay in agreeing the sale.

General: While we endeavour to make our sales particulars fair, accurate and reliable, they are only a general guide to the property and, accordingly, if there is any point which is of particular importance to you, please contact the office and we will be pleased to check the position for you, especially if you are contemplating travelling some distance to view the property.

Measurements: These approximate room sizes are only intended as general guidance. You must verify the dimensions carefully before ordering carpets or any built-in furniture.

Services: Please note we have not tested the services or any of the equipment or appliances in this property, accordingly we strongly advise prospective buyers to commission their own survey or service reports before finalising their offer to purchase.