

www.madisonbrook.com



MADISON BROOK INTERNATIONAL



MADISON BROOK INTERNATIONAL

1 Tidal Basin Road, London, E16 1US
Two Bedroom Apartment - £2,100 pcm

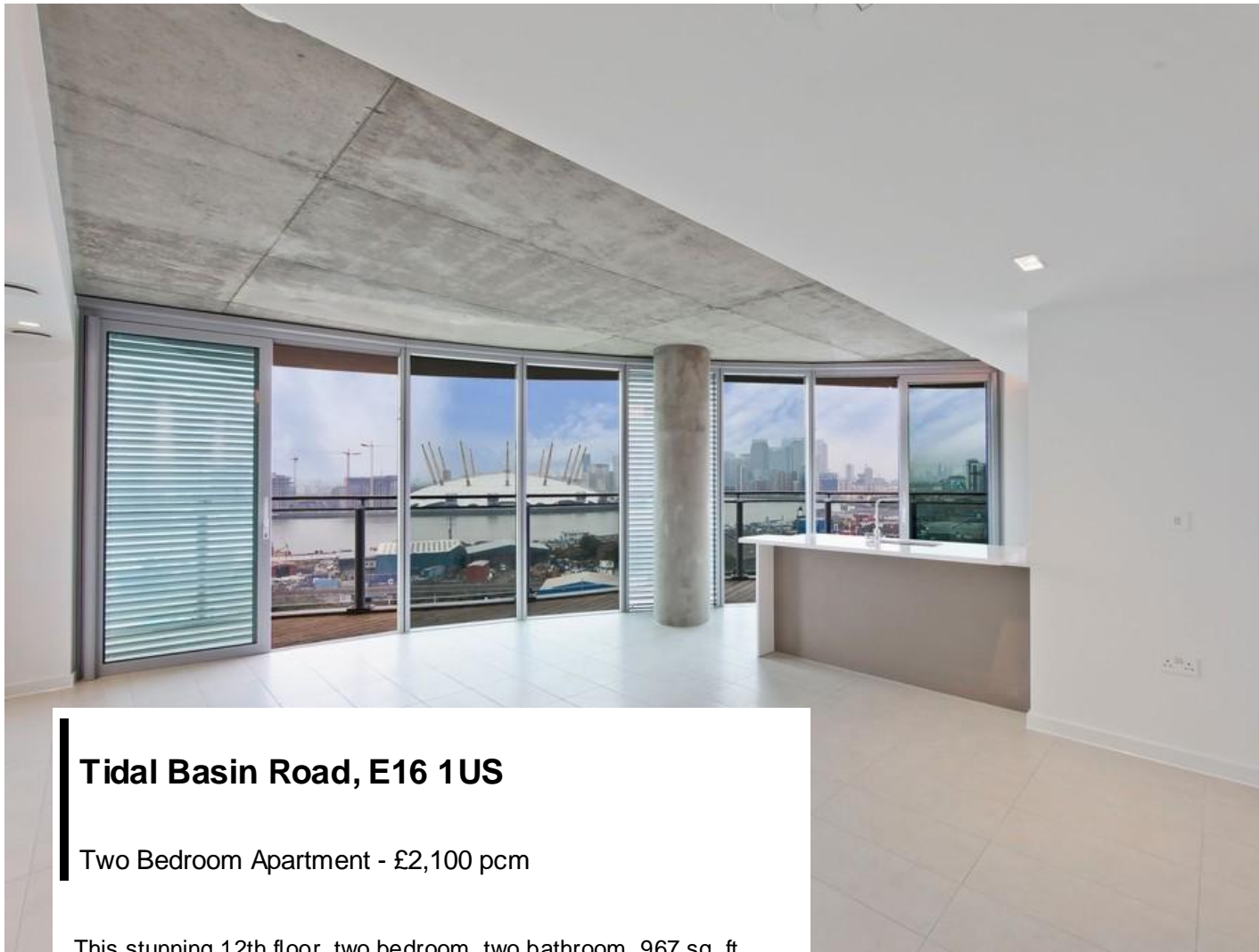

Tidal Basin Road, E16 1US

Two Bedroom Apartment - £2,100 pcm

This stunning 12th floor, two bedroom, two bathroom, 967 sq. ft. apartment is available on a furnished basis and is looking directly over Canary Wharf & O2 Arena.

Featuring floor-to-ceiling windows to the open-plan lounge/kitchen, with integrated appliances, double bedroom, master bathroom & additional en-suite, utility cupboard & sizeable private terrace. This development also boasts a private residents gymnasium & 24hr concierge.

Hoola Development is located in the stunning surrounds of Excel Marina, just moments from the Emirates Cable Car, Siemens Crystal & O2 Arena. Royal Victoria (DLR) & Canning Town (Jubilee) are within easy reach, connecting to the City of London & Canary Wharf.

KEY FEATURES

- Two Bedroom Apartment
- 12th Floor Location
- 967 Sq. Ft. Internally
- Private Balcony
- Close to Royal Victoria DLR
- Available 15th February 2020
- 24 Hour Concierge
- Residents Gymnasium

Local Authority
Council Tax Band

Newham London Borough Council
D

Tidal Basin Road

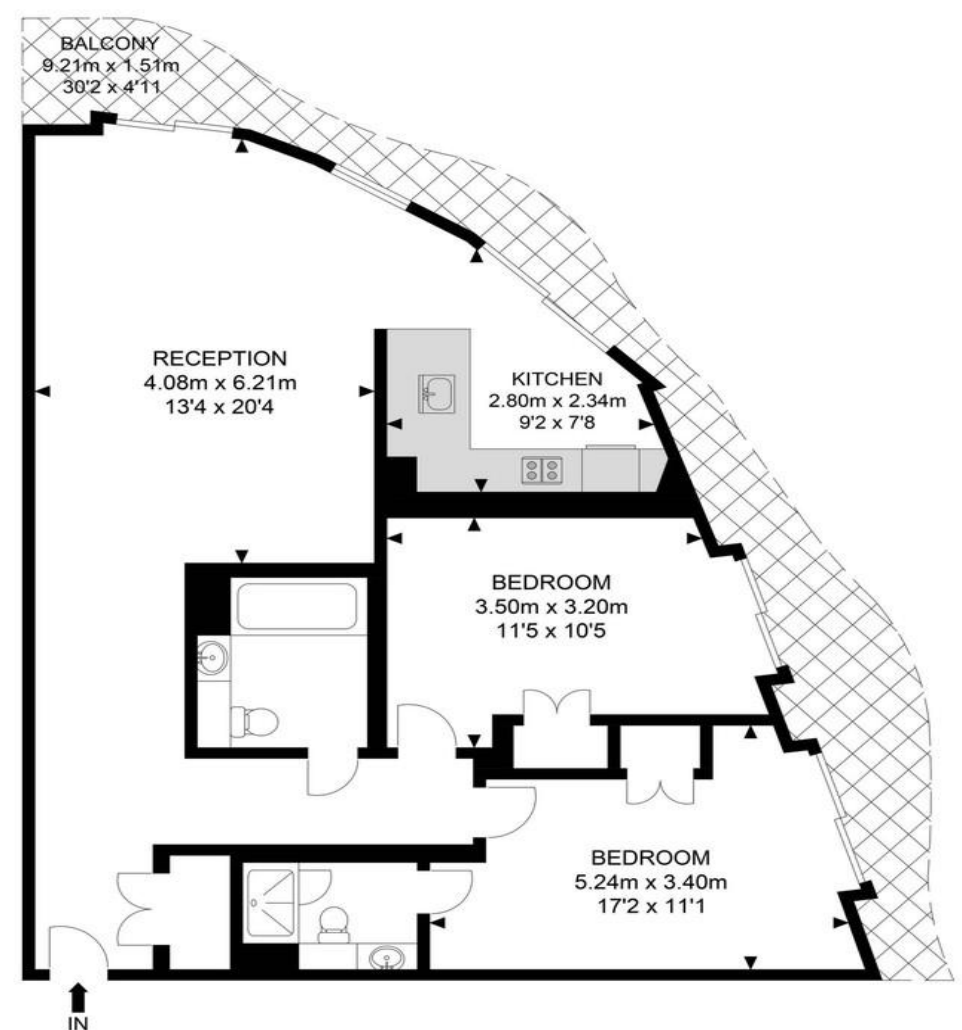

12th Floor

APPROX. GROSS INTERNAL FLOOR AREA 966.27 SQ FT / 89.77 SQM

Whilst every attempt has been made to ensure the accuracy of the floor plan contained here, measurements of doors, windows, rooms and any other items are approximate and no responsibility is taken for any error, omission or mis-statement. This plan is for illustrative purposes only and should be used as such by any prospective purchaser. The service, system and appliances shown have not been tested and no guarantee as to their operability or efficiency can be given.

© SpacePhoto
Photography and Floor Plan

Madison Brook
Docklands
20 Western Gateway,
London, E16 1BS

docklands@madisonbrook.com
020 3946 6000

We have prepared these property particulars as a general guide to a broad description of the property. They are not intended to constitute part of an offer or contract. We have not carried out a structural survey and the services, appliances and specific fittings have not been tested. All photographs, measurements, floorplans and distances referred to are given as a guide only and should not be relied upon for the purchase of carpets or any other fixtures or fittings. Lease details, service charges and ground rent (where applicable) and council tax are given as a guide only and should be checked and confirmed by your Solicitor prior to exchange of contracts. The copyright of all details, photographs and floorplans remain exclusive to Madison Brook International.

MADISON BROOK
INTERNATIONAL