



NET
LETTINGS
.COM

Flat 14, Vibeca Apartments, Chicksand Street

- Ultra Chic Private Development
- Open Plan Kitchen/Lounge
- Double Bedrooms
- Modern Neutral Decor

£2,300 pcm Fees Apply



1



2



1





Property Description

%full_description_title[b,br,#0a3646]_dim[ij]%



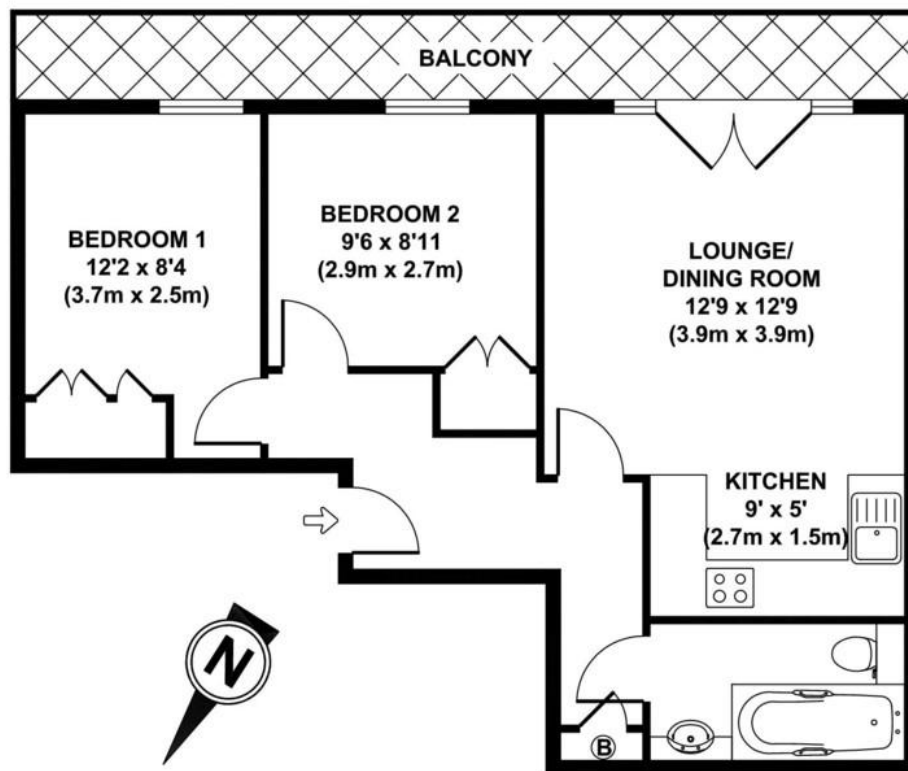

CHICKSAND STREET

APPROX. GROSS INTERNAL FLOOR AREA 628 SQ FT / 58.3 SQ M

Whilst every attempt has been made to ensure the accuracy of the floorplan, maximum room measurements are taken for representation / illustrative purposes only and should be used as such by any prospective purchaser. Compliant with RICS code of measuring practice.



Viewings

By Appointment only

Council Tax Band

Band D

Local Authority

Tower Hamlets London Borough Council

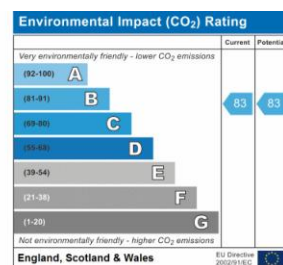
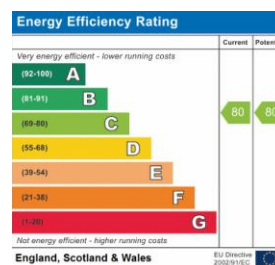

Registered Office

Suite C, 36-40 Copperfield Road, London,
E3 4RR /08050057

Find us on   

www.netlettings.com

management@netlettings.com

020 8981 5551

mydeposits.co.uk



rightmove
find your happy

Zoopla.co.uk  **PrimeLocation**



Agents Note: Whilst every care has been taken to prepare these particulars, they are for guidance purposes only. All measurements are approximate and are for general guidance purposes only and whilst every care has been taken to ensure their accuracy, they should not be relied upon and potential tenants are advised to recheck the measurements.