



30 Clovis Duveau Drive, Dundee, DD2 5JB



NEXT HOME™
ESTATE & LETTINGS AGENTS

Offers Over £139,950



Next Home are delighted to bring to the market this deceptively spacious 2 BEDROOM THIRD FLOOR APARTMENT located in the highly sought after area of the West End of Dundee.

This well maintained property comprises of: entrance hall, generous sized lounge/diner, immaculately maintained kitchen, two good sized double bedrooms and a family bathroom. There is gas central heating and double glazing throughout.

Externally the property benefits from a communal drying area and an allocated parking space as well as visitors parking is available.

Early viewings are highly recommended as this property is sure to be popular due to the quality and quantity of accommodation on offer.

AREA

The property is situated within a popular residential cul de sac area in the West End of the City of Dundee, close to the A90 and within walking distance of Ninewells Hospital. It is within close proximity of the city centre which offers a range of excellent local amenities including shops, restaurants, pubs, recreational facilities and bus and train stations. There is also primary and secondary schools close by.

ENTRANCE HALL

12' 9" x 3' 5" (3.89m x 1.04m)

The entrance hall provides access to all accommodation on offer. Laminate floor covering. Large built in storage cupboard.

KITCHEN

17' 3" x 7' 6" (5.26m x 2.29m)

This well maintained kitchen is fitted with a range of wooden wall and base units with contrasting work surfaces and complementary tiling between. Integrated oven with four ring gas hob and extractor. One and a half bowl sink and drainer unit. Space for washing machine. Large built in cupboard, with space for fridge/freezer. Quarry tiled floor and inset lighting to the ceiling.

LOUNGE/DINING ROOM

17' 2" x 16' 9" (5.23m x 5.11m)

A generous sized public room with window to the side and rear allowing natural light to flood the room. Laminate flooring. Ample space for free standing furniture including dining table and chairs. Inset LED lighting and coricing to the ceiling. There are two radiators within the room.

BEDROOM 1

17' 9" x 9' 1" (5.41m x 2.77m)

A good sized double bedroom with window to the side. Large built in wardrobe with hanging rail and shelving finished with mirrored sliding doors. Access to a good sized storage cupboard within the eaves. The room is carpeted and contains a radiator.



BEDROOM 2
19' 7" x 7' 8" (5.97m x 2.34m)

A second good sized double bedroom with window to the rear. Built in wardrobe with mirrored sliding doors. The room is fitted with a radiator and is carpeted.

BATHROOM
9' 2" x 8' 7" (2.79m x 2.62m)

An immaculately maintained bathroom fitted with a three piece suite comprising of: W.C., wash hand basin with storage under and bath with shower over and glazed screen. The room is laid with Quarry tiles and fitted with a radiator.

EXTERNAL

Externally the property benefits from meticulously maintained garden grounds. There is a communal drying area to the rear and an allocated parking space and visitor parking is available.



FINANCIAL SERVICES

Next Home Mortgages offers a range of mortgage, financial and insurance services.

With Award Winning Advisors based throughout Perthshire offering:

- Access to all Lenders
- Exclusive Rates Not Available on The High Street
- Save £1,000s on your current Mortgage

Unlike the Banks we are available 7 days a week!

Call us now on 01738 45 90 69.

LEGAL SERVICES

In association with Next Home, Next Law are a dynamic, forward thinking law firm providing a range of legal services to clients from offices based throughout Perthshire.

Put your trust in them to advise on:

- Residential Conveyancing and Property Law
- Family Law
- Charity Law
- Wills, Trusts and Executries

Next Law = Modern thinking, traditional values.

Call now for legal advice on 01738 70 72 74



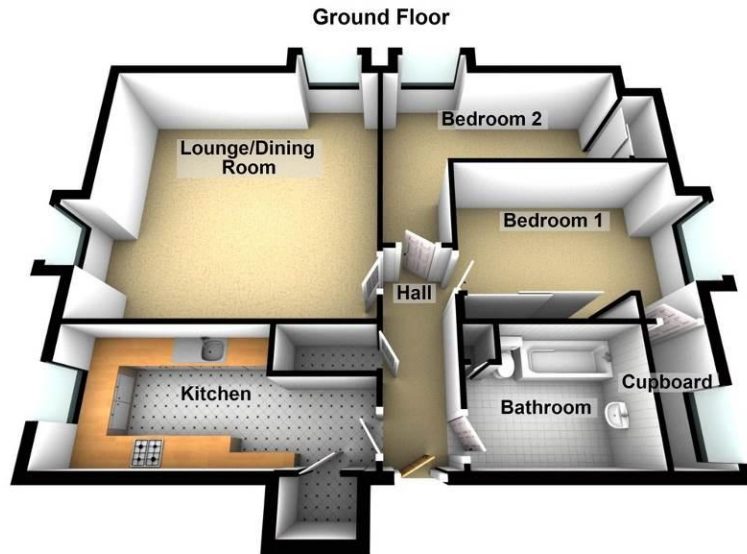

Valuation on your own property

Valuation on your own property: If you would like to know how much your property might achieve in today's market, we are pleased to offer a free market appraisal with no obligation. We are now available 7 days till 9pm - just call 01738 444342 to arrange an appointment.

www.nexthomeonline.co.uk

Next Home Estate Agents
63 – 65 George Street, Perth – 01738 44 43 42
41 – 43 Allan Street, Blairgowrie – 01796 54 80 14
21 Atholl Road, Pitlochry – 01796 54 80 14
1a James Square, Crieff – 01764 65 00 44
211 High Street, Auchterarder – 01764 66 36 66
Email: sales@nexthomeonline.co.uk

Please Note:
These particulars whilst believed to be accurate are set out as a general outline only for guidance and do not constitute any part of an offer or contract intending, purchasers should not rely on them as statements or representations of fact, but must satisfy themselves by inspection or otherwise as to their accuracy. No person in this firm's employment has the authority to make or give representation or warranty in respect of the property. All room sizes are approximate and for general guidance only. They cannot be relied upon for fitting carpets, furniture etc.