



Zenith Close, London NW9

£1,200pcm

*** Sole Agents ***

Mile is delighted to offer this charming large one bedroom maisonette set on the first floor of this prestigious modern development. The apartment comprises a large open plan kitchen reception with a modern integrated kitchen, wood flooring and patio doors onto a private terrace, large modern three piece tiled bathroom and a large bedroom with built in wardrobes. Other benefits include large cupboards with ample storage, under floor heating and a allocated underground gated parking space. Zenith Close is located on the corner of Colindeep Lane and Edgware Road within easy walking distance of Morrisons, Asda and Bang Bang oriental food hall and Colindale (Northern line) station.

- Large one bedroom maisonette
- Large open plan kitchen/reception
- Private patio area
- Underground gated parking space
- Excellent condition
- Walking distance to Supermarkets
- Walking distance to station
- Own entrance
- Under floor heating
- Available NOW!

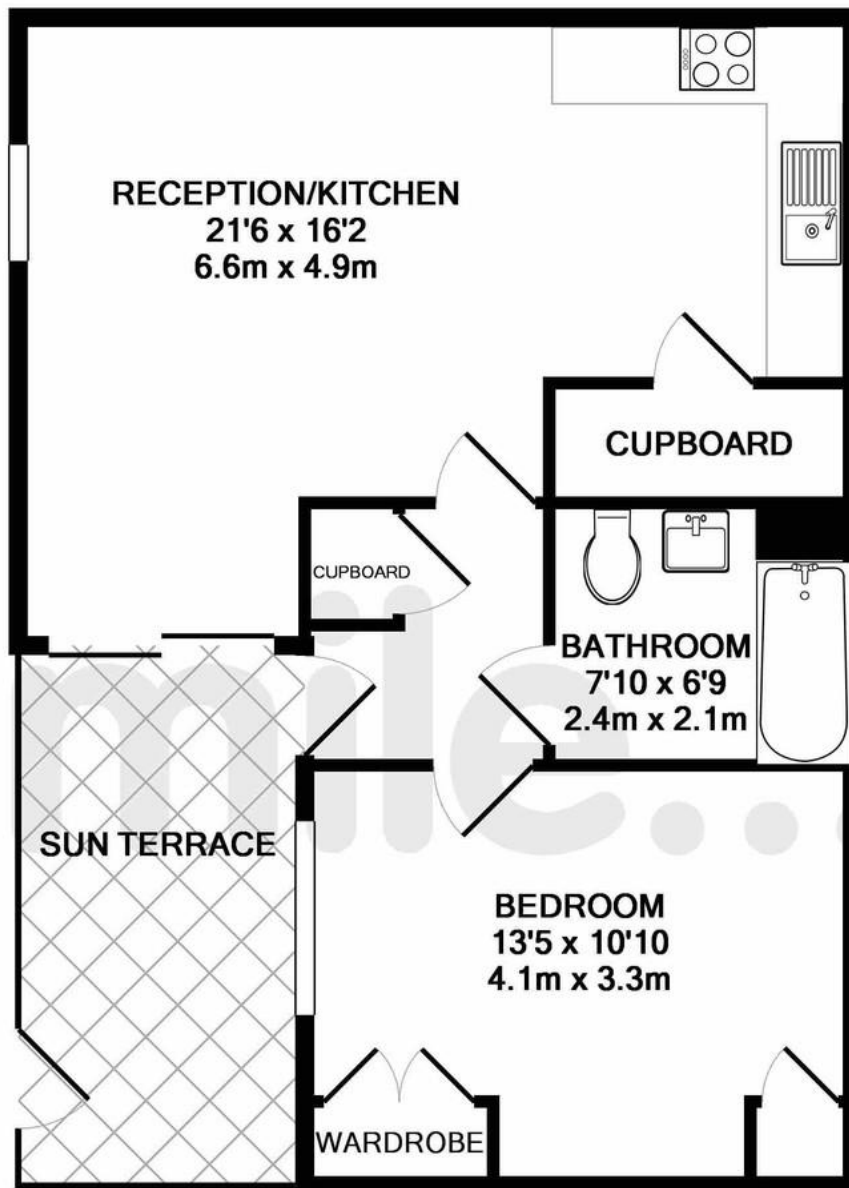

TOTAL APPROX. FLOOR AREA 540 SQ.FT. (50.2 SQ.M.)

Whilst every attempt has been made to ensure the accuracy of the floor plan contained here, measurements of doors, windows, rooms and any other items are approximate and no responsibility is taken for any error, omission, or mis-statement. This plan is for illustrative purposes only and should be used as such by any prospective purchaser. The services, systems and appliances shown have not been tested and no guarantee as to their operability or efficiency can be given

Made with Metropix ©2018

MONEY LAUNDERING REGULATIONS 2003: Intending purchasers will be asked to produce identification documentation at a later stage and we would ask for your co-operation in order that there will be no delay in agreeing the sale.

General: While we endeavour to make our sales particulars fair, accurate and reliable, they are only a general guide to the property and, accordingly, if there is any point which is of particular importance to you, please contact the office and we will be pleased to check the position for you, especially if you are contemplating travelling some distance to view the property.

Measurements: These approximate room sizes are only intended as general guidance. You must verify the dimensions carefully before ordering carpets or any built-in furniture.

Services: Please note we have not tested the services or any of the equipment or appliances in this property, accordingly we strongly advise prospective buyers to commission their own survey or service reports before finalising their offer to purchase.