



Cedars Way,
Winterbourne, Bristol, BS36 1HZ

Price: OIEO £236,000

Property Features

- Terraced House
- Three Bedrooms
- Cloakroom
- 21' Kitchen/Breakfast Room
- Off Street Parking
- Double Glazing
- Cul De Sac Location
- No Onward Chain

Full Description

PORCH

Double glazed windows to the front and side.

ENTRANCE HALL

Stairs rising to the first floor landing, under stairs storage cupboard, built in storage cupboard.

CLOAKROOM

Double glazed obscure window to the front, low level w.c., wall mounted wash hand basin, radiator.

LOUNGE

12' 4" x 11' 4" (3.76m x 3.45m)

Double glazed window to the front, textured ceiling, telephone point, television point.

KITCHEN/DINING ROOM

21' 6" x 8' 8" (6.55m x 2.64m)

Two double glazed windows to the rear, double glazed door to the rear, fitted with a range of wall and base units with roll edge work-surfaces over, integrated dishwasher, stainless steel single drainer sink unit with mixer tap over, tiled splash-backs, built in double electric oven and electric hob with extractor over, extractor, radiator.

LANDING

Access to the loft space (partially boarded with ladder and light).

BEDROOM ONE

12' 4" x 11' 4" (3.76m x 3.45m)

Double glazed window to the front, radiator, textured ceiling.



BEDROOM TWO

11' 5" x 8' 8" (3.48m x 2.64m)

Double glazed window to the rear, radiator, textured ceiling.

BEDROOM THREE

8' 9" x 6' 9" (2.67m x 2.06m)

Double glazed window to the rear, radiator, built in airing cupboard housing boiler.

BATHROOM

Double glazed obscure window to the front, low level w.c., pedestal wash hand basin, 'P' shape bath with shower attachment over, built in storage cupboard, tiled splash-backs, heated towel rail.

REAR GARDEN

Mainly paved with raised borders, brick built shelf.

FRONT

Area providing off street parking in front of property.



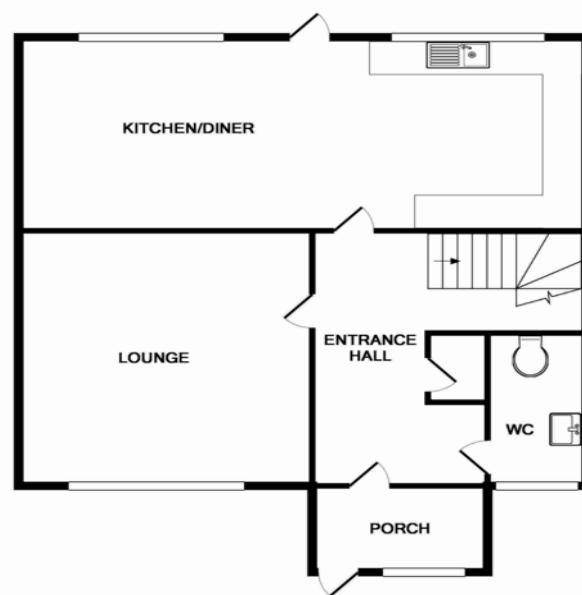
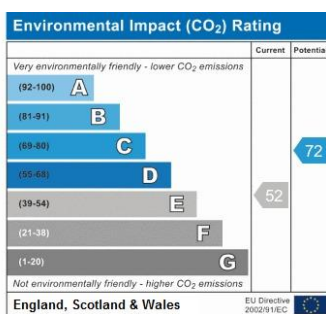
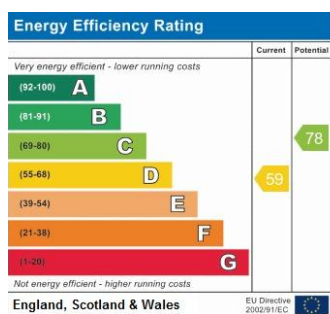

GROUND FLOOR



1ST FLOOR

Measurements are approximate. Not to scale. Illustrative purposes only
Made with Metropix ©2018

4 Flaxpits Lane
Winterbourne
Bristol
Avon
BS36 1JX

www.aj-homes.co.uk
info@aj-homes.co.uk
01454 252140

Agents Note: Whilst every care has been taken to prepare these sales particulars, they are for guidance purposes only. All measurements are approximate are for general guidance purposes only and whilst every care has been taken to ensure their accuracy, they should not be relied upon and potential buyers are advised to recheck the measurements