



## Segrave Road | Milehouse | Plymouth | PL2 3DP

Guide £400,000

A recently extended and re-furbished semi-detached family home.

This property has undergone a complete make over and now offers five/six double bedrooms, two formal reception rooms as well as a large family kitchen dining room and three bathrooms.

Upon inspection you will find a spacious entrance hall, lounge, dining room, family kitchen and cloakroom on the ground floor. Two double bedrooms, family bathroom and large master suite on the first floor. Whilst the second floor offers two further double rooms and an additional bathroom.

Outside there's driveway parking leading to a single garage and garden to the front, whilst the enclosed rear garden benefits from patio, lawn and summer house.

- Extended Semi Detached House
- Five / Six Double Bedrooms
- Three Bathrooms
- Re-furbished Throughout
- Gas Central Heating System
- Upvc Double Glazing
- Newly Decorated



GROUND FLOOR  
APPROX. FLOOR  
AREA 1384 SQ. FT.  
(127.6 SQ. M.)



1ST FLOOR  
APPROX. FLOOR  
AREA 1041 SQ. FT.  
(96.7 SQ. M.)

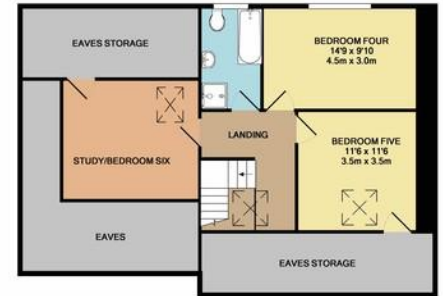

2ND FLOOR  
APPROX. FLOOR  
AREA 1007 SQ. FT.  
(93.5 SQ. M.)

TOTAL APPROX. FLOOR AREA 3299 SQ. FT. (305.8 SQ. M.)  
While every attempt has been made to ensure the accuracy of the floor plan contained herein, measurements of rooms, windows, doors and any other items are approximate and no responsibility is taken for any error, omission, or misstatement. This plan is for illustrative purposes only and should be used as such by any prospective purchaser. The services, systems and appliances shown have not been tested and no guarantee as to their operability or efficiency can be given.  
Made with Metagen 02/18

## Contact Details

48 Ebrington Street  
Plymouth  
Devon  
PL4 9AD

www.athomelettings.com  
info@athomeproperty.co.uk  
01752 777070

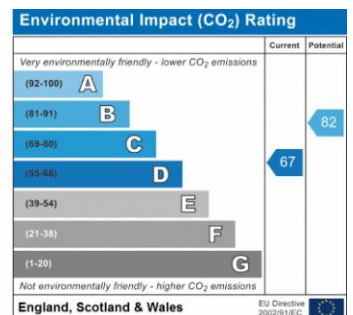
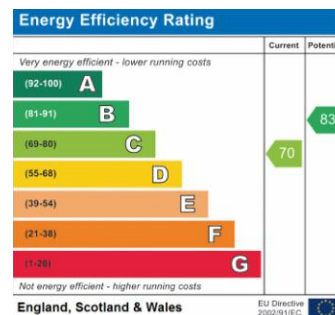

Agents Note: Whilst every care has been taken to prepare these sales particulars, they are for guidance purposes only. All measurements are approximate are for general guidance purposes only and whilst every care has been taken to ensure their accuracy, they should not be relied upon and potential buyers are advised to recheck the measurements