



**Down Road,  
Winterbourne Down, Bristol, BS36 1BN**

**Price: £235,000**



# Property Features

---

- Two Bedroom Maisonette
- Village Location
- Stunning Views
- Cloakroom & Bathroom
- Open Plan Living
- Oak & Wrought Iron Stair Case
- Converted Circa 2014
- A Must See

## Full Description

---

If you are looking for a property that's a little bit different this ones for you. This two bedroom maisonette is situated in the popular village of Winterbourne Down. It offers an open plan kitchen /living room, two bedrooms and a bathroom. The property also has off street parking and is beautifully presented. Call us on 01454 252140 to avoid disappointment.

### CLOAKROOM

With low level w/c, hand wash basin with vanity units under, towel radiator and extractor fan.

### BEDROOM TWO

11' 4" x 9' 5" narrowing to 5'07" (3.45m x 2.87m)

Double glazed window to side and TV point.

### KITCHEN/LIVING ROOM

19' 10" max x 11' 4" (6.05m x 3.45m)

Two double glazed window to rear with far reaching views. The kitchen comprises of a range of wall and base units with integrated dishwasher fridge and freezer and wine fridge. Electric oven with hob and extractor over. Sink with drainer and mixer tap. Splash backs. Two TV points and oak and metal spiral stair case to first floor landing. Two radiator and utility cupboard housing plumbing for washing machine.

### MASTER BEDROOM

17' 4" x 10' 2" (5.28m x 3.1m) x 12'10" narrowing to 9'1" (3.91m x 2.77)

Stunning double glazed cabrio Velux window to rear with Stunning views. Eaves storage cupboard, radiator and cupboard housing hot water tank.



## BATHROOM

Double glazed velux window. Suite comprising of a panelled bath with mixer tap and shower attached. low level w.c with hidden cistern. Hand wash basin with mixer tap and vanity under, part tiled walls and heated towel radiator.

## PARKING

Off street parking for one car.

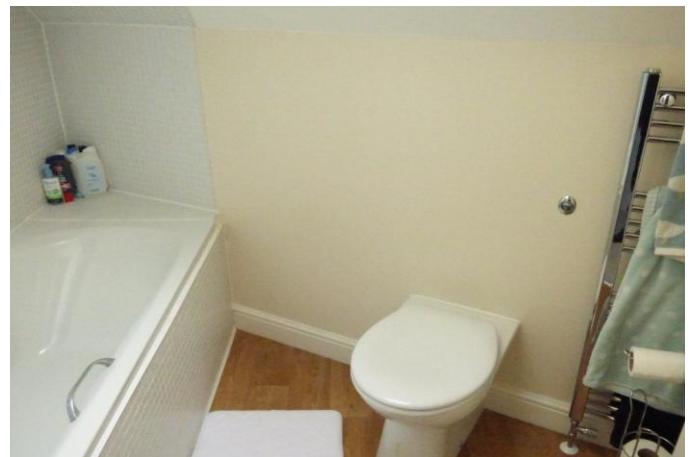



GROUND FLOOR

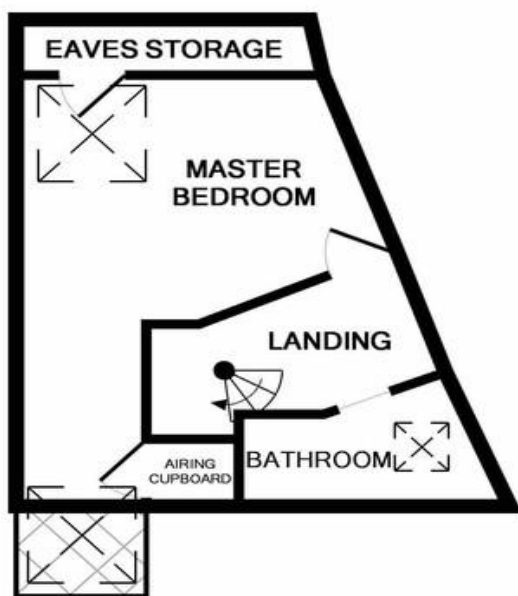

1ST FLOOR

4 Flaxpits Lane  
Winterbourne  
Bristol  
Avon  
BS36 1JX

[www.aj-homes.co.uk](http://www.aj-homes.co.uk)  
[info@aj-homes.co.uk](mailto:info@aj-homes.co.uk)  
01454 252140

Agents Note: Whilst every care has been taken to prepare these sales particulars, they are for guidance purposes only. All measurements are approximate are for general guidance purposes only and whilst every care has been taken to ensure their accuracy, they should not be relied upon and potential buyers are advised to recheck the measurements