

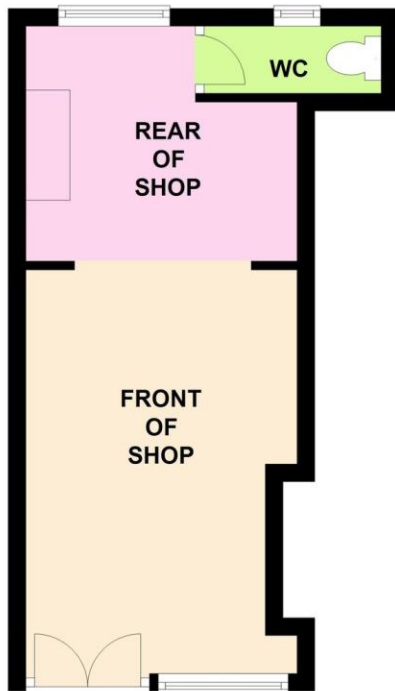

3 TOWN PIER, GRAVESEND, KENT, DA11 0BJ  
PRICE: £11,000 PER ANNUM





## RENT

£11,000 PER ANNUM exclusive of VAT.

## LOCATION DESCRIPTION

Located just off the one-way system in Gravesend Town Centre, within 0.25 miles of Gravesend Station. Part of Gravesend's historic riverfront and iconic town pier at the front of the High Street and Gravesend's Heritage Quarter.

## PROPERTY DESCRIPTION

A period shop of 23 sq mtrs (248 sq ft) with a shop front of 3.07 metres (10 feet). The shop is divided into two sections, open plan to each other, with full air conditioning system and WC.

## CURRENT BUSINESS RATES

The Valuation Office website shows a current rateable value of £2,075 per annum as at 28/2/2018 which normally means that between 40% to 50% of this figure is payable. Interested parties are advised to seek clarification from the local authority in respect of small business rates relief.

## CURRENT CLASS OF BUSINESS

Interested parties are advised to seek clarification of permitted use from the local authority.

### Commercial Estate Agents

- Acting for all clients across the commercial spectrum from industrial estates, shopping centres through to single shops, yards and single offices.
- North-West Kent's leading Commercial Estate and Leasing Agency
- Assess TODAY whether you are getting the best returns on your property
- Have a FREE valuation of your commercial property for sale or to let

**To arrange your free market appraisal from a fully regulated agency – CALL US ON – 01474 369368  
or email: [commercial@sealeys.co.uk](mailto:commercial@sealeys.co.uk)**