



5 Pitfour Street, Dundee, DD2 2NT



NEXT HOME™
ESTATE & LETTINGS AGENTS

Offers Over £80,000



Next Home are delighted to bring to the market this 2 BEDROOM GROUND FLOOR APARTMENT situated within walking distance of Dundee city centre.

This deceptively spacious apartment comprises: entrance hall, open plan lounge/kitchen together with two good sized double bedrooms and bathroom. There is gas central heating and double glazing throughout.

Externally the property benefits from on street parking and a communal drying area to the rear.

Early viewing is highly recommended as this is a perfect first time buy or investment property.

AREA

The property is situated within a popular residential area within a short walking distance of the university and is within close proximity of the city centre which offers a range of excellent local amenities including shops, restaurants, pubs, recreational facilities and bus and train stations. There is also Primary and Secondary schools close by.

ENTRANCE HALL

10' 7" x 4' 7" (3.23m x 1.4m)

Accessed from the communal hallway, the entrance hall provides access to all accommodation on offer. Tiled floor covering. Neutral décor. Radiator.

OPEN PLAN LOUNGE/KITCHEN

18' 0" x 14' 10" (5.49m x 4.52m)

A bright and spacious open plan area which is fitted with a range of wooden wall and base units with contrasting work surfaces and tiling between. 1 1/2 bowl stainless steel sink and drainer unit. Four ring gas hob. Integrated fridge/freezer. Space for washing machine. Ample space for a range of informal dining furniture together with copious amounts of room for living furniture. Tiled flooring. Neutral décor. Radiator. Large built in cupboard. Window to the rear.

BEDROOM 1

13' 2" x 7' 1" (4.01m x 2.16m)

A good sized double bedroom with front facing window. Ample room for a range of free standing bedroom furniture. Recessed alcove with shelving. Laminate flooring. Radiator.



BEDROOM 2

11' 11" x 8' 11" (3.63m x 2.72m)

Another spacious double bedroom with window to the front. Neutral décor. Laminate flooring. Radiator.

BATHROOM

8' 1" x 5' 6" (2.46m x 1.68m)

Fitted with a three piece white suite comprising: W.C., pedestal wash hand basin and bath with shower over. Heated ladder towel rail. Fully tiled with decorative tile border. Complementary tiled floor. Extractor fan.

EXTERNAL

To the front of the property on street parking is available and to the rear there is a communal drying area.

PLEASE NOTE All furniture is included in the sale.



FINANCIAL SERVICES

Next Home Mortgages offers a range of mortgage, financial and insurance services.

With Award Winning Advisors based throughout Perthshire offering:

- Access to all Lenders
- Exclusive Rates Not Available on The High Street
- Save £1,000s on your current Mortgage

Unlike the Banks we are available 7 days a week!
Call us now on 01738 45 90 69.

LEGAL SERVICES

In association with Next Home, Next Law are a dynamic, forward thinking law firm providing a range of legal services to clients from offices based throughout Perthshire.

Put your trust in them to advise on:

- Residential Conveyancing and Property Law
- Family Law
- Charity Law
- Wills, Trusts and Executries

Next Law = Modern thinking, traditional values.
Call now for legal advice on 01738 70 72 74





Ground Floor

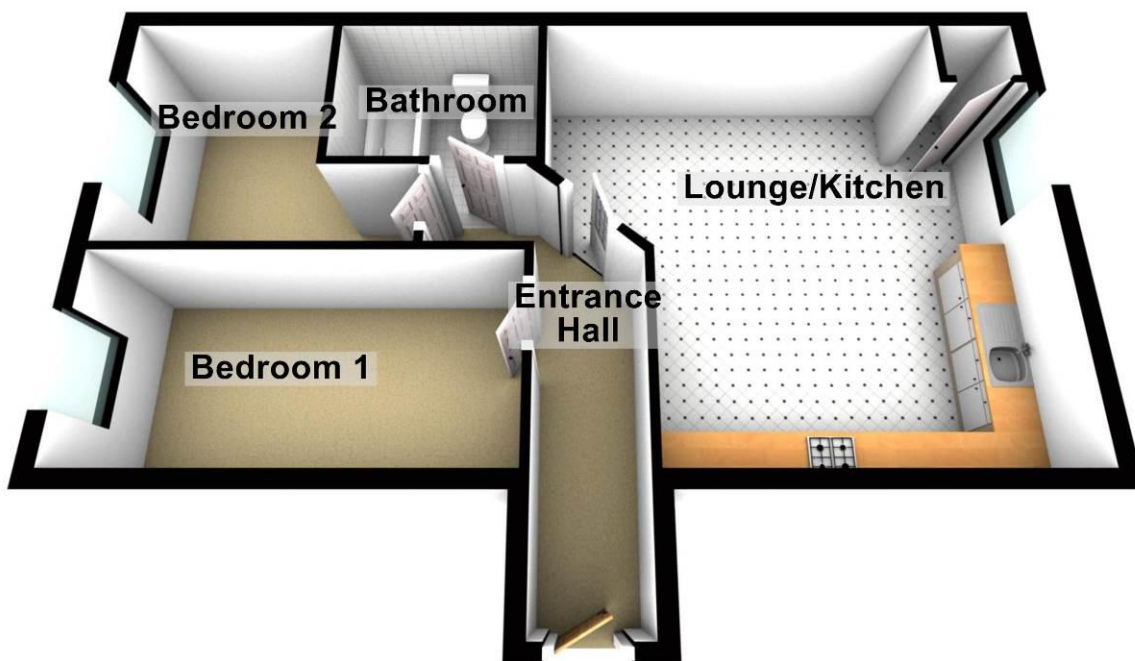

Valuation on your own property

Valuation on your own property: If you would like to know how much your property might achieve in today's market, we are pleased to offer a free market appraisal with no obligation. We are now available 7 days till 9pm - just call 01738 444342 to arrange an appointment.

www.nexthomeonline.co.uk

Next Home Estate Agents

63 – 65 George Street, Perth – 01738 44 43 42
 41 – 43 Allan Street, Blairgowrie – 01796 54 80 14
 21 Atholl Road, Pitlochry – 01796 54 80 14
 1a James Square, Crieff – 01764 65 00 44
 211 High Street, Auchterarder – 01764 66 36 66
 Email: sales@nexthomeonline.co.uk

Please Note:

These particulars whilst believed to be accurate are set out as a general outline only for guidance and do not constitute any part of an offer or contract intending, purchasers should not rely on them as statements or representations of fact, but must satisfy themselves by inspection or otherwise as to their accuracy. No person in this firm's employment has the authority to make or give representation or warranty in respect of the property. All room sizes are approximate and for general guidance only. They cannot be relied upon for fitting carpets, furniture etc.