

jordan fishwick

Estate Agents, Lettings and Management



32, Bain Street, Swinton, M27 5AE

Price £110,000

A charming end-terrace home in the popular Swinton area. Centrally located, this property is ideal for all the amenities and transport links that this district has to offer. Accommodation comprises of a good-sized living room, separate dining room, fitted kitchen with appliances and a bathroom to the ground floor. The first floor offers two double bedrooms. Externally you will find a low-maintenance rear yard with gated communal alleyway. Council tax band A.. On-street parking available. GFCH. Freehold.

Living Room

Laminate flooring, UPVC double glazed window to front elevation, radiator, television and telephone connection points. Door to dining room.

Dining Room

Laminate flooring, double glazed to rear elevation. Radiator. Door to kitchen.

Kitchen

Fully fitted kitchen with range of matching base and eye level units and roll top work surfaces over Stainless Steel sink with drainer and mixer tap over. Double glazed window into yard. Space for fridge/freezer, radiator. Oven and grill with four ring gas hob. Door to bathroom.

Bathroom

Panel bath with mixer shower over, pedestal basin and low level wc. Chrome heated towel rail.

Landing

Fitted carpet, door to both bedrooms.

Master Bedroom

Fitted carpet, double glazed window to front elevation.

Bedroom Two

Double glazed window. Radiator

Externally

Rear Yard. On Street Parking.

Disclaimer

IMPORTANT NOTE TO PURCHASERS: We endeavour to make our sales particulars accurate and reliable, however, they do not constitute or form part of an offer or any contract and none is to be relied upon as statements of representation or fact. The services, systems and appliances listed in this specification have not been tested by us and no guarantee as to their operating ability or efficiency is given. All measurements have been taken as guide to prospective buyers only, and are not precise. If floor plans were included, these may not be to scale and accuracy is not guaranteed. If you require clarification or further information on any

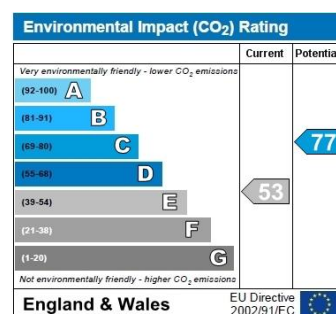
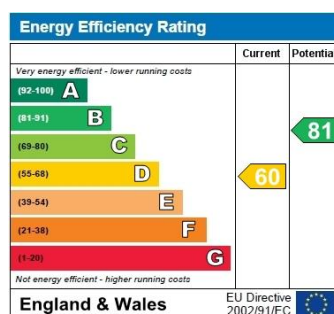
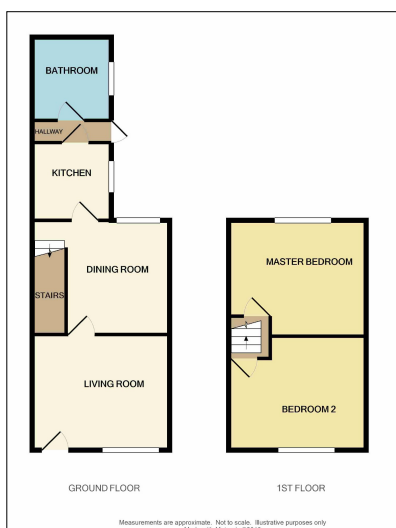

Manchester Office - 68 The Arches, Whitworth Street West, Manchester, M1 5WQ

Salford Office - City Point, Unit 2, 156 Chapel Street, Salford, M3 6BF

Northern Quarter Office - 45 Tib Street, Manchester, M4 1LT

Sales: (0161) 833 9499 option 3 **Lettings:** (0161) 833 9499 option 2 **Fax:** (0161) 833 9498

Email: manchester@jordanfishwick.co.uk **Email:** northernquarter@jordanfishwick.co.uk **Web:** www.jordanfishwick.co.uk

DIDSBURY Tel: 0161 445 4480

HALE Tel: 0161 929 9797

CHORLTON Tel: 0161 860 4444

WILMSLOW Tel: 01625 532 000

SALE Tel: 0161 962 2828

MACCLESFIELD Tel: 01625 434 000

GLOSSOP Tel: 01457 858 888



These Particulars are believed to be accurate but they are not guaranteed and do not form a contract. Floor plans are for guidance only and cannot be taken as being to scale. Neither Jordan Fishwick nor the vendor or lessor accept any responsibility in respect of these particulars, which are not intended to be statements or representations of fact and any intending purchaser or lessee must satisfy himself by inspection or otherwise as to the correctness of each of the statements contained in these particulars