



# £229,950 Linden Grange | Bishopston | Bristol | BS7 8JB Kendall Harper



A spacious one bedroom apartment situated on the Bishopston/ Redland border which is offered with no onward chain.

The property sits in a popular location within a modern development just a short walk to the popular shops, bars and restaurants that line the Gloucester Road and is only a short distance to the City Centre. The property also offers a communal garden and allocated parking space at the front of the building.

Located on the ground floor the apartment offers a spacious living area which measures 5m x 3.9m and is open to the kitchen. The kitchen has been fitted with a range of wall and base units with an integrated electric oven/gas hob and dishwasher and space/plumbing for a washing machine and freestanding fridge/freezer.

The bedroom is situated to the rear of the property and has sliding doors leading directly onto the communal gardens. The bathroom suite comprises; a panelled bath with shower over, w.c. and wash hand basin.

Externally the property has an allocated parking space to the front, communal gardens and a secure bike store to the rear.





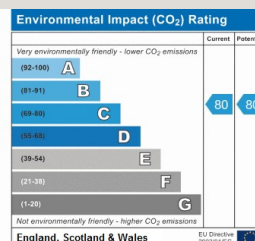
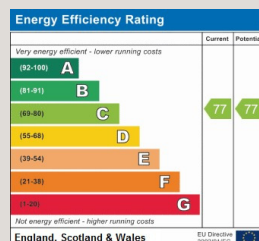
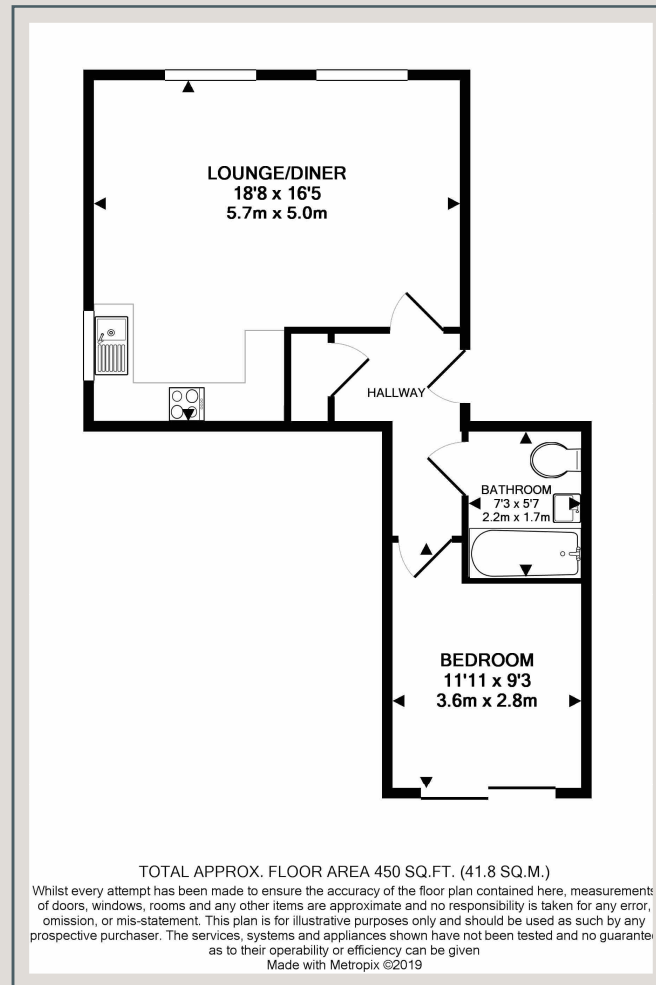

These particulars, whilst believed to be accurate, are set out as a general outline only for guidance and do not constitute any part of an offer or contract. Intending purchasers should not rely on them as statements of representation of fact, but must satisfy themselves by inspection or otherwise as to their accuracy. No person in this firm's employment has the authority to make or give any representation or warranty in respect of the property.

K054

