

Firmin  
& Co.



24 Mid Water Crescent, Hampton Vale PE7 8JT  
Offers in the region of £135,500





Floor Plan

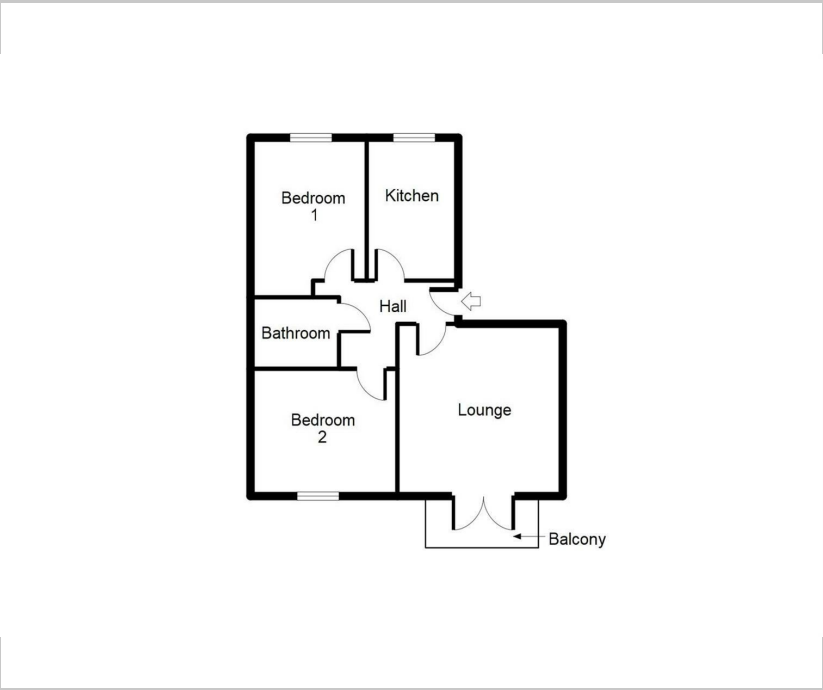

Accommodation

This nice modern apartment is an ideal first time buy, located in a prominent position in Hampton Vale close to local amenities. In brief the property comprises of an entrance hall and 13ft lounge with double doors leading out onto the balcony with views over the lake. The kitchen is fitted with a range of base and wall units with fitted oven, hob and extractor over, space for washing machine and space for fridge freezer. Completing the apartment are two double bedrooms and a bathroom comprising a three piece suite. The property also benefits from allocated parking behind electric gates and is offered with No Forward Chain.

Entrance Hallway

Lounge  
- 13'5" x 12'7" (4.10m x 3.84m)

Kitchen  
- 11'1" x 7'3" (3.39m x 2.21m)

Bedroom 1 - 9'11" x 11'9" (3.02m x 3.58m)

Bedroom 2  
- 9'0" x 12'2" (2.74m x 3.71m)

Bathroom



Area Map



Viewing

Please contact our Orton Office on 01733 852257 if you wish to arrange a viewing appointment for this property or require further information.

Energy Efficiency Graph

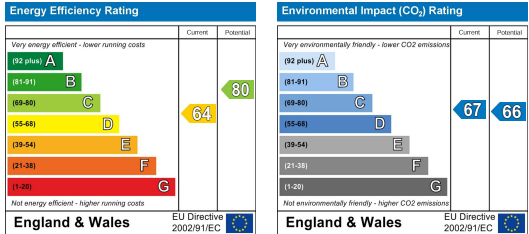

These particulars, whilst believed to be accurate are set out as a general outline only for guidance and do not constitute any part of an offer or contract. Intending purchasers should not rely on them as statements of representation of fact, but must satisfy themselves by inspection or otherwise as to their accuracy. No person in this firm's employment has the authority to make or give any representation or warranty in respect of the property.



48b Church Drive, Orton Waterville  
Peterborough, PE2 5HE  
T: 01733 852257  
E: orton@firminandco.co.uk