



55 DITTON LANE, CAMBRIDGE, CB5 8SR

£200,000



**A particularly spacious one bedroom first floor apartment located to the east of the city close to excellent local amenities. Ideally suited for a FIRST TIME BUYER or INVESTOR.**



A well presented and spacious first floor apartment located on the East side of the city close to excellent local amenities including shops and other recreational facilities. There is a good sized Living room along with a Double Bedroom making an ideal First Time or Investment purchase.

**Cambridge**  
104 Cherry Hinton Road  
Cambridge CB1 7AJ  
01223 214400

**Histon**  
19 High Street, Histon  
Cambridge CB24 9JD  
01223 235111

**Willingham**  
Stocks Corner, High Street  
Willingham, Cambs CB24 5ES  
01954 260952

**Newmarket**  
16a High Street  
Newmarket, Suffolk CB8 8LB  
01638 660303

hello@tylers.net | **TYLERS.NET**

### ENTRANCE HALL

Loft access. Airing cupboard. Night storage heater. Double glazed window to rear aspect. Doors to:-

### KITCHEN

Comprising of a stainless steel sink unit in front of double glazed window to rear aspect. Plumbing for washing machine. A range of large top and matching base units providing ample storage with roll top work surfaces over. Electric cooker point and extractor fan.

### LIVING ROOM

A good size room in which to relax and entertain in with a box bay double glazed window to front aspect. Electric panel heater.

### DOUBLE BEDROOM

Double glazed window to front aspect. Electric panel heater. Built in wardrobes.

### BATHROOM

Comprising of a close coupled W.C. Pedestal wash hand basin. Panelled bath with shower over. Electric heated towel rail. Wall mounted electric fan heater. Double glazed opaque window to rear aspect.

### OUTSIDE

There is a residence car parking area. Outside the apartment is a useful storage cupboard.

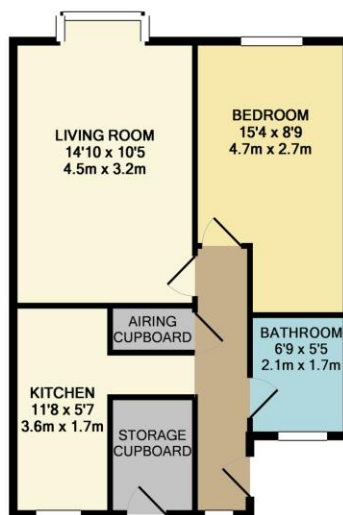
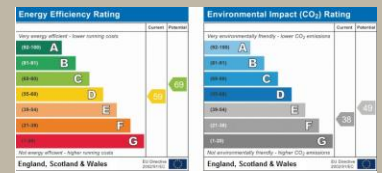

Whilst every attempt has been made to ensure the accuracy of the floor plan contained here, measurements of doors, windows, rooms and any other items are approximate and no responsibility is taken for any error, omission or mis-statement. This plan is for illustrative purposes only and should be used as such by any prospective purchaser. The services, systems and appliances shown have not been tested and no guarantee as to their operability or efficiency can be given.

As the sellers agent we are not surveyors or conveyancing experts and as such we cannot and do not comment on the condition of the property, or issues relating to title or other legal issues that may affect this property, unless we have been made aware of such matters. Interested parties should employ their own professionals to make such enquiries before making any transactional decisions.

Tylers for themselves and for the Vendors or Lessors of this property declare that these particulars are given as a general outline and whilst intended to be accurate do not constitute nor form any part of an offer or contract. Intending purchasers or tenants must satisfy themselves by personal inspection or otherwise as to the correctness of each statement. Fixtures, fittings and appliances have not been tested by Tylers. No person in the employment of Tylers has the authority to make or give any representation or warranty whatsoever in relation to this property. All measurements are approximate.



Tylers Independent Estate Agents is a trading name of Tylers Property Partnership Ltd  
Registered address; Salisbury House, Station Road, Cambridge, CB1 2LA Company Number 7535939 VAT Number 934 673 206

