





3



1



1

- Beautifully Presented
- Sought After Location
- Off Street Parking
- Double Glazing
- Close To Metros and Bus
- Three Bedrooms
- Front and Rear Gardens
- Lounge/Diner
- Gas Central Heating
- Close To Local Shops





We are delighted to offer for sale this semi detached home located on the sought after Glebe Road in Forest Hall. The property is close to local bus and Metro services and has many local shops on the doorstep. The property is in an excellent internal condition and briefly comprises:- spacious hallway, open plan lounge/diner, and a modern fitted kitchen. The first floor consists of three good sized bedrooms along with a stylish bathroom WC with handy storage cupboard. The property also boasts gas central heating and double glazing. Externally there is an impressive garden to the rear, perfect for those alfresco evenings and to the front there is a lawned garden and off street parking. We anticipate an extremely high level of viewings on this property. For more information and to arrange a viewing please contact our sales team on 0191 605 3134.



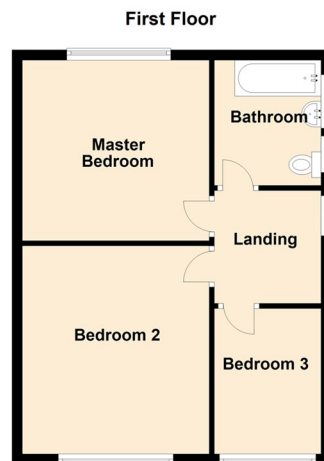
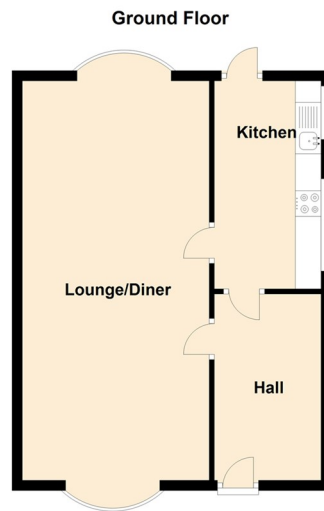

The difference between house and home

You may download, store and use the material for your own personal use and research. You may not republish, retransmit, redistribute or otherwise make the material available to any party or make the same available on any website, online service or bulletin board of your own or of any other party or make the same available in hard copy or in any other media without the website owner's express prior written consent. The website owner's copyright must remain on all reproductions of material taken from this website.

Lounge/Diner 25'6" x 11'11" (7.78 x 3.64)

Kitchen 8'6" x 6'9" (2.60 x 2.08)

Master Bedroom 11'6" x 11'11" (3.52 x 3.64)

Bedroom Two 13'3" x 11'11" (4.05 x 3.64)

Bedroom Three 9'3" x 6'9" (2.83 x 2.08)

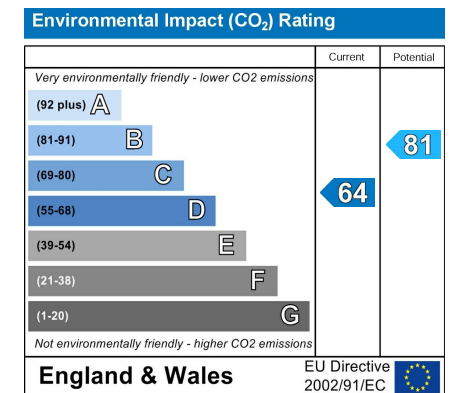
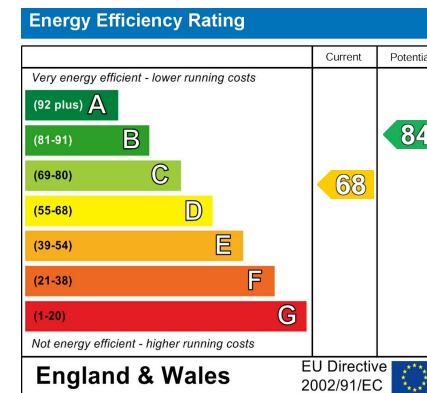

Gosforth	0191 236 2070
Newcastle	0191 284 4050
Forest Hall	0191 605 3134
High Heaton	0191 270 1122
Low Fell	0191 487 0800
Tynemouth	0191 257 2000
Whitley Bay	0191 251 3000
Property Management Centre	0191 236 2680



www.janforsterestates.com

